

| CURRENT OWNER | | TOPO | UTILITIES | STRT / ROAD | LOCATION | CURRENT ASSESSMENT | | | | 1302 EDGARTOWN, MA | | | | | | |
|--|--|--|---|-------------|-------------|----------------------|---|--------------------------------|--|--|-----------|-------|--|--|------------|------------|
| LONG MICHAEL T | | | 2 Public Water 3 Public Sewer | | | Description | Code | Appraised | Assessed | | | | | | | |
| 50 SARAH LN APT 318 SIMSBURY CT 06070 | | SUPPLEMENTAL DATA | | | | RESIDENTL RES LND | 1010 1010 | 2,607,900 1,175,700 | 2,607,900 1,175,700 | VISION | | | | | | |
| Alt Prcl ID PLN#/Rec 224/244 1953 DEED Lot# 2 PCLS CUMMINGS HILL Plan Notes Plan Notes Plan Notes GIS ID M_282199_793211 | | Restriction Hist District X Other Note UC-Misc 1 UC-Misc 2 Assoc Pid# | | Total | | 3,783,600 | 3,783,600 | | | | | | | | | |
| RECORD OF OWNERSHIP | | BK-VOL/PAGE | SALE DATE | Q/U | V/I | SALE PRICE | VC | PREVIOUS ASSESSMENTS (HISTORY) | | | | | | | | |
| LONG MICHAEL T | | 1544 861 | 09-28-2020 | U | I | 1 | 1A | Year | Code | Assessed | Year | Code | Assessed | Year | Code | Assessed |
| LONG MICHAEL T & ANN M CUMMINGS WAY LLC | | 0853 0407 | 10-19-2001 | Q | I | 535,000 | 00 | 2023 | 1010 | 2,520,400 | 2022 | 1010 | 1,616,000 | 2021 | 1010 | 1,791,000 |
| PRIORE ROBERT TRS | | 0848 0545 | 09-07-2001 | U | I | 535,000 | 1 | | 1010 | 1,131,100 | | 1010 | 1,085,400 | | 1010 | 976,300 |
| JACKSON KATHLEEN L | | 0792 0757 | 03-23-2000 | Q | I | 350,000 | 00 | Total | | 3,651,500 | Total | | 2,701,400 | Total | | 2,767,300 |
| | | 0765 0865 | 05-12-1999 | U | I | 1 | 1A | Total | | 3,651,500 | Total | | 2,701,400 | Total | | 2,767,300 |
| EXEMPTIONS | | | OTHER ASSESSMENTS | | | | This signature acknowledges a visit by a Data Collector or Assessor | | | | | | | | | |
| Year | Code | Description | Amount | Code | Description | Number | Amount | Comm Int | | | | | | | | |
| Total | | 0.00 | | | | | | | | | | | | | | |
| ASSESSING NEIGHBORHOOD | | | | | | | | | | | | | | | | |
| Nbhd | Nbhd Name | B | | Tracing | | | | Batch | | | | | | | | |
| 0080 | | | | | | | | | | | | | | | | |
| NOTES | | | | | | | | | | | | | | | | |
| EST AYB SHED LIMITED VIEWS 2ND&3RD FL BRICK FACED FND, BRICK PTO | | | | | | | | | | | | | | | | |
| BUILDING PERMIT RECORD | | | | | | | | VISIT / CHANGE HISTORY | | | | | | | | |
| Permit Id | Issue Date | Type | Description | Amount | Insp Date | % Comp | Date Comp | Comments | Date | Id | Type | Is | Cd | Purpost/Result | | |
| 64-2007 2007:64 2002:178 | 06-01-2007 10-05-2006 01-14-2002 | CO RA NC | CO ISSUED Res Add/Alter New Construct | | 01-28-2003 | 100 | 01-01-2003 | SFR FINISH ATTIC & BASEMENT | 06-01-2022 05-15-2017 03-23-2015 11-15-2011 03-28-2007 01-24-2007 03-31-2003 | LS MM JR MM EP WP WP | | | 11 11 01 11 11 50 05 | Field Review Field Review Cyclical Reinspection Field Review Field Review UC Status Inspection Measur/Review/New Const | | |
| LAND LINE VALUATION SECTION | | | | | | | | | | | | | | | | |
| B | Use Code | Description | Zone | Land Type | Land Units | Unit Price | Size Adj | Site Index | Cond. | Nbhd. | Nbhd. Adj | Notes | | Location Adjustment | Adj Unit P | Land Value |
| 1 | 1010 | SINGL FAM M-0 | R5 | | 4,140 SF | 57.96 | 1.00000 | 8 | 1.00 | 0090 | 4.900 | | | | 283.99 | 1,175,700 |
| Total Card Land Units | | | | | 0.10 | AC | Parcel Total Land Area | | | | | 0.10 | Total Land Value | | | 1,175,700 |

| CONSTRUCTION DETAIL | | | CONSTRUCTION DETAIL (CONTINUED) | | |
|--------------------------------|------|----------------|---------------------------------|-----|-------------|
| Element | Cd | Description | Element | Cd | Description |
| Style: | 06 | Custom | | | |
| Model | 01 | Residential | | | |
| Grade: | 09 | Custom | | | |
| Stories: | 2.5 | | | | |
| Occupancy | 1 | | | | |
| Exterior Wall 1 | 14 | Wood Shingle | | | |
| Exterior Wall 2 | 11 | Clapboard | | | |
| Roof Structure: | 03 | Gable/Hip | | | |
| Roof Cover | 10 | Wood Shingle | | | |
| Interior Wall 1 | 05 | Drywall/Sheet | | | |
| Interior Wall 2 | 06 | Cust Wd Panel | | | |
| Interior Flr 1 | 12 | Hardwood | | | |
| Interior Flr 2 | | | | | |
| Heat Fuel | 03 | Gas | | | |
| Heat Type: | 04 | Forced Air-Duc | | | |
| AC Type: | 03 | Central | | | |
| Total Bedrooms | 05 | 5 Bedrooms | | | |
| Total Bthrms: | 5 | | | | |
| Total Half Baths | 0 | | | | |
| Total Xtra Fixtrs | | | | | |
| Total Rooms: | | | | | |
| Bath Style: | 02 | Average | | | |
| Kitchen Style: | 02 | Modern | | | |
| CONDO DATA | | | | | |
| Parcel Id | | C | Owne | 0.0 | |
| | | | B | S | |
| Adjust Type | Code | Description | Factor% | | |
| Condo Flr | | | | | |
| Condo Unit | | | | | |
| COST / MARKET VALUATION | | | | | |
| Building Value New | | | 2,890,288 | | |
| Year Built | | | 2002 | | |
| Effective Year Built | | | 2012 | | |
| Depreciation Code | | | A | | |
| Remodel Rating | | | | | |
| Year Remodeled | | | | | |
| Depreciation % | | | 10 | | |
| Functional Obsol | | | 0 | | |
| External Obsol | | | 0 | | |
| Trend Factor | | | 1 | | |
| Condition | | | | | |
| Condition % | | | | | |
| Percent Good | | | 90 | | |
| Cns Sect Rcnd | | | 2,601,300 | | |
| Dep % Ovr | | | | | |
| Dep Ovr Comment | | | | | |
| Misc Imp Ovr | | | | | |
| Misc Imp Ovr Comment | | | | | |
| Cost to Cure Ovr | | | | | |
| Cost to Cure Ovr Comment | | | | | |

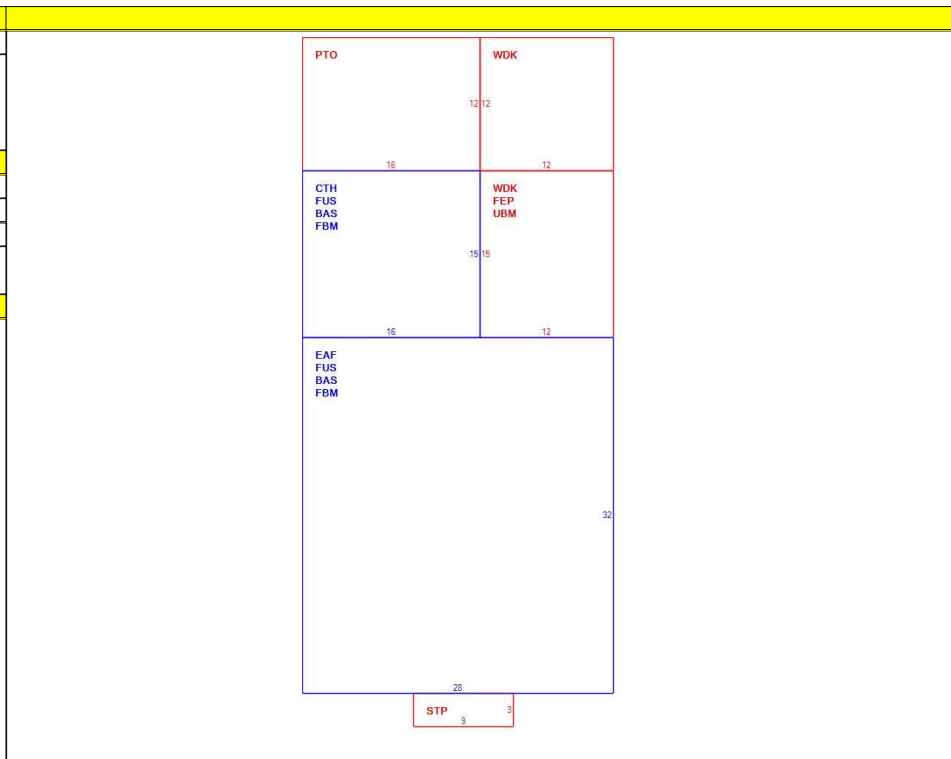

| OB - OUTBUILDING & YARD ITEMS(L) / XF - BUILDING EXTRA FEATURES(B) | | | | | | | | | | |
|--|-------------|-----|-------|------------|--------|----------|------|-------|------------|-------------|
| Code | Description | L/B | Units | Unit Price | Yr Blt | Cond. Cd | % Gd | Grade | Grade Adj. | Appr. Value |
| SHD8 | SHED W/LIGH | L | 70 | 36.00 | 2006 | | 90 | | 0.00 | 2,300 |
| FPL3 | FPL MSNRY 2 | B | 1 | 4000.00 | 2006 | | 90 | | 0.00 | 3,600 |
| ODS | OUTDOOR S | L | 1 | 700.00 | 2006 | | 100 | | 0.00 | 700 |

| BUILDING SUB-AREA SUMMARY SECTION | | | | | | |
|-----------------------------------|----------------------------|-------------|------------|----------|-----------|----------------|
| Code | Description | Living Area | Floor Area | Eff Area | Unit Cost | Undeprec Value |
| BAS | First Floor | 1,136 | 1,136 | 1,136 | 857.83 | 974,496 |
| CTH | Cath Cing | 0 | 240 | 12 | 42.89 | 10,294 |
| EAF | Attic, Expansion, Finished | 314 | 896 | 314 | 300.62 | 269,359 |
| FBM | Basement, Finished | 0 | 1,136 | 511 | 385.87 | 438,352 |
| FEP | Porch, Enclosed, Finished | 0 | 180 | 126 | 600.48 | 108,087 |
| FUS | Upper Story, Finished | 1,136 | 1,136 | 1,136 | 857.83 | 974,496 |
| PTO | Patio | 0 | 192 | 19 | 84.89 | 16,299 |
| STP | Stoop | 0 | 27 | 3 | 95.31 | 2,573 |
| UBM | Basement, Unfinished | 0 | 180 | 36 | 171.57 | 30,882 |
| WDK | Deck Wood | 0 | 324 | 32 | 84.72 | 27,451 |
| Ttl Gross Liv / Lease Area | | 2,586 | 5,447 | 3,325 | | 2,852,289 |

