

| CURRENT OWNER   |            | TOPO                   | UTILITIES   | STRT / ROAD              | LOCATION    | CURRENT ASSESSMENT |   |                                |           | 1302<br>EDGARTOWN, MA  |            |               |                     |            |            |                       |
|---|------------|------------------------|---|--------------------------|-------------|--------------------|---|--------------------------------|-----------|------------------------|------------|---------------|---------------------|------------|------------|-----------------------|
| NICHOLAS SALLY A TRS<br>FAMILY TRUST<br>139 CHAPPAQUIDDICK RD<br>EDGARTOWN MA 02539                             |            |                        |   | 9 Town Street<br>1 Paved |             | Description        | Code  | Appraised                      | Assessed  |                        |            | <b>VISION</b> |                     |            |            |                       |
|   |            |                        |   |                          |             | RESIDENTL          | 1010  | 2,604,000                      | 2,604,000 |                        |            |               |                     |            |            |                       |
|   |            |                        |   |                          |             | RES LND            | 1010  | 4,749,400                      | 4,749,400 |                        |            |               |                     |            |            |                       |
| SUPPLEMENTAL DATA   |            |                        |   |                          |             |                    |   |                                |           |                        |            |               |                     |            |            |                       |
| Alt Prcl ID<br>PLN#/Rec LC 15300C<br>Lot# A<br>Plan Notes<br>Plan Notes<br>Plan Notes<br>GIS ID M_284797_793124 |            |                        | Restriction<br>Hist Distrct<br>Other Note<br>UC-Misc 1<br>UC-Misc 2<br>Assoc Pid# |                          |             |                    |   |                                |           |                        |            |               |                     |            |            |                       |
|   |            |                        |   |                          |             | Total              |   | 7,353,400                      | 7,353,400 |                        |            |               |                     |            |            |                       |
| RECORD OF OWNERSHIP   |            | BK-VOL/PAGE            | SALE DATE   | Q/U                      | V/I         | SALE PRICE         | VC  | PREVIOUS ASSESSMENTS (HISTORY) |           |                        |            |               |                     |            |            |                       |
| NICHOLAS SALLY A TRS  |            | 0070 0263              | 01-26-2011  | U                        | I           |                    | 1 1A  | Year                           | Code      | Assessed               | Year       | Code          | Assessed            | Year       | Code       | Assessed              |
| NICHOLAS ROBERT B & SALLY A--TRS  |            | 1111 0934              | 02-26-2007  | U                        | I           |                    | 1 1A  | 2023                           | 1010      | 2,519,600              | 2022       | 1010          | 1,646,000           | 2021       | 1010       | 1,814,700             |
| NICHOLAS FAMILY LLC   |            | 0065 0108              | 06-08-2006  | U                        | I           |                    | 1 1A  |                                | 1010      | 4,274,500              |            | 1010          | 4,881,427           |            | 1010       | 4,881,427             |
| NICHOLAS JOHN B PAUL M &<br>NICHOLAS SALLY A TRS  |            | 0065 0106<br>0051 0145 | 06-08-2006<br>11-05-1996  | U<br>U                   | I<br>I      |                    | 1 1A<br>1 1A  |                                |           |                        |            |               |                     |            |            |                       |
|   |            |                        |   |                          |             | Total              |   | 6,794,100                      | Total     |                        | 6,527,427  | Total         |                     | 6,696,127  |            |                       |
| EXEMPTIONS  |            |                        | OTHER ASSESSMENTS   |                          |             |                    | This signature acknowledges a visit by a Data Collector or Assessor |                                |           |                        |            |               |                     |            |            |                       |
| Year  | Code       | Description            | Amount  | Code                     | Description | Number             | Amount  | Comm Int                       |           |                        |            |               |                     |            |            |                       |
|   |            |                        |   |                          |             |                    |   |                                |           |                        |            |               |                     |            |            |                       |
| Total   |            |                        | 0.00  |                          |             |                    |   |                                |           |                        |            |               |                     |            |            |                       |
| ASSESSING NEIGHBORHOOD  |            |                        |   |                          |             |                    |   |                                |           |                        |            |               |                     |            |            |                       |
| Nbhd  |            | Nbhd Name              |   | B                        |             | Tracing            |   | Batch                          |           |                        |            |               |                     |            |            |                       |
| CPY7  |            |                        |   |                          |             |                    |   |                                |           |                        |            |               |                     |            |            |                       |
| NOTES   |            |                        |   |                          |             |                    |   |                                |           |                        |            |               |                     |            |            |                       |
|   |            |                        |   |                          |             |                    |   |                                |           |                        |            |               |                     |            |            |                       |
| BUILDING PERMIT RECORD  |            |                        |   |                          |             |                    |   |                                |           | VISIT / CHANGE HISTORY |            |               |                     |            |            |                       |
| Permit Id   | Issue Date | Type                   | Description   | Amount                   | Insp Date   | % Comp             | Date Comp   | Comments                       |           |                        | Date       | Id            | Type                | Is         | Cd         | Purpost/Result        |
| 2022-105  | 09-21-2021 | RA                     | Res Add/Alter   | 60,000                   |             |                    |   | Replace roofing                |           |                        | 05-25-2022 | LS            |                     |            | 11         | Field Review          |
| 2018-292  | 12-05-2017 | RN                     | Res New Cons  | 30,000                   |             | 0                  |   | REPL SHED W/ GAR 14X24         |           |                        | 05-17-2022 | EH            |                     |            | 01         | Cyclical Reinspection |
| 2013-206  | 12-21-2012 | RA                     | Res Add/Alter   |                          |             |                    |   | ALT & ADD TO SFR               |           |                        | 04-29-2019 | EP            |                     |            | 01         | Cyclical Reinspection |
|   |            |                        |   |                          |             |                    |   |                                |           |                        | 05-25-2017 | DM            |                     |            | 11         | Field Review          |
|   |            |                        |   |                          |             |                    |   |                                |           |                        | 11-28-2011 | DM            |                     |            | 11         | Field Review          |
|   |            |                        |   |                          |             |                    |   |                                |           |                        | 10-03-2011 | EP            |                     |            | 01         | Cyclical Reinspection |
|   |            |                        |   |                          |             |                    |   |                                |           |                        | 03-31-2004 | JB            |                     |            | 01         | Cyclical Reinspection |
| LAND LINE VALUATION SECTION   |            |                        |   |                          |             |                    |   |                                |           |                        |            |               |                     |            |            |                       |
| B   | Use Code   | Description            | Zone  | Land Type                | Land Units  | Unit Price         | Size Adj  | Site Index                     | Cond.     | Nbhd.                  | Nbhd. Adj  | Notes         | Location Adjustment | Adj Unit P | Land Value |                       |
| 1   | 1010       | SINGL FAM M-0          | R12   |                          | 130,680     | SF 2.04            | 1.00000   | 7                              | 1.00      | CPY7                   | 2.000      | WF            | W60                 | 24.48      | 3,199,000  |                       |
| 1   | 1010       | SINGL FAM M-0          | R12   |                          | 200         | FF 0.00            | 1.00000   | 0                              | 0.75      | CPY7                   | 2.000      |               |                     | 0          | 0          |                       |
| 1   | 1010       | SINGL FAM M-0          | R12   |                          | 3.800       | AC 34,000.00       | 1.00000   | 0                              | 1.00      | CPY7                   | 2.000      |               | W60                 | 408,000    | 1,550,400  |                       |
| Total Card Land Units   |            |                        |   |                          | 6.80        | AC                 | Parcel Total Land Area  |                                |           |                        |            | 6.80          | Total Land Value    |            |            | 4,749,400             |

| CONSTRUCTION DETAIL            |      |                | CONSTRUCTION DETAIL (CONTINUED) |     |             |
|--------------------------------|------|----------------|---------------------------------|-----|-------------|
| Element                        | Cd   | Description    | Element                         | Cd  | Description |
| Style:                         | 06   | Custom         |                                 |     |             |
| Model                          | 01   | Residential    |                                 |     |             |
| Grade:                         | 07   | Good +10       |                                 |     |             |
| Stories:                       | 2    |                |                                 |     |             |
| Occupancy                      | 1    |                |                                 |     |             |
| Exterior Wall 1                | 14   | Wood Shingle   |                                 |     |             |
| Exterior Wall 2                |      |                |                                 |     |             |
| Roof Structure:                | 03   | Gable/Hip      |                                 |     |             |
| Roof Cover                     | 03   | Asph/F Gls/Cmp |                                 |     |             |
| Interior Wall 1                | 05   | Drywall/Sheet  |                                 |     |             |
| Interior Wall 2                | 06   | Cust Wd Panel  |                                 |     |             |
| Interior Flr 1                 | 12   | Hardwood       |                                 |     |             |
| Interior Flr 2                 | 05   | Vinyl/Asph/Lam |                                 |     |             |
| Heat Fuel                      | 03   | Gas            |                                 |     |             |
| Heat Type:                     | 04   | Forced Air-Duc |                                 |     |             |
| AC Type:                       | 03   | Central        |                                 |     |             |
| Total Bedrooms                 | 05   | 5 Bedrooms     |                                 |     |             |
| Total Bthrms:                  | 3    |                |                                 |     |             |
| Total Half Baths               | 0    |                |                                 |     |             |
| Total Xtra Fixtrs              |      |                |                                 |     |             |
| Total Rooms:                   | 9    |                |                                 |     |             |
| Bath Style:                    | 02   | Average        |                                 |     |             |
| Kitchen Style:                 | 02   | Modern         |                                 |     |             |
| <b>CONDO DATA</b>              |      |                |                                 |     |             |
| Parcel Id                      |      | C              | Ownr                            | 0.0 |             |
| Adjust Type                    | Code | Description    | Factor%                         |     |             |
| Condo Flr                      |      |                |                                 |     |             |
| Condo Unit                     |      |                |                                 |     |             |
| <b>COST / MARKET VALUATION</b> |      |                |                                 |     |             |
| Building Value New             |      |                | 3,314,830                       |     |             |
| Year Built                     |      |                | 1938                            |     |             |
| Effective Year Built           |      |                | 1997                            |     |             |
| Depreciation Code              |      |                | G                               |     |             |
| Remodel Rating                 |      |                |                                 |     |             |
| Year Remodeled                 |      |                |                                 |     |             |
| Depreciation %                 |      |                | 25                              |     |             |
| Functional Obsol               |      |                | 0                               |     |             |
| External Obsol                 |      |                | 0                               |     |             |
| Trend Factor                   |      |                | 1                               |     |             |
| Condition                      |      |                |                                 |     |             |
| Condition %                    |      |                |                                 |     |             |
| Percent Good                   |      |                | 75                              |     |             |
| Cns Sect Rcnd                  |      |                | 2,486,100                       |     |             |
| Dep % Ovr                      |      |                |                                 |     |             |
| Dep Ovr Comment                |      |                |                                 |     |             |
| Misc Imp Ovr                   |      |                |                                 |     |             |
| Misc Imp Ovr Comment           |      |                |                                 |     |             |
| Cost to Cure Ovr               |      |                |                                 |     |             |
| Cost to Cure Ovr Comment       |      |                |                                 |     |             |

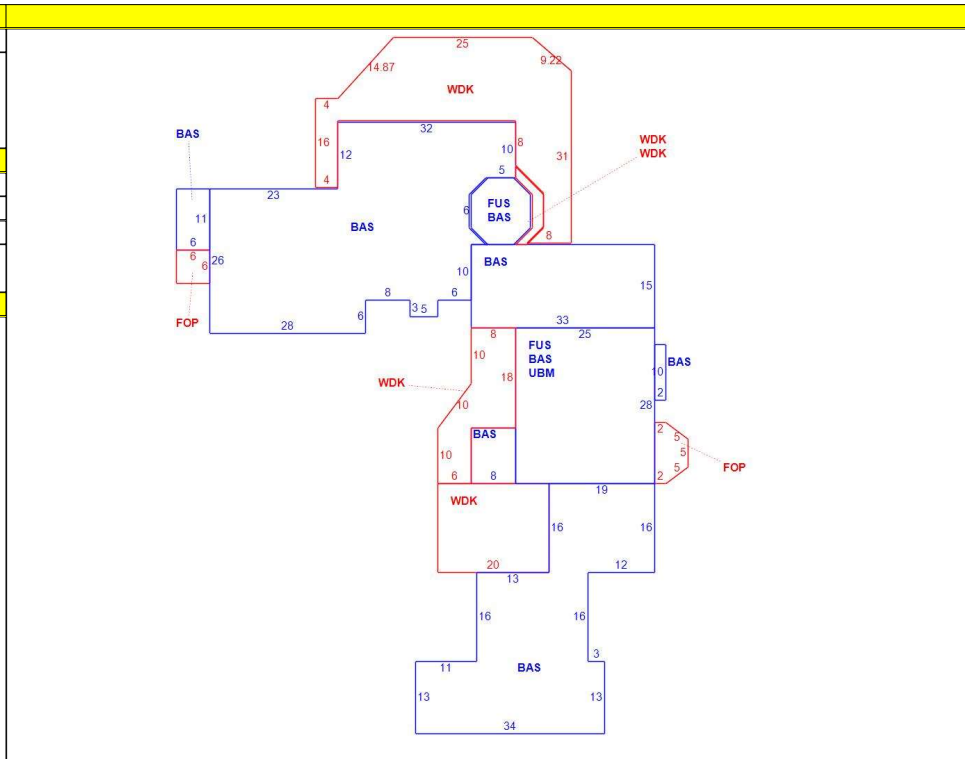

| OB - OUTBUILDING & YARD ITEMS(L) / XF - BUILDING EXTRA FEATURES(B) |             |     |       |            |        |          |      |       |            |             |
|--|-------------|-----|-------|------------|--------|----------|------|-------|------------|-------------|
| Code   | Description | L/B | Units | Unit Price | Yr Blt | Cond. Cd | % Gd | Grade | Grade Adj. | Appr. Value |
| FPL1   | FPL MSNRY 1 | B   | 2     | 3000.00    | 1991   |          | 75   |       | 0.00       | 4,500       |
| DCK1   | DOCKS-RES   | L   | 965   | 95.00      | 1980   |          | 75   |       | 0.00       | 68,800      |
| TEN  | TENNIS COU  | L   | 7,500 | 5.00       | 2003   |          | 75   |       | 0.00       | 28,100      |
| FPL3   | FPL MSNRY 2 | B   | 1     | 4000.00    | 1991   |          | 75   |       | 0.00       | 3,000       |
| ODS  | OUTDOOR S   | L   | 1     | 700.00     |        |          | 100  |       | 0.00       | 700         |
| PAT2   | PATIO-GOOD  | L   | 144   | 7.00       |        |          | 100  |       | 0.00       | 1,000       |
| FGR2   | GAR 1ST-GO  | L   | 336   | 35.00      | 2018   |          | 100  |       | 0.00       | 11,800      |

| BUILDING SUB-AREA SUMMARY SECTION |                       |             |            |          |           |                |
|-----------------------------------|-----------------------|-------------|------------|----------|-----------|----------------|
| Code                              | Description           | Living Area | Floor Area | Eff Area | Unit Cost | Undeprec Value |
| BAS                               | First Floor           | 4,041       | 4,041      | 4,041    | 640.40    | 2,587,848      |
| FOP                               | Porch, Open, Finished | 0           | 90         | 18       | 128.08    | 11,527         |
| FUS                               | Upper Story, Finished | 814         | 814        | 814      | 640.40    | 521,284        |
| UBM                               | Basement, Unfinished  | 0           | 700        | 140      | 128.08    | 89,656         |
| WDK                               | Deck, Wood            | 0           | 1,385      | 139      | 64.27     | 89,015         |
| Ttl Gross Liv / Lease Area        |                       | 4,855       | 7,030      | 5,152    |           | 3,299,330      |

