

| CURRENT OWNER   |            | TOPO              | UTILITIES         | STRT / ROAD            | LOCATION    | CURRENT ASSESSMENT |   |                                |            | 1302<br>EDGARTOWN, MA |                  |                               |                     |                       |            |
|---|------------|-------------------|-------------------|------------------------|-------------|--------------------|---|--------------------------------|------------|-----------------------|------------------|-------------------------------|---------------------|-----------------------|------------|
| BRINE WILLIAM H III   |            |                   |                   | 9 Town Street          |             | Description        | Code  | Appraised                      | Assessed   |                       |                  | VISION                        |                     |                       |            |
| 12 LITCHFIELD RD  |            |                   |                   | 3 Unpaved              |             | RESIDENTL          | 1090  | 3,363,400                      | 3,363,400  |                       |                  |                               |                     |                       |            |
| EDGARTOWN MA 02539  |            | SUPPLEMENTAL DATA |                   |                        |             | RES LND            | 1090  | 2,132,700                      | 2,132,700  |                       |                  |                               |                     |                       |            |
|   |            | Alt Prcl ID       | Restriction       |                        |             |                    |   |                                |            |                       |                  |                               |                     |                       |            |
|   |            | PLN#/Rec          | Hist Distrct      |                        |             |                    |   |                                |            |                       |                  |                               |                     |                       |            |
|   |            | Lot#              | Other Note        |                        |             |                    |   |                                |            |                       |                  |                               |                     |                       |            |
|   |            | Plan Notes        | UC-Misc 1         |                        |             |                    |   |                                |            |                       |                  |                               |                     |                       |            |
|   |            | Plan Notes        | UC-Misc 2         |                        |             |                    |   |                                |            |                       |                  |                               |                     |                       |            |
|   |            | Plan Notes        |                   |                        |             |                    |   |                                |            |                       |                  |                               |                     |                       |            |
|   |            | GIS ID            | Assoc Pid#        |                        |             |                    |   |                                |            |                       |                  |                               |                     |                       |            |
|   |            |                   |                   | Total                  |             |                    |   | 5,496,100                      | 5,496,100  |                       |                  |                               |                     |                       |            |
| RECORD OF OWNERSHIP   |            | BK-VOL/PAGE       | SALE DATE         | Q/U                    | V/I         | SALE PRICE         | VC  | PREVIOUS ASSESSMENTS (HISTORY) |            |                       |                  |                               |                     |                       |            |
| BRINE WILLIAM H III   |            | 1304 0682         | 01-04-2013        | U                      | I           | 500,000            | 1V  | Year                           | Code       | Assessed              | Year             | Code                          | Assessed            |                       |            |
| BRINE WILLIAM H III & MARTIN HEATHER B BRINE WM H III & COUGHLIN DANIEL M TRS |            | 1304 0087         | 12-31-2012        | U                      | I           | 1,000,000          | 1A  | 2023                           | 1090       | 3,252,900             | 2022             | 1090                          | 2,283,000           |                       |            |
| COUGHLIN DANIEL M TRS   |            | 1245 0479         | 05-13-2011        | U                      | I           | 1                  | 1A  |                                | 1090       | 2,026,100             | 2021             | 1090                          | 1,812,793           |                       |            |
| COUGHLIN JOAN TRS   |            | 0770 0072         | 07-01-1999        | U                      | I           | 1                  | 1A  |                                |            |                       |                  |                               |                     |                       |            |
|   |            | 0769 0135         | 06-22-1999        | U                      | I           | 1                  | 1A  |                                |            |                       |                  |                               |                     |                       |            |
|   |            |                   |                   | Total                  |             |                    |   | 5,279,000                      | Total      |                       |                  | 4,095,793                     | Total               | 3,669,253             |            |
| EXEMPTIONS  |            |                   | OTHER ASSESSMENTS |                        |             |                    | This signature acknowledges a visit by a Data Collector or Assessor |                                |            |                       |                  |                               |                     |                       |            |
| Year  | Code       | Description       | Amount            | Code                   | Description | Number             | Amount  | Comm Int                       |            |                       |                  |                               |                     |                       |            |
|   |            |                   |                   |                        |             |                    |   |                                |            |                       |                  |                               |                     |                       |            |
|   |            |                   |                   |                        |             |                    |   |                                |            |                       |                  |                               |                     |                       |            |
|   |            | Total             | 0.00              |                        |             |                    |   |                                |            |                       |                  |                               |                     |                       |            |
| ASSESSING NEIGHBORHOOD  |            |                   |                   | VISIT / CHANGE HISTORY |             |                    |   |                                |            |                       |                  |                               |                     |                       |            |
| Nbhd  | Nbhd Name  | B                 |                   | Tracing                |             | Batch              |   |                                |            |                       |                  |                               |                     |                       |            |
| CPY5  |            |                   |                   |                        |             |                    |   |                                |            |                       |                  |                               |                     |                       |            |
| NOTES   |            |                   |                   |                        |             |                    |   |                                |            |                       |                  | Appraised Bldg. Value (Card)  |                     | 3,358,500             |            |
| WD STOVE  |            |                   |                   |                        |             |                    |   |                                |            |                       |                  | Appraised Xf (B) Value (Bldg) |                     | 1,800                 |            |
| BLD1 SKTCH CORR FY14  |            |                   |                   |                        |             |                    |   |                                |            |                       |                  | Appraised Ob (B) Value (Bldg) |                     | 3,100                 |            |
|   |            |                   |                   |                        |             |                    |   |                                |            |                       |                  | Appraised Land Value (Bldg)   |                     | 2,132,700             |            |
|   |            |                   |                   |                        |             |                    |   |                                |            |                       |                  | Special Land Value            |                     | 0                     |            |
|   |            |                   |                   |                        |             |                    |   |                                |            |                       |                  | Total Appraised Parcel Value  |                     | 5,496,100             |            |
|   |            |                   |                   |                        |             |                    |   |                                |            |                       |                  | Valuation Method              |                     | C                     |            |
|   |            |                   |                   |                        |             |                    |   |                                |            |                       |                  | Total Appraised Parcel Value  |                     | 5,496,100             |            |
| BUILDING PERMIT RECORD  |            |                   |                   |                        |             |                    |   | VISIT / CHANGE HISTORY         |            |                       |                  |                               |                     |                       |            |
| Permit Id   | Issue Date | Type              | Description       | Amount                 | Insp Date   | % Comp             | Date Comp   | Comments                       | Date       | Id                    | Type             | Is                            | Cd                  | Purpost/Result        |            |
| 2021-746  | 04-13-2021 | RN                | Res New Cons      | 50,000                 |             |                    |   | FOUNDATION FOR MODULA          | 06-28-2022 | EH                    |                  |                               | 01                  | Cyclical Reinspection |            |
| 2021-742  | 04-13-2021 | RA                | Res Add/Alter     | 60,000                 |             |                    |   | ADD MASTER CLOSET & PA         | 05-26-2022 | LS                    |                  |                               | 11                  | Field Review          |            |
| 2014-298  | 02-07-2014 | RA                | Res Add/Alter     | 200,000                |             |                    |   | ADDIT/CHG HEAT                 | 11-21-2019 | EP                    |                  |                               | 01                  | Cyclical Reinspection |            |
| 2012-318  | 03-29-2012 | RA                | Res Add/Alter     |                        |             |                    |   | REPLACE SIDING                 | 05-24-2017 | DM                    |                  |                               | 11                  | Field Review          |            |
| 2010-251  | 05-20-2010 | RA                | Res Add/Alter     |                        |             |                    |   | SHINGLE ROOF & SIDEWAL         | 09-25-2015 | EP                    |                  |                               | 01                  | Cyclical Reinspection |            |
| 229   | 01-01-2003 | NC                | New Construct     |                        |             | 70                 | 01-01-2004  | NEW SFR                        | 03-03-2015 | EP                    |                  |                               | 50                  | UC Status Inspection  |            |
| 210   | 01-01-2003 | AD                | Addition          |                        |             | 70                 | 01-01-2004  | DET BDRM                       | 12-04-2013 | EP                    |                  |                               | 01                  | Cyclical Reinspection |            |
| LAND LINE VALUATION SECTION   |            |                   |                   |                        |             |                    |   |                                |            |                       |                  |                               |                     |                       |            |
| B   | Use Code   | Description       | Zone              | Land Type              | Land Units  | Unit Price         | Size Adj  | Site Index                     | Cond.      | Nbhd.                 | Nbhd. Adj        | Notes                         | Location Adjustment | Adj Unit P            | Land Value |
| 1   | 1090       | MULTI HSES        | R12               |                        | 130,680 SF  | 2.04               | 1.00000   | 6                              | 1.00       | CPY5                  | 2.000            | FRONT POND& HARBOR VIE        | W40                 | 16.32                 | 2,132,700  |
| Total Card Land Units   |            |                   |                   |                        | 3.00        | AC                 | Parcel Total Land Area  |                                |            | 3.00                  | Total Land Value |                               |                     | 2,132,700             |            |

| CONSTRUCTION DETAIL      |    |                | CONSTRUCTION DETAIL (CONTINUED) |           |             |
|--------------------------|----|----------------|---------------------------------|-----------|-------------|
| Element                  | Cd | Description    | Element                         | Cd        | Description |
| Style:                   | 07 | Standard Plus  |                                 |           |             |
| Model                    | 01 | Residential    |                                 |           |             |
| Grade:                   | 06 | Good           |                                 |           |             |
| Stories:                 | 1  | 1 Story        |                                 |           |             |
| Occupancy                | 1  |                |                                 |           |             |
| Exterior Wall 1          | 14 | Wood Shingle   |                                 |           |             |
| Exterior Wall 2          | 14 | Wood Shingle   |                                 |           |             |
| Roof Structure:          | 03 | Gable/Hip      |                                 |           |             |
| Roof Cover               | 10 | Wood Shingle   |                                 |           |             |
| Interior Wall 1          | 05 | Drywall/Sheet  |                                 |           |             |
| Interior Wall 2          | 02 | Wall Brd/Wood  |                                 |           |             |
| Interior Flr 1           | 09 | Pine/Soft Wood |                                 |           |             |
| Interior Flr 2           |    |                |                                 |           |             |
| Heat Fuel                | 04 | Electric       |                                 |           |             |
| Heat Type:               | 07 | Electr Basebrd |                                 |           |             |
| AC Type:                 | 02 | Heat Pump      |                                 |           |             |
| Total Bedrooms           | 04 | 4 Bedrooms     |                                 |           |             |
| Total Bthrms:            | 2  |                |                                 |           |             |
| Total Half Baths         | 1  |                |                                 |           |             |
| Total Xtra Fixtrs        | 1  |                |                                 |           |             |
| Total Rooms:             | 8  |                |                                 |           |             |
| Bath Style:              | 02 | Average        |                                 |           |             |
| Kitchen Style:           | 02 | Modern         |                                 |           |             |
|                          |    |                | <b>CONDO DATA</b>               |           |             |
| Parcel Id                |    |                | C                               | Owne 0.0  |             |
| Adjust Type              |    |                |                                 | B         | S           |
| Condo Flr                |    |                |                                 |           |             |
| Condo Unit               |    |                |                                 |           |             |
|                          |    |                | <b>COST / MARKET VALUATION</b>  |           |             |
| Building Value New       |    |                |                                 | 1,270,095 |             |
| Year Built               |    |                |                                 | 1976      |             |
| Effective Year Built     |    |                |                                 | 2012      |             |
| Depreciation Code        |    |                |                                 | VG        |             |
| Remodel Rating           |    |                |                                 |           |             |
| Year Remodeled           |    |                |                                 |           |             |
| Depreciation %           |    |                |                                 | 10        |             |
| Functional Obsol         |    |                |                                 | 0         |             |
| External Obsol           |    |                |                                 | 0         |             |
| Trend Factor             |    |                |                                 | 1         |             |
| Condition                |    |                |                                 |           |             |
| Condition %              |    |                |                                 |           |             |
| Percent Good             |    |                |                                 | 90        |             |
| Cns Sect Rcnd            |    |                |                                 | 1,143,100 |             |
| Dep % Ovr                |    |                |                                 |           |             |
| Dep Ovr Comment          |    |                |                                 |           |             |
| Misc Imp Ovr             |    |                |                                 |           |             |
| Misc Imp Ovr Comment     |    |                |                                 |           |             |
| Cost to Cure Ovr         |    |                |                                 |           |             |
| Cost to Cure Ovr Comment |    |                |                                 |           |             |

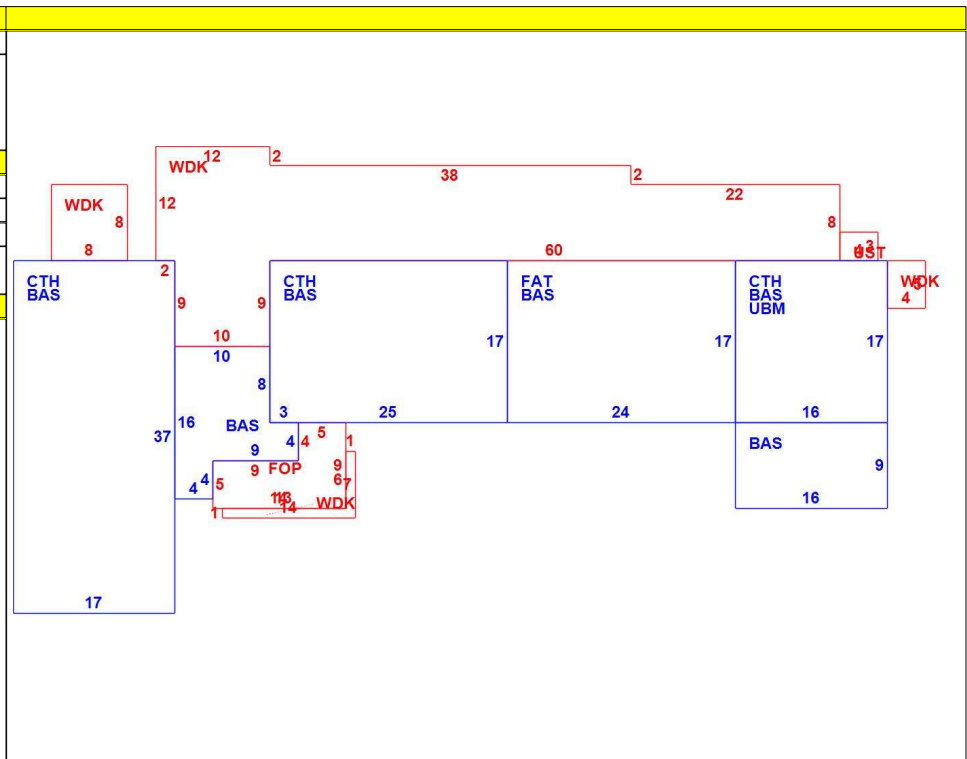

**OB - OUTBUILDING & YARD ITEMS(L) / XF - BUILDING EXTRA FEATURES(B)**

| Code | Description | L/B | Units | Unit Price | Yr Blt | Cond. Cd | % Gd | Grade | Grade Adj. | Appr. Value |
|------|-------------|-----|-------|------------|--------|----------|------|-------|------------|-------------|
| SHED | SHED FRAME  | L   | 1     | 1000.00    | 1980   |          | 100  |       | 0.00       | 1,000       |
| ODS  | OUTDOOR S   | L   | 2     | 700.00     |        |          | 100  |       | 0.00       | 1,400       |
| FPL5 | GAS VENTED  | B   | 1     | 2000.00    |        |          | 90   |       | 0.00       | 1,800       |

**BUILDING SUB-AREA SUMMARY SECTION**

| Code                       | Description                  | Living Area | Floor Area | Eff Area | Unit Cost | Undeprec Value |
|----------------------------|------------------------------|-------------|------------|----------|-----------|----------------|
| BAS                        | First Floor                  | 2,026       | 2,026      | 2,026    | 537.81    | 1,089,603      |
| CTH                        | Cath Cing                    | 0           | 1,326      | 66       | 26.77     | 35,495         |
| FAT                        | Attic, Finished              | 82          | 408        | 82       | 108.09    | 44,100         |
| FOP                        | Porch, Open, Finished        | 0           | 90         | 18       | 107.56    | 9,681          |
| UBM                        | Basement, Unfinished         | 0           | 272        | 54       | 106.77    | 29,042         |
| UST                        | Utility, Storage, Unfinished | 0           | 12         | 5        | 224.09    | 2,689          |
| WDK                        | Deck, Wood                   | 0           | 894        | 89       | 53.54     | 47,865         |
| Ttl Gross Liv / Lease Area |                              | 2,108       | 5,028      | 2,340    |           | 1,258,475      |

| CURRENT OWNER   |            | TOPO                     | UTILITIES         | STRT / ROAD   | LOCATION    | CURRENT ASSESSMENT  |                        |                        |                                | 1302<br>EDGARTOWN, MA          |           |                               |                     |                |            |           |
|---|------------|--------------------------|-------------------|---------------|-------------|---|------------------------|------------------------|--------------------------------|--------------------------------|-----------|-------------------------------|---------------------|----------------|------------|-----------|
| BRINE WILLIAM H III   |            |                          |                   | 9 Town Street |             | Description   | Code                   | Appraised              | Assessed                       |                                |           | VISION                        |                     |                |            |           |
| 12 LITCHFIELD RD  |            |                          |                   | 3 Unpaved     |             | RESIDENTL   | 1090                   | 3,363,400              | 3,363,400                      |                                |           |                               |                     |                |            |           |
| EDGARTOWN MA 02539  |            | <b>SUPPLEMENTAL DATA</b> |                   |               |             | RES LND   | 1090                   | 2,132,700              | 2,132,700                      |                                |           |                               |                     |                |            |           |
| Alt Prcl ID   |            | Restriction              |                   | Hist Distrct  |             | Other Note  |                        | UC-Misc 1              |                                |                                |           |                               |                     |                |            |           |
| PLN#/Rec CF 107 4/25/75   |            | UC-Misc 2                |                   | Assoc Pid#    |             | Total   |                        | 5,496,100              | 5,496,100                      |                                |           |                               |                     |                |            |           |
| Lot# 52   |            |                          |                   |               |             |   |                        |                        |                                |                                |           |                               |                     |                |            |           |
| Plan Notes PRIOR CF94   |            |                          |                   |               |             |   |                        |                        |                                |                                |           |                               |                     |                |            |           |
| Plan Notes  |            |                          |                   |               |             |   |                        |                        |                                |                                |           |                               |                     |                |            |           |
| Plan Notes  |            |                          |                   |               |             |   |                        |                        |                                |                                |           |                               |                     |                |            |           |
| GIS ID M_283951_792859  |            |                          |                   |               |             |   |                        |                        |                                |                                |           |                               |                     |                |            |           |
| RECORD OF OWNERSHIP   |            |                          | BK-VOL/PAGE       | SALE DATE     | Q/U         | V/I   | SALE PRICE             | VC                     | PREVIOUS ASSESSMENTS (HISTORY) |                                |           |                               |                     |                |            |           |
| BRINE WILLIAM H III   |            |                          | 1304 0682         | 01-04-2013    | U           | I   | 500,000                | 1V                     | Year                           | Code                           | Assessed  | Year                          | Code                | Assessed       |            |           |
| BRINE WILLIAM H III & MARTIN HEATHER B BRINE WM H III & COUGHLIN DANIEL M TRS |            |                          | 1304 0087         | 12-31-2012    | U           | I   | 1,000,000              | 1A                     | 2023                           | 1090                           | 3,252,900 | 2022                          | 1090                | 2,283,000      |            |           |
| COUGHLIN DANIEL M TRS   |            |                          | 1245 0479         | 05-13-2011    | U           | I   | 1                      | 1A                     |                                | 1090                           | 2,026,100 | 2021                          | 1090                | 2,283,000      |            |           |
| COUGHLIN JOAN TRS   |            |                          | 0770 0072         | 07-01-1999    | U           | I   | 1                      | 1A                     |                                |                                |           |                               | 1090                | 1,386,253      |            |           |
|   |            |                          | 0769 0135         | 06-22-1999    | U           | I   | 1                      | 1A                     | Total                          |                                | 5,279,000 | Total                         |                     | 4,095,793      | Total      | 3,669,253 |
| EXEMPTIONS  |            |                          | OTHER ASSESSMENTS |               |             | This signature acknowledges a visit by a Data Collector or Assessor |                        |                        |                                |                                |           |                               |                     |                |            |           |
| Year  | Code       | Description              | Amount            | Code          | Description | Number  | Amount                 | Comm Int               |                                |                                |           |                               |                     |                |            |           |
| Total   |            |                          | 0.00              |               |             |   |                        |                        |                                | <b>APPRAISED VALUE SUMMARY</b> |           |                               |                     |                |            |           |
| Nbhd  |            |                          | Nbhd Name         |               |             | B   |                        |                        | Tracing                        |                                |           | Batch                         |                     |                |            |           |
| CPY5  |            |                          |                   |               |             |   |                        |                        |                                |                                |           |                               |                     |                |            |           |
| NOTES   |            |                          |                   |               |             |   |                        |                        |                                |                                |           | Appraised Bldg. Value (Card)  |                     | 3,358,500      |            |           |
| VENTED GAS LOOK-A-LIKE WOODSOVE IN MAIN                                       |            |                          |                   |               |             |   |                        |                        |                                |                                |           | Appraised Xf (B) Value (Bldg) |                     | 1,800          |            |           |
| 1ST FLAREA  |            |                          |                   |               |             |   |                        |                        |                                |                                |           | Appraised Ob (B) Value (Bldg) |                     | 3,100          |            |           |
| POST & BEAM CONST.  |            |                          |                   |               |             |   |                        |                        |                                |                                |           | Appraised Land Value (Bldg)   |                     | 2,132,700      |            |           |
| AC/HEAT PUMP IN OFFICE AREA   |            |                          |                   |               |             |   |                        |                        |                                |                                |           | Special Land Value            |                     | 0              |            |           |
|   |            |                          |                   |               |             |   |                        |                        |                                |                                |           | Total Appraised Parcel Value  |                     | 5,496,100      |            |           |
|   |            |                          |                   |               |             |   |                        |                        |                                |                                |           | Valuation Method              |                     | C              |            |           |
|   |            |                          |                   |               |             |   |                        |                        |                                |                                |           | Total Appraised Parcel Value  |                     | 5,496,100      |            |           |
| BUILDING PERMIT RECORD  |            |                          |                   |               |             |   |                        | VISIT / CHANGE HISTORY |                                |                                |           |                               |                     |                |            |           |
| Permit Id   | Issue Date | Type                     | Description       | Amount        | Insp Date   | % Comp  | Date Comp              | Comments               | Date                           | Id                             | Type      | Is                            | Cd                  | Purpost/Result |            |           |
|   |            |                          |                   |               |             |   |                        |                        |                                |                                |           |                               |                     |                |            |           |
| LAND LINE VALUATION SECTION   |            |                          |                   |               |             |   |                        |                        |                                |                                |           |                               |                     |                |            |           |
| B   | Use Code   | Description              | Zone              | Land Type     | Land Units  | Unit Price  | Size Adj               | Site Index             | Cond.                          | Nbhd.                          | Nbhd. Adj | Notes                         | Location Adjustment | Adj Unit P     | Land Value |           |
| 2   | 1090       | MULTI HSES               |                   |               | 0 SF        | 33.58   | 1.00000                | 6                      | 1.00                           | CPY5                           | 2.000     |                               |                     | 67.16          | 0          |           |
| Total Card Land Units   |            |                          |                   |               | 0.00        | AC  | Parcel Total Land Area |                        |                                |                                |           | 3.00                          | Total Land Value    |                |            | 0         |

| CONSTRUCTION DETAIL  |                            |                |                                |            |             | CONSTRUCTION DETAIL (CONTINUED)   |      |       |            |             |
|--|----------------------------|----------------|--------------------------------|------------|-------------|---|------|-------|------------|-------------|
| Element  | Cd                         | Description    | Element                        | Cd         | Description |   |      |       |            |             |
| Style:   | 07                         | Standard Plus  |                                |            |             | <div style="text-align: right; margin-bottom: 10px;">                     LOWER LEVEL ENTRY TO UGR<br/>                     / /                 </div> <p>The floor plan shows a main rectangular area with a width of 40 and a depth of 27. A smaller section with a width of 9 and a depth of 8 is attached to the bottom-left side. A red-outlined area labeled 'WDK' is located at the bottom center, with a width of 3 and a depth of 6. Other dimensions include 7, 15, 22, 24, 5, 8, 14, 13, and 16. Area codes include CTH, BAS, UGR, EAF, BAS, UBM, BAS, UBM, and WDK.</p> |      |       |            |             |
| Model:   | 01                         | Residential    | <b>CONDO DATA</b>              |            |             |   |      |       |            |             |
| Grade:   | 05                         | Ave/Good       | Parcel Id                      | C          | Owne 0.0    |   |      |       |            |             |
| Stories:   | 1.5                        |                |                                |            |             |   |      |       |            |             |
| Occupancy  |                            |                |                                |            |             |   |      |       |            |             |
| Exterior Wall 1  | 08                         | Wood on Sheath |                                |            |             |   |      |       |            |             |
| Exterior Wall 2  | 14                         | Wood Shingle   |                                | B          | S           |   |      |       |            |             |
| Roof Structure:  | 03                         | Gable/Hip      | Adjust Type                    | Code       | Description |   |      |       |            |             |
| Roof Cover   | 10                         | Wood Shingle   | Condo Flr                      |            | Factor%     |   |      |       |            |             |
| Interior Wall 1  | 06                         | Cust Wd Panel  | Condo Unit                     |            |             |   |      |       |            |             |
| Interior Wall 2  |                            |                | <b>COST / MARKET VALUATION</b> |            |             |   |      |       |            |             |
| Interior Flr 1   | 09                         | Pine/Soft Wood | Building Value New             |            | 812,411     |   |      |       |            |             |
| Interior Flr 2   |                            |                | Year Built                     |            | 2002        |   |      |       |            |             |
| Heat Fuel  | 03                         | Gas            | Effective Year Built           |            | 2017        |   |      |       |            |             |
| Heat Type:   | 03                         | Hot Air-no Duc | Depreciation Code              |            | G           |   |      |       |            |             |
| AC Type:   | 02                         | Heat Pump      | Remodel Rating                 |            |             |   |      |       |            |             |
| Total Bedrooms   | 01                         | 1 Bedroom      | Year Remodeled                 |            |             |   |      |       |            |             |
| Total Bthrms:  | 1                          |                | Depreciation %                 |            | 5           |   |      |       |            |             |
| Total Half Baths   | 0                          |                | Functional Obsol               |            | 0           |   |      |       |            |             |
| Total Xtra Fixtrs  |                            |                | External Obsol                 |            | 0           |   |      |       |            |             |
| Total Rooms:   | 3                          |                | Trend Factor                   |            | 1           |   |      |       |            |             |
| Bath Style:  | 02                         | Average        | Condition                      |            |             |   |      |       |            |             |
| Kitchen Style:   | 02                         | Modern         | Condition %                    |            |             |   |      |       |            |             |
|  |                            |                | Percent Good                   |            | 95          |   |      |       |            |             |
|  |                            |                | Cns Sect Rcnld                 |            | 771,800     |   |      |       |            |             |
|  |                            |                | Dep % Ovr                      |            |             |   |      |       |            |             |
|  |                            |                | Dep Ovr Comment                |            |             |   |      |       |            |             |
|  |                            |                | Misc Imp Ovr                   |            |             |   |      |       |            |             |
|  |                            |                | Misc Imp Ovr Comment           |            |             |   |      |       |            |             |
|  |                            |                | Cost to Cure Ovr               |            |             |   |      |       |            |             |
|  |                            |                | Cost to Cure Ovr Comment       |            |             |   |      |       |            |             |
| OB - OUTBUILDING & YARD ITEMS(L) / XF - BUILDING EXTRA FEATURES(B) |                            |                |                                |            |             |   |      |       |            |             |
| Code   | Description                | L/B            | Units                          | Unit Price | Yr Blt      | Cond. Cd  | % Gd | Grade | Grade Adj. | Appr. Value |
|  |                            |                |                                |            |             |   |      |       |            |             |
| BUILDING SUB-AREA SUMMARY SECTION                                  |                            |                |                                |            |             |   |      |       |            |             |
| Code   | Description                | Living Area    | Floor Area                     | Eff Area   | Unit Cost   | Undeprec Value  |      |       |            |             |
| BAS  | First Floor                | 1,144          | 1,144                          | 1,144      | 511.27      | 584,895   |      |       |            |             |
| CTH  | Cath CIng                  | 0              | 475                            | 24         | 25.83       | 12,271  |      |       |            |             |
| EAF  | Attic, Expansion, Finished | 142            | 405                            | 142        | 179.26      | 72,601  |      |       |            |             |
| UBM  | Basement, Unfinished       | 0              | 669                            | 134        | 102.41      | 68,510  |      |       |            |             |
| UGR  | Garage, Unfinished         | 0              | 475                            | 143        | 153.92      | 73,112  |      |       |            |             |
| WDK  | Deck, Wood                 | 0              | 18                             | 2          | 56.81       | 1,023   |      |       |            |             |
| Ttl Gross Liv / Lease Area   |                            | 1,286          | 3,186                          | 1,589      |             | 812,412   |      |       |            |             |

| CURRENT OWNER  |            | TOPO        | UTILITIES   | STRT / ROAD   |             | LOCATION   | CURRENT ASSESSMENT     |   |                                |           | 1302<br>EDGARTOWN, MA<br><br><b>VISION</b> |                                |                     |                |            |           |
|--|------------|-------------|-------------|---|-------------|------------|------------------------|---|--------------------------------|-----------|--|--------------------------------|---------------------|----------------|------------|-----------|
| BRINE WILLIAM H III<br><br>12 LITCHFIELD RD<br><br>EDGARTOWN MA 02539  |            |             |             | 9   | Town Street |            | Description            | Code  | Appraised                      | Assessed  |  |                                |                     |                |            |           |
|  |            |             |             | 3   | Unpaved     |            | RESIDENTL              | 1090  | 3,363,400                      | 3,363,400 |  |                                |                     |                |            |           |
|  |            |             |             |   |             |            | RES LND                | 1090  | 2,132,700                      | 2,132,700 |  |                                |                     |                |            |           |
| <b>SUPPLEMENTAL DATA</b>   |            |             |             |   |             |            |                        |   |                                |           |  |                                |                     |                |            |           |
| Alt Prcl ID<br>PLN#/Rec CF 107 4/25/75<br>Lot# 52<br>Plan Notes PRIOR CF94<br>Plan Notes<br>Plan Notes<br>GIS ID M_283951_792859 |            |             |             | Restriction<br>Hist Distrct<br>Other Note<br>UC-Misc 1<br>UC-Misc 2<br><br>Assoc Pid# |             |            | Total                  |   | 5,496,100                      | 5,496,100 |  |                                |                     |                |            |           |
| RECORD OF OWNERSHIP  |            |             | BK-VOL/PAGE | SALE DATE   | Q/U         | V/I        | SALE PRICE             | VC  | PREVIOUS ASSESSMENTS (HISTORY) |           |  |                                |                     |                |            |           |
| BRINE WILLIAM H III  |            |             | 1304        | 0682  | 01-04-2013  | U          | I                      | 500,000   | 1V                             | Year      | Code                                       | Assessed                       | Year                | Code           | Assessed   |           |
| BRINE WILLIAM H III &<br>MARTIN HEATHER B BRINE WM H III &<br>COUGHLIN DANIEL M TRS<br>COUGHLIN JOAN TRS                         |            |             | 1304        | 0087  | 12-31-2012  | U          | I                      | 1,000,000   | 1A                             | 2023      | 1090                                       | 3,252,900                      | 2022                | 1090           | 2,283,000  |           |
|  |            |             | 1245        | 0479  | 05-13-2011  | U          | I                      | 1   | 1A                             |           | 1090                                       | 2,026,100                      | 2021                | 1090           | 1,812,793  |           |
|  |            |             | 0770        | 0072  | 07-01-1999  | U          | I                      | 1   | 1A                             |           |  |                                |                     |                |            |           |
|  |            |             | 0769        | 0135  | 06-22-1999  | U          | I                      | 1   | 1A                             |           |  |                                |                     |                |            |           |
|  |            |             |             |   |             |            | Total                  |   | 5,279,000                      | Total     |  | 4,095,793                      | Total               |                | 3,669,253  |           |
| EXEMPTIONS   |            |             |             | OTHER ASSESSMENTS   |             |            |                        | This signature acknowledges a visit by a Data Collector or Assessor |                                |           |  |                                |                     |                |            |           |
| Year   | Code       | Description | Amount      | Code  | Description | Number     | Amount                 | Comm Int  |                                |           |  |                                |                     |                |            |           |
|  |            |             | Total       |   |             |            |                        | 0.00  |                                |           |  |                                |                     |                |            |           |
| ASSESSING NEIGHBORHOOD   |            |             |             |   |             |            |                        |   |                                |           |  | <b>APPRAISED VALUE SUMMARY</b> |                     |                |            |           |
| Nbhd   |            | Nbhd Name   |             | B   |             | Tracing    |                        | Batch   |                                |           |  | Appraised Bldg. Value (Card)   |                     |                |            | 3,358,500 |
| CPY5   |            |             |             |   |             |            |                        |   |                                |           |  | Appraised Xf (B) Value (Bldg)  |                     |                |            | 1,800     |
|  |            |             |             |   |             |            |                        |   |                                |           |  | Appraised Ob (B) Value (Bldg)  |                     |                |            | 3,100     |
|  |            |             |             |   |             |            |                        |   |                                |           |  | Appraised Land Value (Bldg)    |                     |                |            | 2,132,700 |
|  |            |             |             |   |             |            |                        |   |                                |           |  | Special Land Value             |                     |                |            | 0         |
|  |            |             |             |   |             |            |                        |   |                                |           |  | Total Appraised Parcel Value   |                     |                |            | 5,496,100 |
|  |            |             |             |   |             |            |                        |   |                                |           |  | Valuation Method               |                     |                |            | C         |
|  |            |             |             |   |             |            |                        |   |                                |           |  | Total Appraised Parcel Value   |                     |                |            | 5,496,100 |
| BUILDING PERMIT RECORD   |            |             |             |   |             |            |                        |   |                                |           |  | VISIT / CHANGE HISTORY         |                     |                |            |           |
| Permit Id  | Issue Date | Type        | Description | Amount  | Insp Date   | % Comp     | Date Comp              | Comments  | Date                           | Id        | Type                                       | Is                             | Cd                  | Purpost/Result |            |           |
|  |            |             |             |   |             |            |                        |   |                                |           |  |                                |                     |                |            |           |
| LAND LINE VALUATION SECTION  |            |             |             |   |             |            |                        |   |                                |           |  |                                |                     |                |            |           |
| B  | Use Code   | Description | Zone        | Land Type   | Land Units  | Unit Price | Size Adj               | Site Index  | Cond.                          | Nbhd.     | Nbhd. Adj                                  | Notes                          | Location Adjustment | Adj Unit P     | Land Value |           |
| 3  | 1090       | MULTI HSES  |             |   | 0 SF        | 0.00       | 1.00000                |   | 1.00                           |           | 1.000                                      |                                |                     | 0              | 0          |           |
| Total Card Land Units  |            |             |             |   | 0.00        | AC         | Parcel Total Land Area |   |                                |           |  | 3.00                           | Total Land Value    |                |            | 0         |

| CONSTRUCTION DETAIL |    |                | CONSTRUCTION DETAIL (CONTINUED) |      |             |
|---------------------|----|----------------|---------------------------------|------|-------------|
| Element             | Cd | Description    | Element                         | Cd   | Description |
| Style:              | 07 | Standard Plus  |                                 |      |             |
| Model               | 01 | Residential    |                                 |      |             |
| Grade:              | 06 | Good           |                                 |      |             |
| Stories:            | 1  |                |                                 |      |             |
| Occupancy           |    |                |                                 |      |             |
| Exterior Wall 1     | 14 | Wood Shingle   |                                 |      |             |
| Exterior Wall 2     |    |                |                                 |      |             |
| Roof Structure:     | 03 | Gable/Hip      |                                 |      |             |
| Roof Cover          | 10 | Wood Shingle   |                                 |      |             |
| Interior Wall 1     | 05 | Drywall/Sheet  |                                 |      |             |
| Interior Wall 2     | 06 | Cust Wd Panel  |                                 |      |             |
| Interior Flr 1      | 12 | Hardwood       |                                 |      |             |
| Interior Flr 2      |    |                |                                 |      |             |
| Heat Fuel           | 03 | Gas            |                                 |      |             |
| Heat Type:          | 04 | Forced Air-Duc |                                 |      |             |
| AC Type:            | 03 | Central        |                                 |      |             |
| Total Bedrooms      | 04 | 4 Bedrooms     |                                 |      |             |
| Total Bthrms:       | 3  |                |                                 |      |             |
| Total Half Baths    | 1  |                |                                 |      |             |
| Total Xtra Fixtrs   |    |                |                                 |      |             |
| Total Rooms:        | 7  |                |                                 |      |             |
| Bath Style:         | 02 | Average        |                                 |      |             |
| Kitchen Style:      | 02 | Modern         |                                 |      |             |
|                     |    |                | <b>CONDO DATA</b>               |      |             |
|                     |    |                | Parcel Id                       | C    | Ownr 0.0    |
|                     |    |                |                                 | B    | S           |
|                     |    |                | Adjust Type                     | Code | Description |
|                     |    |                | Condo Flr                       |      |             |
|                     |    |                | Condo Unit                      |      |             |
|                     |    |                | <b>COST / MARKET VALUATION</b>  |      |             |
|                     |    |                | Building Value New              |      | 1,519,601   |
|                     |    |                | Year Built                      |      | 2004        |
|                     |    |                | Effective Year Built            |      | 2017        |
|                     |    |                | Depreciation Code               |      | G           |
|                     |    |                | Remodel Rating                  |      |             |
|                     |    |                | Year Remodeled                  |      |             |
|                     |    |                | Depreciation %                  |      | 5           |
|                     |    |                | Functional Obsol                |      |             |
|                     |    |                | External Obsol                  |      |             |
|                     |    |                | Trend Factor                    |      | 1           |
|                     |    |                | Condition                       |      |             |
|                     |    |                | Condition %                     |      |             |
|                     |    |                | Percent Good                    |      | 95          |
|                     |    |                | Cns Sect Rcnd                   |      | 1,443,600   |
|                     |    |                | Dep % Ovr                       |      |             |
|                     |    |                | Dep Ovr Comment                 |      |             |
|                     |    |                | Misc Imp Ovr                    |      |             |
|                     |    |                | Misc Imp Ovr Comment            |      |             |
|                     |    |                | Cost to Cure Ovr                |      |             |
|                     |    |                | Cost to Cure Ovr Comment        |      |             |

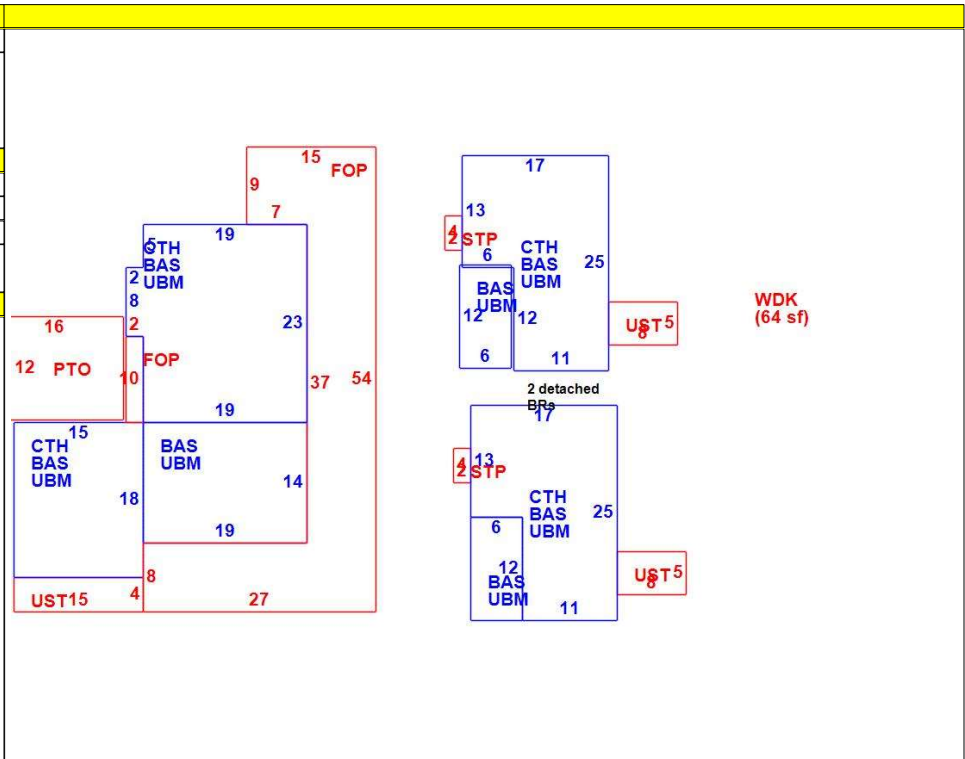

| OB - OUTBUILDING & YARD ITEMS(L) / XF - BUILDING EXTRA FEATURES(B) |             |     |       |            |        |          |      |       |            |             |
|--|-------------|-----|-------|------------|--------|----------|------|-------|------------|-------------|
| Code   | Description | L/B | Units | Unit Price | Yr Blt | Cond. Cd | % Gd | Grade | Grade Adj. | Appr. Value |
| ODS  | OUTDOOR S   | L   | 1     | 700.00     | 2007   |          | 100  |       | 0.00       | 700         |

| BUILDING SUB-AREA SUMMARY SECTION |                              |             |            |          |           |                |  |
|-----------------------------------|------------------------------|-------------|------------|----------|-----------|----------------|--|
| Code                              | Description                  | Living Area | Floor Area | Eff Area | Unit Cost | Undeprec Value |  |
| BAS                               | First Floor                  | 1,839       | 1,839      | 1,839    | 600.60    | 1,104,503      |  |
| CTH                               | Cath Cing                    | 0           | 1,429      | 71       | 29.84     | 42,643         |  |
| FOP                               | Porch, Open, Finished        | 0           | 667        | 133      | 119.76    | 79,880         |  |
| PTO                               | Patio                        | 0           | 192        | 19       | 59.43     | 11,411         |  |
| STP                               | Stoop                        | 0           | 16         | 2        | 75.08     | 1,201          |  |
| UBM                               | Basement, Unfinished         | 0           | 1,839      | 368      | 120.19    | 221,021        |  |
| UST                               | Utility, Storage, Unfinished | 0           | 140        | 63       | 270.27    | 37,838         |  |
| WDK                               | Deck, Wood                   | 0           | 64         | 6        | 56.31     | 3,604          |  |
| Ttl Gross Liv / Lease Area        |                              | 1,839       | 6,186      | 2,501    |           | 1,502,101      |  |