

| CURRENT OWNER | | TOPO | UTILITIES | STRT / ROAD | LOCATION | CURRENT ASSESSMENT | | | | 1302 EDGARTOWN, MA | | | | | | | |
|--|------------|--------------------|-------------------|--------------|-------------|--------------------|---|--------------------------------|-----------|--|-----------|-----------|---------------------|------------|--------------------------|----------|-----------|
| HEALY THOMAS JEREMIAH HAGERTY MEGAN 310 SOUTH ST 3RD FLOOR MORRISTOWN NJ 07960 | | | | | | Description | Code | Appraised | Assessed | | | | | | | | |
| | | | | | | RESIDENTL | 1010 | 862,200 | 862,200 | VISION | | | | | | | |
| | | | | | | RES LND | 1010 | 1,066,300 | 1,066,300 | | | | | | | | |
| SUPPLEMENTAL DATA | | | | | | | | | | | | | | | | | |
| Alt Prcl ID | | PLN#/Rec LC 13041F | | Restriction | | | | | | | | | | | | | |
| Lot# 6 | | Plan Notes | | Hist Distrct | | | | | | | | | | | | | |
| Plan Notes | | Plan Notes | | Other Note | | | | | | | | | | | | | |
| Plan Notes | | Plan Notes | | UC-Misc 1 | | | | | | | | | | | | | |
| Plan Notes | | Plan Notes | | UC-Misc 2 | | | | | | | | | | | | | |
| GIS ID M_283897_791446 | | | | Assoc Pid# | | | | | | | | | | | | | |
| | | | | | | Total | | 1,928,500 | 1,928,500 | | | | | | | | |
| RECORD OF OWNERSHIP | | BK-VOL/PAGE | SALE DATE | Q/U | V/I | SALE PRICE | VC | PREVIOUS ASSESSMENTS (HISTORY) | | | | | | | | | |
| HEALY THOMAS JEREMIAH | | 82 3 | 12-16-2020 | U | I | 1 | 1A | Year | Code | Assessed | Year | Code | Assessed | Year | Code | Assessed | |
| HEALEY THOMAS J & GASSEL VIRGINIA S & GASSEL VIRGINIA S | | 0060 0121 | 08-23-2002 | Q | V | 825,000 | 01 | 2023 | 1010 | 818,100 | 2022 | 1010 | 586,100 | 2021 | 1010 | 586,100 | |
| JACOBS TRAVIS BEAL & | | 0043 0287 | 10-28-1991 | U | I | 1 | 1A | | 1010 | 1,013,000 | | 1010 | 906,396 | | 1010 | 693,127 | |
| | | 0031 0157 | 08-25-1983 | Q | V | 73,000 | 00 | | | | | | | | | | |
| | | 00010 0247 | 07-20-1981 | U | V | 1 | 1A | | | | | | | | | | |
| | | | | | | Total | | 1,831,100 | Total | 1,492,496 | Total | 1,279,227 | | | | | |
| EXEMPTIONS | | | OTHER ASSESSMENTS | | | | This signature acknowledges a visit by a Data Collector or Assessor | | | | | | | | | | |
| Year | Code | Description | Amount | Code | Description | Number | Amount | Comm | Int | | | | | | | | |
| | | Total | 0.00 | | | | | | | | | | | | | | |
| ASSESSING NEIGHBORHOOD | | | | | | | | | | APPRAISED VALUE SUMMARY | | | | | | | |
| Nbhd | Nbhd Name | | B | Tracing | | Batch | | | | Appraised Bldg. Value (Card) 861,500 | | | | | | | |
| CPY5 | | | | | | | | | | Appraised Xf (B) Value (Bldg) 0 | | | | | | | |
| | | | | | | | | | | Appraised Ob (B) Value (Bldg) 700 | | | | | | | |
| | | | | | | | | | | Appraised Land Value (Bldg) 1,066,300 | | | | | | | |
| | | | | | | | | | | Special Land Value 0 | | | | | | | |
| | | | | | | | | | | Total Appraised Parcel Value 1,928,500 | | | | | | | |
| | | | | | | | | | | Valuation Method C | | | | | | | |
| | | | | | | | | | | Total Appraised Parcel Value 1,928,500 | | | | | | | |
| BUILDING PERMIT RECORD | | | | | | | | | | VISIT / CHANGE HISTORY | | | | | | | |
| Permit Id | Issue Date | Type | Description | Amount | Insp Date | % Comp | Date Comp | Comments | | Date | Id | Type | Is | Cd | Purpost/Result | | |
| 2012-382 | 05-24-2012 | RA | Res Add/Alter | | | | | CONVERT GAR TO LIVING S | | 05-25-2022 | LS | | | 11 | Field Review | | |
| 238-2007 | 06-09-2008 | CO | CO ISSUED | | | | | DETACHED BR OVER GARA | | 05-23-2017 | DM | | | 11 | Field Review | | |
| 2007-238 | 05-07-2007 | RN | Res New Cons | | | | | new FGR + detch'd BR | | 05-01-2013 | EP | | | 01 | Cyclical Reinspection | | |
| | | | | | | | | | | 11-28-2011 | DM | | | 11 | Field Review | | |
| | | | | | | | | | | 07-17-2009 | EP | | | 12 | Bldg Permit/Measur/New C | | |
| | | | | | | | | | | 07-03-2008 | EP | 02 | | 12 | Bldg Permit/Measur/New C | | |
| | | | | | | | | | | 07-21-2006 | WP | | | 11 | Field Review | | |
| LAND LINE VALUATION SECTION | | | | | | | | | | | | | | | | | |
| B | Use Code | Description | Zone | Land Type | Land Units | Unit Price | Size Adj | Site Index | Cond. | Nbhd. | Nbhd. Adj | Notes | Location Adjustment | Adj Unit P | Land Value | | |
| 1 | 1010 | SINGL FAM M-0 | R12 | | 130,680 SF | 2.04 | 1.00000 | 5 | 1.00 | CPY5 | 2.000 | VIEW | V20 | 8.16 | 1,066,300 | | |
| Total Card Land Units | | | | | 3.00 | AC | Parcel Total Land Area | | | | | 3.00 | Total Land Value | | | | 1,066,300 |

| CONSTRUCTION DETAIL | | | CONSTRUCTION DETAIL (CONTINUED) | | |
|---------------------|----|----------------|---------------------------------|----|-------------|
| Element | Cd | Description | Element | Cd | Description |
| Style: | 07 | Standard Plus | | | |
| Model | 01 | Residential | | | |
| Grade: | 05 | Average +20 | | | |
| Stories: | 2 | | | | |
| Occupancy | 1 | | | | |
| Exterior Wall 1 | 14 | Wood Shingle | | | |
| Exterior Wall 2 | | | | | |
| Roof Structure: | 03 | Gable/Hip | | | |
| Roof Cover | 03 | Asph/F Gls/Cmp | | | |
| Interior Wall 1 | 03 | Plastered | | | |
| Interior Wall 2 | 02 | Wall Brd/Wood | | | |
| Interior Flr 1 | 12 | Hardwood | | | |
| Interior Flr 2 | 09 | Pine/Soft Wood | | | |
| Heat Fuel | 03 | Gas | | | |
| Heat Type: | 04 | Forced Air-Duc | | | |
| AC Type: | 03 | Central | | | |
| Total Bedrooms | 02 | 2 Bedrooms | | | |
| Total Bthrms: | 1 | | | | |
| Total Half Baths | 0 | | | | |
| Total Xtra Fixtrs | | | | | |
| Total Rooms: | 5 | | | | |
| Bath Style: | 03 | Modern | | | |
| Kitchen Style: | 03 | Luxurious | | | |

| CONDO DATA | | | | |
|-------------|------|-------------|---------|-----|
| Parcel Id | | C | Owne | 0.0 |
| | | | B | S |
| Adjust Type | Code | Description | Factor% | |
| Condo Flr | | | | |
| Condo Unit | | | | |

| COST / MARKET VALUATION | |
|--------------------------|---------|
| Building Value New | 870,221 |
| Year Built | 2007 |
| Effective Year Built | 2021 |
| Depreciation Code | R |
| Remodel Rating | |
| Year Remodeled | 2012 |
| Depreciation % | 1 |
| Functional Obsol | 0 |
| External Obsol | 0 |
| Trend Factor | 1 |
| Condition | |
| Condition % | |
| Percent Good | 99 |
| Cns Sect Rcnd | 861,500 |
| Dep % Ovr | |
| Dep Ovr Comment | |
| Misc Imp Ovr | |
| Misc Imp Ovr Comment | |
| Cost to Cure Ovr | |
| Cost to Cure Ovr Comment | |

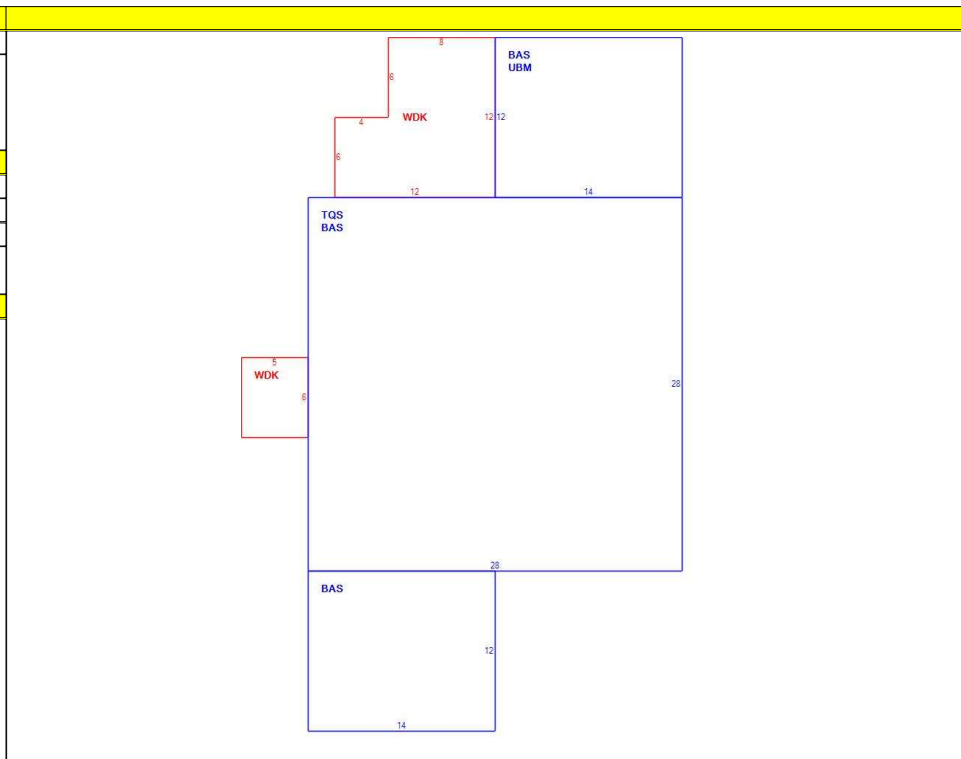

| OB - OUTBUILDING & YARD ITEMS(L) / XF - BUILDING EXTRA FEATURES(B) | | | | | | | | | | |
|--|-------------|-----|-------|------------|--------|----------|------|-------|------------|-------------|
| Code | Description | L/B | Units | Unit Price | Yr Blt | Cond. Cd | % Gd | Grade | Grade Adj. | Appr. Value |
| ODS | OUTDOOR S | L | 1 | 700.00 | 2012 | | 100 | | 0.00 | 700 |

| BUILDING SUB-AREA SUMMARY SECTION | | | | | | |
|-----------------------------------|----------------------|-------------|------------|----------|-----------|----------------|
| Code | Description | Living Area | Floor Area | Eff Area | Unit Cost | Undeprec Value |
| BAS | First Floor | 1,120 | 1,120 | 1,120 | 495.29 | 554,723 |
| TQS | Three Quarter Story | 588 | 784 | 588 | 371.47 | 291,229 |
| UBM | Basement, Unfinished | 0 | 168 | 34 | 100.24 | 16,840 |
| WDK | Deck, Wood | 0 | 150 | 15 | 49.53 | 7,429 |
| Ttl Gross Liv / Lease Area | | 1,708 | 2,222 | 1,757 | | 870,221 |

