

| CURRENT OWNER                      |            | TOPO            | UTILITIES      | STRT / ROAD       | LOCATION                      | CURRENT ASSESSMENT |                        |   |                                | 1302<br>EDGARTOWN, MA |           |       |                     |                       |                          |         |         |
|------------------------------------|------------|-----------------|----------------|-------------------|-------------------------------|--------------------|------------------------|---|--------------------------------|-----------------------|-----------|-------|---------------------|-----------------------|--------------------------|---------|---------|
| MACINNIS DEBORAH A                 |            |                 | 2 Public Water | 9 Town Street     |                               | Description        | Code                   | Appraised   | Assessed                       |                       |           |       |                     |                       |                          |         |         |
| 8 MERCIER WAY                      |            |                 |                | 1 Paved           |                               | RESIDENTL          | 1010                   | 475,900   | 475,900                        | <b>VISION</b>         |           |       |                     |                       |                          |         |         |
| EDGARTOWN MA 02539                 |            |                 |                |                   |                               | RES LND            | 1010                   | 588,900   | 588,900                        |                       |           |       |                     |                       |                          |         |         |
| SUPPLEMENTAL DATA                  |            |                 |                |                   |                               | Total              |                        | 1,064,800   | 1,064,800                      |                       |           |       |                     |                       |                          |         |         |
| Alt Prcl ID                        |            | Restriction     |                | Hist Distrct      |                               |                    |                        |   |                                |                       |           |       |                     |                       |                          |         |         |
| PLN#/Rec                           |            | Other Note      |                | UC-Misc 1         |                               |                    |                        |   |                                |                       |           |       |                     |                       |                          |         |         |
| Lot#                               |            | UC-Misc 2       |                | Assoc Pid#        |                               |                    |                        |   |                                |                       |           |       |                     |                       |                          |         |         |
| Plan Notes                         |            |                 |                |                   |                               |                    |                        |   |                                |                       |           |       |                     |                       |                          |         |         |
| Plan Notes                         |            |                 |                |                   |                               |                    |                        |   |                                |                       |           |       |                     |                       |                          |         |         |
| Plan Notes                         |            |                 |                |                   |                               |                    |                        |   |                                |                       |           |       |                     |                       |                          |         |         |
| GIS ID                             |            | M_282483_791853 |                |                   |                               |                    |                        |   |                                |                       |           |       |                     |                       |                          |         |         |
| RECORD OF OWNERSHIP                |            |                 | BK-VOL/PAGE    | SALE DATE         | Q/U                           | V/I                | SALE PRICE             | VC  | PREVIOUS ASSESSMENTS (HISTORY) |                       |           |       |                     |                       |                          |         |         |
| MACINNIS DEBORAH A                 |            |                 | 0039 0225      | 04-03-2017        | U                             | I                  | 1                      | 1A  | Year                           | Code                  | Assessed  | Year  | Code                | Assessed              |                          |         |         |
| MACINNIS HUGH JAMES JR & DEBORAH A |            |                 | 00039 0225     | 04-08-1988        |                               |                    | 0                      |   | 2023                           | 1010                  | 475,900   | 2022  | 1010                | 309,600               |                          |         |         |
|                                    |            |                 |                |                   |                               |                    |                        |   |                                | 1010                  | 588,900   | 2021  | 1010                | 340,500               |                          |         |         |
|                                    |            |                 |                |                   |                               |                    |                        |   |                                |                       |           |       | 1010                | 508,000               |                          |         |         |
|                                    |            |                 |                |                   |                               |                    |                        |   | Total                          |                       | 1,064,800 | Total |                     | 898,500               | Total                    |         | 848,500 |
| EXEMPTIONS                         |            |                 |                | OTHER ASSESSMENTS |                               |                    |                        | This signature acknowledges a visit by a Data Collector or Assessor |                                |                       |           |       |                     |                       |                          |         |         |
| Year                               | Code       | Description     | Amount         | Code              | Description                   | Number             | Amount                 | Comm Int  |                                |                       |           |       |                     |                       |                          |         |         |
|                                    |            |                 |                |                   |                               |                    |                        |   |                                |                       |           |       |                     |                       |                          |         |         |
| Total                              |            |                 | 0.00           |                   |                               |                    |                        |   |                                |                       |           |       |                     |                       |                          |         |         |
| ASSESSING NEIGHBORHOOD             |            |                 |                |                   |                               |                    |                        | APPRAISED VALUE SUMMARY   |                                |                       |           |       |                     |                       |                          |         |         |
| Nbhd                               | Nbhd Name  | B               | Tracing        | Batch             | Appraised Bldg. Value (Card)  |                    |                        |   | 457,300                        |                       |           |       |                     |                       |                          |         |         |
| 0050                               |            |                 |                |                   | Appraised Xf (B) Value (Bldg) |                    |                        |   | 2,400                          |                       |           |       |                     |                       |                          |         |         |
|                                    |            |                 |                |                   | Appraised Ob (B) Value (Bldg) |                    |                        |   | 16,200                         |                       |           |       |                     |                       |                          |         |         |
|                                    |            |                 |                |                   | Appraised Land Value (Bldg)   |                    |                        |   | 588,900                        |                       |           |       |                     |                       |                          |         |         |
|                                    |            |                 |                |                   | Special Land Value            |                    |                        |   | 0                              |                       |           |       |                     |                       |                          |         |         |
|                                    |            |                 |                |                   | Total Appraised Parcel Value  |                    |                        |   | 1,064,800                      |                       |           |       |                     |                       |                          |         |         |
|                                    |            |                 |                |                   | Valuation Method              |                    |                        |   | C                              |                       |           |       |                     |                       |                          |         |         |
|                                    |            |                 |                |                   | Total Appraised Parcel Value  |                    |                        |   | 1,064,800                      |                       |           |       |                     |                       |                          |         |         |
| BUILDING PERMIT RECORD             |            |                 |                |                   |                               |                    |                        | VISIT / CHANGE HISTORY  |                                |                       |           |       |                     |                       |                          |         |         |
| Permit Id                          | Issue Date | Type            | Description    | Amount            | Insp Date                     | % Comp             | Date Comp              | Comments  | Date                           | Id                    | Type      | Is    | Cd                  | Purpost/Result        |                          |         |         |
| 304                                | 01-01-2003 | NC              | New Construct  |                   | 01-08-2004                    | 100                | 01-01-2004             |   | 10-20-2022                     | EH                    |           | 6     | 01                  | Cyclical Reinspection |                          |         |         |
| 2003:125                           | 07-01-2002 | AD              | SHED           |                   | 01-28-2003                    | 100                | 01-01-2003             |   | 05-20-2022                     | LS                    |           |       | 11                  | Field Review          |                          |         |         |
| 353                                | 01-01-2000 | NC              | New Construct  |                   |                               |                    |                        | SHED  | 05-22-2017                     | PH                    |           |       | 11                  | Field Review          |                          |         |         |
| 2008-185                           |            | RA              | Res Add/Alter  |                   | 01-27-2008                    |                    |                        | MINOR ALT SFR   | 06-18-2014                     | SER                   |           |       | 11                  | Field Review          |                          |         |         |
|                                    |            |                 |                |                   |                               |                    |                        |   |                                | 11-14-2011            | DM        |       |                     | 11                    | Field Review             |         |         |
|                                    |            |                 |                |                   |                               |                    |                        |   |                                | 05-14-2009            | EP        |       |                     | 12                    | Bldg Permit/Measur/New C |         |         |
|                                    |            |                 |                |                   |                               |                    |                        |   |                                | 04-02-2004            | WP        |       |                     | 05                    | Measur/Review/New Const  |         |         |
| LAND LINE VALUATION SECTION        |            |                 |                |                   |                               |                    |                        |   |                                |                       |           |       |                     |                       |                          |         |         |
| B                                  | Use Code   | Description     | Zone           | Land Type         | Land Units                    | Unit Price         | Size Adj               | Site Index  | Cond.                          | Nbhd.                 | Nbhd. Adj | Notes | Location Adjustment | Adj Unit P            | Land Value               |         |         |
| 1                                  | 1010       | SINGL FAM M-0   | R20            |                   | 21,400 SF                     | 14.11              | 1.00000                | 5   | 1.00                           | 0050                  | 1.950     |       |                     | 27.52                 | 588,900                  |         |         |
| Total Card Land Units              |            |                 |                |                   | 0.49                          | AC                 | Parcel Total Land Area |   |                                |                       |           | 0.49  | Total Land Value    |                       |                          | 588,900 |         |

| CONSTRUCTION DETAIL            |    |                | CONSTRUCTION DETAIL (CONTINUED) |     |             |
|--------------------------------|----|----------------|---------------------------------|-----|-------------|
| Element                        | Cd | Description    | Element                         | Cd  | Description |
| Style:                         | 01 | Ranch          |                                 |     |             |
| Model:                         | 01 | Residential    |                                 |     |             |
| Grade:                         | 04 | Above Ave      |                                 |     |             |
| Stories:                       | 1  | 1 Story        |                                 |     |             |
| Occupancy                      | 1  |                |                                 |     |             |
| Exterior Wall 1                | 14 | Wood Shingle   |                                 |     |             |
| Exterior Wall 2                |    |                |                                 |     |             |
| Roof Structure:                | 03 | Gable/Hip      |                                 |     |             |
| Roof Cover                     | 03 | Asph/F GlS/Cmp |                                 |     |             |
| Interior Wall 1                | 05 | Drywall/Sheet  |                                 |     |             |
| Interior Wall 2                |    |                |                                 |     |             |
| Interior Flr 1                 | 02 | Minimum/Plywd  |                                 |     |             |
| Interior Flr 2                 | 13 | Parquet        |                                 |     |             |
| Heat Fuel                      | 02 | Oil            |                                 |     |             |
| Heat Type:                     | 05 | Hot Water      |                                 |     |             |
| AC Type:                       | 01 | None           |                                 |     |             |
| Total Bedrooms                 | 02 | 2 Bedrooms     |                                 |     |             |
| Total Bthrms:                  | 1  |                |                                 |     |             |
| Total Half Baths               | 0  |                |                                 |     |             |
| Total Xtra Fixtrs              |    |                |                                 |     |             |
| Total Rooms:                   |    |                |                                 |     |             |
| Bath Style:                    | 02 | Average        |                                 |     |             |
| Kitchen Style:                 | 02 | Modern         |                                 |     |             |
| <b>CONDO DATA</b>              |    |                |                                 |     |             |
| Parcel Id                      |    | C              | Owne                            | 0.0 |             |
| Adjust Type                    |    |                | B                               | S   |             |
| Condo Flr                      |    |                |                                 |     |             |
| Condo Unit                     |    |                |                                 |     |             |
| <b>COST / MARKET VALUATION</b> |    |                |                                 |     |             |
| Building Value New             |    |                | 571,678                         |     |             |
| Year Built                     |    |                | 1970                            |     |             |
| Effective Year Built           |    |                | 2001                            |     |             |
| Depreciation Code              |    |                | G                               |     |             |
| Remodel Rating                 |    |                |                                 |     |             |
| Year Remodeled                 |    |                |                                 |     |             |
| Depreciation %                 |    |                | 20                              |     |             |
| Functional Obsol               |    |                | 0                               |     |             |
| External Obsol                 |    |                | 0                               |     |             |
| Trend Factor                   |    |                | 1                               |     |             |
| Condition                      |    |                |                                 |     |             |
| Condition %                    |    |                |                                 |     |             |
| Percent Good                   |    |                | 80                              |     |             |
| Cns Sect Rcnd                  |    |                | 457,300                         |     |             |
| Dep % Ovr                      |    |                |                                 |     |             |
| Dep Ovr Comment                |    |                |                                 |     |             |
| Misc Imp Ovr                   |    |                |                                 |     |             |
| Misc Imp Ovr Comment           |    |                |                                 |     |             |
| Cost to Cure Ovr               |    |                |                                 |     |             |
| Cost to Cure Ovr Comment       |    |                |                                 |     |             |

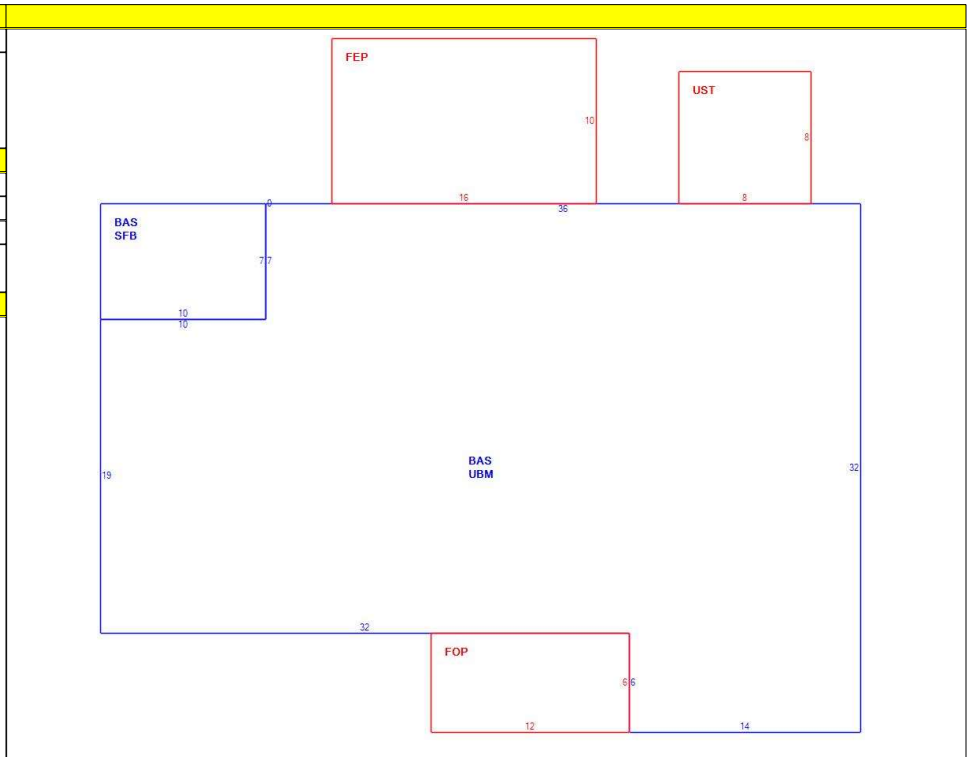

| OB - OUTBUILDING & YARD ITEMS(L) / XF - BUILDING EXTRA FEATURES(B) |             |     |       |            |        |          |      |       |            |             |
|--|-------------|-----|-------|------------|--------|----------|------|-------|------------|-------------|
| Code   | Description | L/B | Units | Unit Price | Yr Blt | Cond. Cd | % Gd | Grade | Grade Adj. | Appr. Value |
| FPL1   | FPL MSNRY 1 | B   | 1     | 3000.00    | 1996   |          | 80   |       | 0.00       | 2,400       |
| SPL4   | ABV GR ROU  | L   | 15    | 75.00      | 2000   |          | 100  |       | 0.00       | 1,100       |
| SHD1   | SHED FRAME  | L   | 120   | 16.00      | 2002   |          | 100  |       | 0.00       | 1,900       |
| FGR1   | GAR 1ST-AVE | L   | 528   | 25.00      | 2003   |          | 100  |       | 0.00       | 13,200      |

| BUILDING SUB-AREA SUMMARY SECTION |                              |             |            |          |           |                |
|-----------------------------------|------------------------------|-------------|------------|----------|-----------|----------------|
| Code                              | Description                  | Living Area | Floor Area | Eff Area | Unit Cost | Undeprec Value |
| BAS                               | First Floor                  | 1,280       | 1,280      | 1,280    | 336.68    | 430,947        |
| FEP                               | Porch, Enclosed, Finished    | 0           | 160        | 112      | 235.67    | 37,708         |
| FOP                               | Porch, Open, Finished        | 0           | 72         | 14       | 65.46     | 4,713          |
| SFB                               | Base, Semi-Finished          | 0           | 70         | 21       | 101.00    | 7,070          |
| UBM                               | Basement, Unfinished         | 0           | 1,210      | 242      | 67.34     | 81,476         |
| UST                               | Utility, Storage, Unfinished | 0           | 64         | 29       | 152.56    | 9,764          |
| Ttl Gross Liv / Lease Area        |                              | 1,280       | 2,856      | 1,698    |           | 571,678        |

