

| CURRENT OWNER  |            | TOPO                   | UTILITIES         | STRT / ROAD | LOCATION    | CURRENT ASSESSMENT     |           |   |                               | 1302<br>EDGARTOWN, MA  |                                |                  |                     |            |            |                       |
|--|------------|------------------------|-------------------|-------------|-------------|------------------------|-----------|---|-------------------------------|------------------------|--------------------------------|------------------|---------------------|------------|------------|-----------------------|
| HUES JACQUELINE V<br>HUES OULTON JR<br>640 NEPONSET ST |            |                        |                   |             |             | Description            | Code      | Appraised   | Assessed                      |                        |                                |                  |                     |            |            |                       |
|  |            |                        |                   |             |             | RESIDENTL              | 1010      | 1,329,900   | 1,329,900                     | <b>VISION</b>          |                                |                  |                     |            |            |                       |
|  |            |                        |                   |             |             | RES LND                | 1010      | 928,700   | 928,700                       |                        |                                |                  |                     |            |            |                       |
| SUPPLEMENTAL DATA                                      |            |                        |                   |             |             |                        |           |   |                               |                        |                                |                  |                     |            |            |                       |
| NORWOOD MA 02062                                       |            | Alt Prcl ID            | Restriction       |             |             |                        |           |   |                               |                        |                                |                  |                     |            |            |                       |
|  |            | PLN#/Rec 279/30        | Hist Distrct      |             |             |                        |           |   |                               |                        |                                |                  |                     |            |            |                       |
|  |            | Lot# 21                | Other Note        |             |             |                        |           |   |                               |                        |                                |                  |                     |            |            |                       |
|  |            | Plan Notes             | UC-Misc 1         |             |             |                        |           |   |                               |                        |                                |                  |                     |            |            |                       |
|  |            | Plan Notes             | UC-Misc 2         |             |             |                        |           |   |                               |                        |                                |                  |                     |            |            |                       |
|  |            | Plan Notes             |                   |             |             |                        |           |   |                               |                        |                                |                  |                     |            |            |                       |
|  |            | GIS ID M_281312_790772 | Assoc Pid#        |             |             |                        |           |   |                               |                        |                                |                  |                     |            |            |                       |
|  |            |                        |                   |             |             | Total                  |           | 2,258,600   | 2,258,600                     |                        |                                |                  |                     |            |            |                       |
| RECORD OF OWNERSHIP                                    |            | BK-VOL/PAGE            | SALE DATE         | Q/U         | V/I         | SALE PRICE             | VC        | PREVIOUS ASSESSMENTS (HISTORY)                                      |                               |                        |                                |                  |                     |            |            |                       |
| HUES OULTON JR   |            | 1651 0649              | 04-04-2023        | U           | I           |                        | 1 1A      | Year  | Code                          | Assessed               | Year                           | Code             | Assessed            | Year       | Code       | Assessed              |
| HUES JACQUELINE V                                      |            | 1575 768               | 04-27-2021        | U           | I           |                        | 1 1A      | 2023  | 1010                          | 1,252,200              | 2022                           | 1010             | 786,500             | 2021       | 1010       | 728,300               |
| HUES JACQUELINE V                                      |            | 1274 0324              | 03-16-2012        | U           | I           |                        | 1 1A      |   | 1010                          | 802,800                |                                | 1010             | 753,600             |            | 1010       | 655,500               |
| HUES MV HOUSE RENTAL LLC                               |            | 1157 0114              | 07-29-2008        | U           | I           |                        | 1 1A      |   |                               |                        |                                |                  |                     |            |            |                       |
| HUES OULTON A &  |            | 1017 0143              | 10-04-2004        | Q           | I           | 900,000                | 00        |   |                               |                        |                                |                  |                     |            |            |                       |
|  |            |                        |                   |             |             | Total                  |           | 2,055,000   | Total                         |                        | 1,540,100                      | Total            |                     | 1,383,800  |            |                       |
| EXEMPTIONS   |            |                        | OTHER ASSESSMENTS |             |             |                        |           | This signature acknowledges a visit by a Data Collector or Assessor |                               |                        |                                |                  |                     |            |            |                       |
| Year   | Code       | Description            | Amount            | Code        | Description | Number                 | Amount    | Comm  | Int                           |                        |                                |                  |                     |            |            |                       |
|  |            |                        |                   |             |             |                        |           |   |                               |                        | <b>APPRAISED VALUE SUMMARY</b> |                  |                     |            |            |                       |
|  |            | Total                  | 0.00              |             |             |                        |           |   |                               |                        | Appraised Bldg. Value (Card)   |                  |                     |            | 1,325,300  |                       |
|  |            |                        |                   |             |             |                        |           |   | Appraised Xf (B) Value (Bldg) |                        |                                |                  | 1,600               |            |            |                       |
|  |            |                        |                   |             |             |                        |           |   | Appraised Ob (B) Value (Bldg) |                        |                                |                  | 3,000               |            |            |                       |
|  |            |                        |                   |             |             |                        |           |   | Appraised Land Value (Bldg)   |                        |                                |                  | 928,700             |            |            |                       |
|  |            |                        |                   |             |             |                        |           |   | Special Land Value            |                        |                                |                  | 0                   |            |            |                       |
|  |            |                        |                   |             |             |                        |           |   | Total Appraised Parcel Value  |                        |                                |                  | 2,258,600           |            |            |                       |
|  |            |                        |                   |             |             |                        |           |   | Valuation Method              |                        |                                |                  | C                   |            |            |                       |
|  |            |                        |                   |             |             |                        |           |   | Total Appraised Parcel Value  |                        |                                |                  | 2,258,600           |            |            |                       |
| BUILDING PERMIT RECORD                                 |            |                        |                   |             |             |                        |           |   |                               | VISIT / CHANGE HISTORY |                                |                  |                     |            |            |                       |
| Permit Id  | Issue Date | Type                   | Description       | Amount      | Insp Date   | % Comp                 | Date Comp | Comments  |                               |                        | Date                           | Id               | Type                | Is         | Cd         | Purpost/Result        |
| 2021-312   | 11-27-2020 | RA                     |                   | 4,452       |             | 0                      |           | INSULATION  |                               |                        | 05-23-2022                     | LS               |                     |            | 11         | Field Review          |
| 2019-132   | 09-14-2018 | RA                     | Res Add/Alter     | 44,778      |             | 0                      |           | REROOF, REPLACE 5 SKYLI   |                               |                        | 05-24-2017                     | PH               |                     |            | 11         | Field Review          |
|  |            |                        |                   |             |             |                        |           |   |                               |                        | 03-30-2017                     | EP               |                     |            | 01         | Cyclical Reinspection |
|  |            |                        |                   |             |             |                        |           |   |                               |                        | 07-24-2014                     | EP               |                     |            | 01         | Cyclical Reinspection |
|  |            |                        |                   |             |             |                        |           |   |                               |                        | 06-17-2014                     | SER              |                     |            | 11         | Field Review          |
|  |            |                        |                   |             |             |                        |           |   |                               |                        | 11-18-2011                     | DM               |                     |            | 11         | Field Review          |
|  |            |                        |                   |             |             |                        |           |   |                               |                        | 02-09-2005                     | WP               |                     |            | 50         | UC Status Inspection  |
| LAND LINE VALUATION SECTION                            |            |                        |                   |             |             |                        |           |   |                               |                        |                                |                  |                     |            |            |                       |
| B  | Use Code   | Description            | Zone              | Land Type   | Land Units  | Unit Price             | Size Adj  | Site Index  | Cond.                         | Nbhd.                  | Nbhd. Adj                      | Notes            | Location Adjustment | Adj Unit P | Land Value |                       |
| 1  | 1010       | SINGL FAM M-0          | R60               |             | 28,488 SF   | 12.07                  | 1.00000   | 5   | 1.00                          | 0053                   | 2.700                          |                  |                     | 32.6       | 928,700    |                       |
| Total Card Land Units                                  |            |                        |                   |             | 0.65 AC     | Parcel Total Land Area |           |   |                               |                        | 0.65                           | Total Land Value |                     |            |            | 928,700               |

| CONSTRUCTION DETAIL            |      |                | CONSTRUCTION DETAIL (CONTINUED) |     |             |
|--------------------------------|------|----------------|---------------------------------|-----|-------------|
| Element                        | Cd   | Description    | Element                         | Cd  | Description |
| Style:                         | 04   | Cape Cod       |                                 |     |             |
| Model:                         | 01   | Residential    |                                 |     |             |
| Grade:                         | 06   | Good           |                                 |     |             |
| Stories:                       | 1.25 |                |                                 |     |             |
| Occupancy                      | 1    |                |                                 |     |             |
| Exterior Wall 1                | 14   | Wood Shingle   |                                 |     |             |
| Exterior Wall 2                |      |                |                                 |     |             |
| Roof Structure:                | 03   | Gable/Hip      |                                 |     |             |
| Roof Cover                     | 03   | Asph/F Gls/Cmp |                                 |     |             |
| Interior Wall 1                | 05   | Drywall/Sheet  |                                 |     |             |
| Interior Wall 2                |      |                |                                 |     |             |
| Interior Flr 1                 | 12   | Hardwood       |                                 |     |             |
| Interior Flr 2                 | 14   | Carpet         |                                 |     |             |
| Heat Fuel                      | 03   | Gas            |                                 |     |             |
| Heat Type:                     | 05   | Hot Water      |                                 |     |             |
| AC Type:                       | 01   | None           |                                 |     |             |
| Total Bedrooms                 | 04   | 4 Bedrooms     |                                 |     |             |
| Total Bthrms:                  | 2    |                |                                 |     |             |
| Total Half Baths               | 0    |                |                                 |     |             |
| Total Xtra Fixtrs              |      |                |                                 |     |             |
| Total Rooms:                   |      |                |                                 |     |             |
| Bath Style:                    | 02   | Average        |                                 |     |             |
| Kitchen Style:                 | 02   | Modern         |                                 |     |             |
| <b>CONDO DATA</b>              |      |                |                                 |     |             |
| Parcel Id                      |      | C              | Owne                            | 0.0 |             |
|                                |      |                | B                               | S   |             |
| Adjust Type                    | Code | Description    | Factor%                         |     |             |
| Condo Flr                      |      |                |                                 |     |             |
| Condo Unit                     |      |                |                                 |     |             |
| <b>COST / MARKET VALUATION</b> |      |                |                                 |     |             |
| Building Value New             |      |                | 1,656,594                       |     |             |
| Year Built                     |      |                | 1970                            |     |             |
| Effective Year Built           |      |                | 2002                            |     |             |
| Depreciation Code              |      |                | G                               |     |             |
| Remodel Rating                 |      |                |                                 |     |             |
| Year Remodeled                 |      |                |                                 |     |             |
| Depreciation %                 |      |                | 20                              |     |             |
| Functional Obsol               |      |                | 0                               |     |             |
| External Obsol                 |      |                | 0                               |     |             |
| Trend Factor                   |      |                | 1                               |     |             |
| Condition                      |      |                |                                 |     |             |
| Condition %                    |      |                |                                 |     |             |
| Percent Good                   |      |                | 80                              |     |             |
| Cns Sect Rcnd                  |      |                | 1,325,300                       |     |             |
| Dep % Ovr                      |      |                |                                 |     |             |
| Dep Ovr Comment                |      |                |                                 |     |             |
| Misc Imp Ovr                   |      |                |                                 |     |             |
| Misc Imp Ovr Comment           |      |                |                                 |     |             |
| Cost to Cure Ovr               |      |                |                                 |     |             |
| Cost to Cure Ovr Comment       |      |                |                                 |     |             |

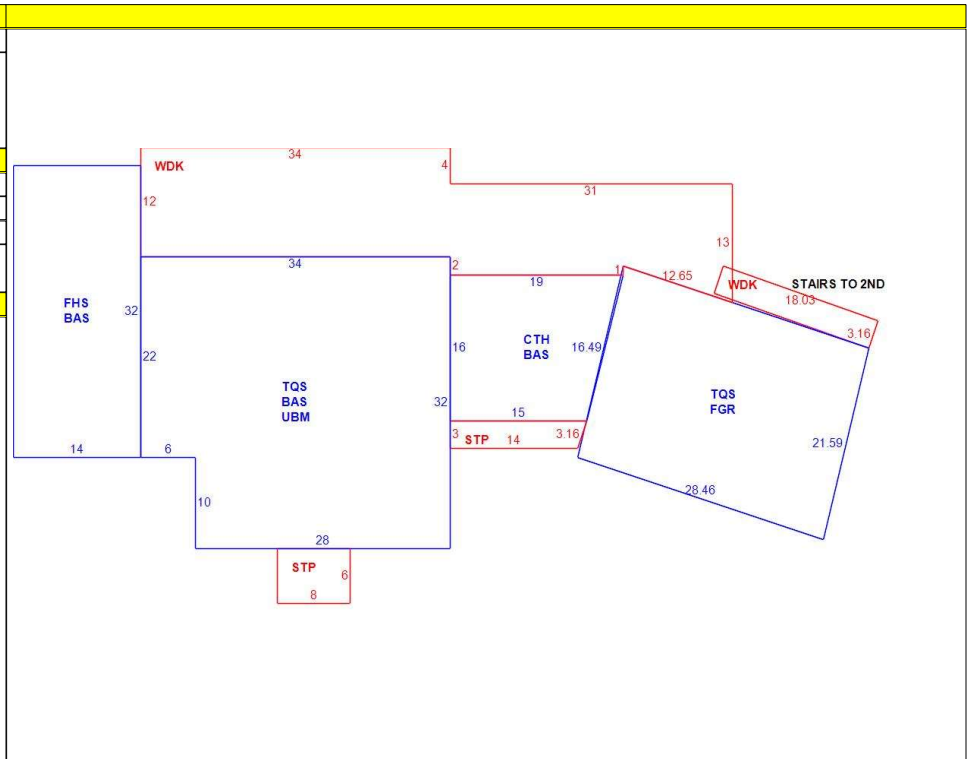

| OB - OUTBUILDING & YARD ITEMS(L) / XF - BUILDING EXTRA FEATURES(B) |             |     |       |            |        |          |      |       |            |             |
|--|-------------|-----|-------|------------|--------|----------|------|-------|------------|-------------|
| Code   | Description | L/B | Units | Unit Price | Yr Blt | Cond. Cd | % Gd | Grade | Grade Adj. | Appr. Value |
| FPL  | MTL-WD C/PI | B   | 1     | 2000.00    | 1996   |          | 80   |       | 0.00       | 1,600       |
| ODS  | OUTDOOR S   | L   | 1     | 700.00     |        |          | 100  |       | 0.00       | 700         |
| SHD1   | SHED FRAME  | L   | 192   | 16.00      | 1990   |          | 75   |       | 0.00       | 2,300       |

| BUILDING SUB-AREA SUMMARY SECTION |                      |             |            |          |           |                |
|-----------------------------------|----------------------|-------------|------------|----------|-----------|----------------|
| Code                              | Description          | Living Area | Floor Area | Eff Area | Unit Cost | Undeprec Value |
| BAS                               | First Floor          | 1,748       | 1,748      | 1,748    | 439.31    | 767,907        |
| CTH                               | Cath Cing            | 0           | 272        | 14       | 22.61     | 6,150          |
| FGR                               | Garage               | 0           | 612        | 245      | 175.87    | 107,630        |
| FHS                               | Half Story, Finished | 224         | 448        | 224      | 219.65    | 98,405         |
| STP                               | Stoop                | 0           | 92         | 9        | 42.98     | 3,954          |
| TQS                               | Three Quarter Story  | 1,230       | 1,640      | 1,230    | 329.48    | 540,346        |
| UBM                               | Basement, Unfinished | 0           | 1,028      | 206      | 88.03     | 90,497         |
| WDK                               | Deck, Wood           | 0           | 787        | 79       | 44.10     | 34,705         |
| Ttl Gross Liv / Lease Area        |                      | 3,202       | 6,627      | 3,755    |           | 1,649,594      |

