

| CURRENT OWNER   |            | TOPO         | UTILITIES         | STRT / ROAD              | LOCATION    | CURRENT ASSESSMENT |   |                                |            | 1302<br>EDGARTOWN, MA |           |       |                     |                       |            |           |           |
|---|------------|--------------|-------------------|--------------------------|-------------|--------------------|---|--------------------------------|------------|-----------------------|-----------|-------|---------------------|-----------------------|------------|-----------|-----------|
| FARNSWORTH PETER J &<br>STONE RANDI L<br>101 WEST 81ST ST<br>APT 516<br>NEW YORK NY 10024 |            |              |                   |                          |             | Description        | Code  | Appraised                      | Assessed   |                       |           |       |                     |                       |            |           |           |
|   |            |              |                   |                          |             | RESIDENTL          | 1090  | 3,712,700                      | 3,712,700  | <b>VISION</b>         |           |       |                     |                       |            |           |           |
|   |            |              |                   |                          |             | RES LND            | 1090  | 1,114,600                      | 1,114,600  |                       |           |       |                     |                       |            |           |           |
| SUPPLEMENTAL DATA   |            |              |                   |                          |             |                    |   |                                |            |                       |           |       |                     |                       |            |           |           |
| Alt Prcl ID   |            | Restriction  |                   | Hist Distrct             |             |                    |   |                                |            |                       |           |       |                     |                       |            |           |           |
| PLN#/Rec LC 8761-67 &68   |            | Other Note   |                   | UC-Misc 1 NS 2019 BP'S   |             |                    |   |                                |            |                       |           |       |                     |                       |            |           |           |
| Lot# 1009 & 1010  |            | UC-Misc 2    |                   | Assoc Pid#               |             |                    |   |                                |            |                       |           |       |                     |                       |            |           |           |
| Plan Notes  |            |              |                   |                          |             |                    |   |                                |            |                       |           |       |                     |                       |            |           |           |
| Plan Notes  |            |              |                   |                          |             |                    |   |                                |            |                       |           |       |                     |                       |            |           |           |
| Plan Notes  |            |              |                   |                          |             |                    |   |                                |            |                       |           |       |                     |                       |            |           |           |
| GIS ID M_282515_789851  |            |              |                   |                          |             | Total              |   | 4,827,300                      | 4,827,300  |                       |           |       |                     |                       |            |           |           |
| RECORD OF OWNERSHIP   |            | BK-VOL/PAGE  | SALE DATE         | Q/U                      | V/I         | SALE PRICE         | VC  | PREVIOUS ASSESSMENTS (HISTORY) |            |                       |           |       |                     |                       |            |           |           |
| FARNSWORTH PETER J &<br>KATAMA SOUTH HOLDINGS LLC   |            | 0078<br>0077 | 0149<br>0210      | 10-17-2017<br>12-21-2016 | Q<br>U      | I<br>I             | 1,525,000<br>1,300,000  | 00<br>1                        | Year       | Code                  | Assessed  | Year  | Code                | Assessed              |            |           |           |
| BINDER RICHARD S  |            | 0064         | 0091              | 08-29-2005               | U           | I                  | 1   | 1                              | 2023       | 1090                  | 3,093,900 | 2022  | 1090                | 908,500               |            |           |           |
| BINDER RICHARD S  |            | 00028        | 0049              | 01-06-1981               | Q           | V                  | 34,500  | 00                             |            | 1090                  | 1,123,100 |       | 1090                | 1,123,100             |            |           |           |
| VINEYARD OPEN LAND FDN  |            | 00025        | 0245              | 09-01-1979               |             |                    | 0   |                                |            |                       |           |       | 2021                | 1090                  | 409,900    |           |           |
|   |            |              |                   |                          |             |                    |   |                                |            |                       |           |       |                     | 1090                  | 983,200    |           |           |
|   |            |              |                   |                          |             |                    |   |                                | Total      |                       | 4,217,000 | Total |                     | 2,031,600             | Total      |           | 1,393,100 |
| EXEMPTIONS  |            |              | OTHER ASSESSMENTS |                          |             |                    | This signature acknowledges a visit by a Data Collector or Assessor |                                |            |                       |           |       |                     |                       |            |           |           |
| Year  | Code       | Description  | Amount            | Code                     | Description | Number             | Amount  | Comm Int                       |            |                       |           |       |                     |                       |            |           |           |
|   |            |              |                   |                          |             |                    |   |                                |            |                       |           |       |                     |                       |            |           |           |
|   |            |              |                   |                          |             |                    |   |                                |            |                       |           |       |                     |                       |            |           |           |
|   |            |              |                   |                          |             |                    |   |                                |            |                       |           |       |                     |                       |            |           |           |
|   |            |              | 0.00              |                          |             |                    |   |                                |            |                       |           |       |                     |                       |            |           |           |
| ASSESSING NEIGHBORHOOD  |            |              |                   |                          |             |                    |   |                                |            |                       |           |       |                     |                       |            |           |           |
| Nbhd  |            | Nbhd Name    |                   | B                        |             | Tracing            |   | Batch                          |            |                       |           |       |                     |                       |            |           |           |
| 0060  |            |              |                   |                          |             |                    |   |                                |            |                       |           |       |                     |                       |            |           |           |
| NOTES   |            |              |                   |                          |             |                    |   |                                |            |                       |           |       |                     |                       |            |           |           |
| Katama farm view.. drive past GH to Main house  |            |              |                   |                          |             |                    |   |                                |            |                       |           |       |                     |                       |            |           |           |
| BUILDING PERMIT RECORD  |            |              |                   |                          |             |                    |   |                                |            |                       |           |       |                     |                       |            |           |           |
| Permit Id   | Issue Date | Type         | Description       | Amount                   | Insp Date   | % Comp             | Date Comp   | Comments                       | Date       | Id                    | Type      | Is    | Cd                  | Purpost/Result        |            |           |           |
| 2023-654  | 05-22-2023 | SOLR         | Solar Panels      |                          |             | 0                  |   |                                | 03-06-2023 | EH                    |           |       | 01                  | Cyclical Reinspection |            |           |           |
| 2022-812  | 06-06-2022 | RN           | Res New Cons      | 60,000                   |             | 0                  |   | BUILD 50X45 TENNIS COUR        | 05-23-2022 | LS                    |           |       | 11                  | Field Review          |            |           |           |
| 2022-811  | 06-06-2022 | RN           | Res New Cons      | 28,000                   |             | 0                  |   | BUILD 16X26 BARN               | 07-13-2021 | EH                    |           | 6     | 00                  | Measur+Listed         |            |           |           |
| 2022-810  | 06-06-2022 | RN           | Res New Cons      | 120,000                  |             | 0                  |   | BUILD 384 SQ POOL HOUSE        | 07-09-2020 | EP                    |           |       | 01                  | Cyclical Reinspection |            |           |           |
| 462-2019  | 05-14-2021 | CO           | CO ISSUED         |                          |             | 100                |   |                                | 05-24-2017 | PH                    |           |       | 11                  | Field Review          |            |           |           |
| 2019-464  | 02-18-2019 | RN           | Res New Cons      |                          |             | 0                  |   | FENCE AND POOL                 | 06-17-2014 | SER                   |           |       | 11                  | Field Review          |            |           |           |
| 2019-463  | 02-18-2019 | RN           | Res New Cons      | 100,000                  |             | 0                  |   | POOL HOUSE                     | 05-30-2012 | EP                    |           |       | 11                  | Field Review          |            |           |           |
| LAND LINE VALUATION SECTION   |            |              |                   |                          |             |                    |   |                                |            |                       |           |       |                     |                       |            |           |           |
| B   | Use Code   | Description  | Zone              | Land Type                | Land Units  | Unit Price         | Size Adj  | Site Index                     | Cond.      | Nbhd.                 | Nbhd. Adj | Notes | Location Adjustment | Adj Unit P            | Land Value |           |           |
| 1   | 1090       | MULTI HSES   | R60               |                          | 66,211 SF   | 6.47               | 1.00000   | 6                              | 1.00       | 0060                  | 2.600     | VIEW  |                     | 16.83                 | 1,114,600  |           |           |
| Total Card Land Units   |            |              |                   |                          | 1.52        | AC                 | Parcel Total Land Area  |                                |            |                       |           | 1.52  | Total Land Value    |                       |            | 1,114,600 |           |

| CONSTRUCTION DETAIL      |      |                | CONSTRUCTION DETAIL (CONTINUED) |     |             |
|--------------------------|------|----------------|---------------------------------|-----|-------------|
| Element                  | Cd   | Description    | Element                         | Cd  | Description |
| Style:                   | 06   | Custom         |                                 |     |             |
| Model                    | 01   | Residential    |                                 |     |             |
| Grade:                   | 08   | Excellent      |                                 |     |             |
| Stories:                 | 2    | 2 Stories      |                                 |     |             |
| Occupancy                | 1    |                |                                 |     |             |
| Exterior Wall 1          | 12   | Cedar or Redwd |                                 |     |             |
| Exterior Wall 2          |      |                |                                 |     |             |
| Roof Structure:          | 03   | Gable/Hip      |                                 |     |             |
| Roof Cover               | 03   | Asph/F Gls/Cmp |                                 |     |             |
| Interior Wall 1          | 05   | Drywall/Sheet  |                                 |     |             |
| Interior Wall 2          | 06   | Cust Wd Panel  |                                 |     |             |
| Interior Flr 1           | 12   | Hardwood       |                                 |     |             |
| Interior Flr 2           | 14   | Carpet         |                                 |     |             |
| Heat Fuel                | 03   | Gas            |                                 |     |             |
| Heat Type:               | 04   | Forced Air-Duc |                                 |     |             |
| AC Type:                 | 02   | Heat Pump      |                                 |     |             |
| Total Bedrooms           | 04   | 4 Bedrooms     |                                 |     |             |
| Total Bthrms:            | 4    |                |                                 |     |             |
| Total Half Baths         | 2    |                |                                 |     |             |
| Total Xtra Fixtrs        |      |                |                                 |     |             |
| Total Rooms:             |      |                |                                 |     |             |
| Bath Style:              |      |                |                                 |     |             |
| Kitchen Style:           |      |                |                                 |     |             |
| CONDO DATA               |      |                |                                 |     |             |
| Parcel Id                |      | C              | Owne                            | 0.0 |             |
| Adjust Type              | Code | Description    | Factor%                         |     |             |
| Condo Flr                |      |                |                                 |     |             |
| Condo Unit               |      |                |                                 |     |             |
| COST / MARKET VALUATION  |      |                |                                 |     |             |
| Building Value New       |      |                | 2,918,324                       |     |             |
| Year Built               |      |                | 2020                            |     |             |
| Effective Year Built     |      |                | 2022                            |     |             |
| Depreciation Code        |      |                | A                               |     |             |
| Remodel Rating           |      |                |                                 |     |             |
| Year Remodeled           |      |                |                                 |     |             |
| Depreciation %           |      |                | 0                               |     |             |
| Functional Obsol         |      |                | 0                               |     |             |
| External Obsol           |      |                | 0                               |     |             |
| Trend Factor             |      |                | 1                               |     |             |
| Condition                |      |                |                                 |     |             |
| Condition %              |      |                |                                 |     |             |
| Percent Good             |      |                | 100                             |     |             |
| Cns Sect Rcnld           |      |                | 2,918,300                       |     |             |
| Dep % Ovr                |      |                |                                 |     |             |
| Dep Ovr Comment          |      |                |                                 |     |             |
| Misc Imp Ovr             |      |                |                                 |     |             |
| Misc Imp Ovr Comment     |      |                |                                 |     |             |
| Cost to Cure Ovr         |      |                |                                 |     |             |
| Cost to Cure Ovr Comment |      |                |                                 |     |             |

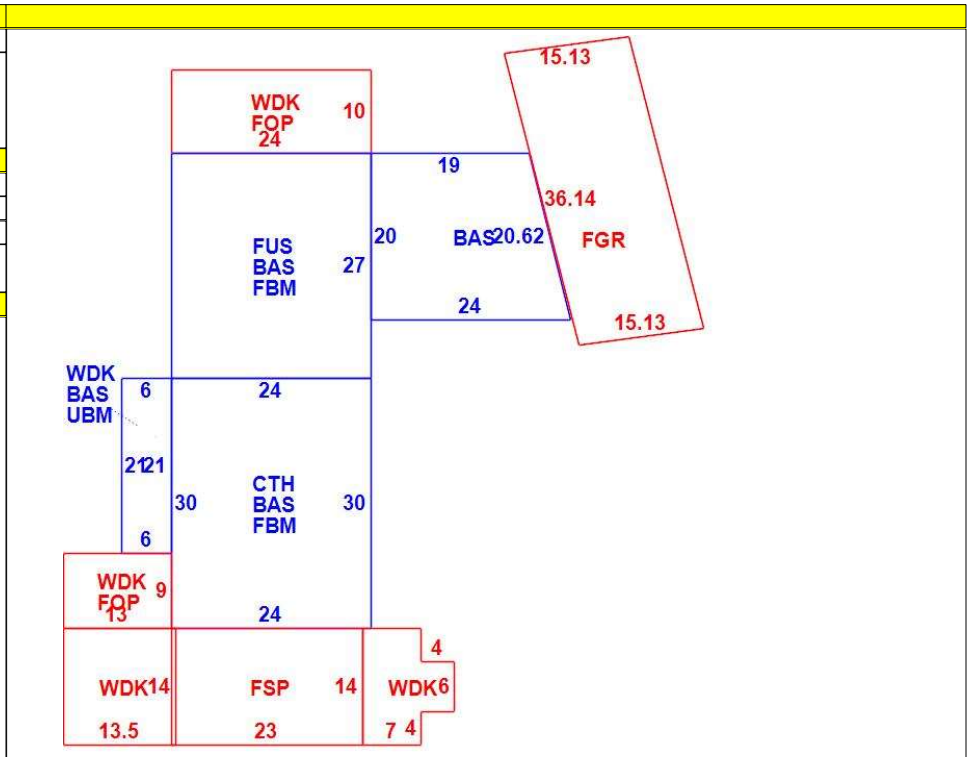

| OB - OUTBUILDING & YARD ITEMS(L) / XF - BUILDING EXTRA FEATURES(B) |             |     |       |            |        |          |      |       |            |             |
|--|-------------|-----|-------|------------|--------|----------|------|-------|------------|-------------|
| Code   | Description | L/B | Units | Unit Price | Yr Blt | Cond. Cd | % Gd | Grade | Grade Adj. | Appr. Value |
| FPL  | MTL-WD C/PI | B   | 1     | 2000.00    | 2001   |          | 100  |       | 0.00       | 2,000       |
| ODS  | OUTDOOR S   | L   | 1     | 700.00     |        |          | 100  |       | 0.00       | 700         |
| SPL1   | POOL-INGR C | L   | 840   | 80.00      | 2020   |          | 100  |       | 0.00       | 67,200      |
| SPA1   | SPA INGR W  | L   | 1     | 4000.00    | 2020   |          | 100  |       | 0.00       | 4,000       |

| BUILDING SUB-AREA SUMMARY SECTION |                         |             |            |          |           |                |
|-----------------------------------|-------------------------|-------------|------------|----------|-----------|----------------|
| Code                              | Description             | Living Area | Floor Area | Eff Area | Unit Cost | Undeprec Value |
| BAS                               | First Floor             | 1,924       | 1,924      | 1,924    | 780.45    | 1,501,586      |
| CTH                               | Cath Cing               | 0           | 720        | 36       | 39.02     | 28,096         |
| FBM                               | Basement, Finished      | 0           | 1,368      | 616      | 351.43    | 480,757        |
| FGR                               | Garage                  | 0           | 543        | 217      | 311.89    | 169,358        |
| FOP                               | Porch, Open, Finished   | 0           | 357        | 71       | 155.22    | 55,412         |
| FSP                               | Porch, Screen, Finished | 0           | 322        | 81       | 196.32    | 63,216         |
| FUS                               | Upper Story, Finished   | 648         | 648        | 648      | 780.45    | 505,732        |
| UBM                               | Basement, Unfinished    | 0           | 126        | 25       | 154.85    | 19,511         |
| WDK                               | Deck, Wood              | 0           | 794        | 79       | 77.65     | 61,656         |
| Ttl Gross Liv / Lease Area        |                         | 2,572       | 6,802      | 3,697    |           | 2,885,324      |



| CURRENT OWNER   |            | TOPO         | UTILITIES         | STRT / ROAD              | LOCATION    | CURRENT ASSESSMENT |   |                                |            | 1302<br>EDGARTOWN, MA |                  |           |                     |                       |            |
|---|------------|--------------|-------------------|--------------------------|-------------|--------------------|---|--------------------------------|------------|-----------------------|------------------|-----------|---------------------|-----------------------|------------|
| FARNSWORTH PETER J &<br>STONE RANDI L<br>101 WEST 81ST ST<br>APT 516<br>NEW YORK NY 10024 |            |              |                   |                          |             | Description        | Code  | Appraised                      | Assessed   |                       |                  |           |                     |                       |            |
|   |            |              |                   |                          |             | RESIDENTL          | 1090  | 3,712,700                      | 3,712,700  | <b>VISION</b>         |                  |           |                     |                       |            |
|   |            |              |                   |                          |             | RES LND            | 1090  | 1,114,600                      | 1,114,600  |                       |                  |           |                     |                       |            |
| SUPPLEMENTAL DATA   |            |              |                   |                          |             |                    |   |                                |            |                       |                  |           |                     |                       |            |
| Alt Prcl ID   |            | Restriction  |                   | Hist Distrct             |             |                    |   |                                |            |                       |                  |           |                     |                       |            |
| PLN#/Rec LC 8761-67 &68   |            | Other Note   |                   | UC-Misc 1 NS 2019 BP'S   |             |                    |   |                                |            |                       |                  |           |                     |                       |            |
| Lot# 1009 & 1010  |            | UC-Misc 2    |                   | Assoc Pid#               |             |                    |   |                                |            |                       |                  |           |                     |                       |            |
| Plan Notes  |            |              |                   |                          |             |                    |   |                                |            |                       |                  |           |                     |                       |            |
| Plan Notes  |            |              |                   |                          |             |                    |   |                                |            |                       |                  |           |                     |                       |            |
| Plan Notes  |            |              |                   |                          |             |                    |   |                                |            |                       |                  |           |                     |                       |            |
| GIS ID M_282515_789851  |            |              |                   |                          |             | Total              |   | 4,827,300                      | 4,827,300  |                       |                  |           |                     |                       |            |
| RECORD OF OWNERSHIP   |            | BK-VOL/PAGE  | SALE DATE         | Q/U                      | V/I         | SALE PRICE         | VC  | PREVIOUS ASSESSMENTS (HISTORY) |            |                       |                  |           |                     |                       |            |
| FARNSWORTH PETER J &<br>KATAMA SOUTH HOLDINGS LLC   |            | 0078<br>0077 | 0149<br>0210      | 10-17-2017<br>12-21-2016 | Q<br>U      | I<br>I             | 1,525,000<br>1,300,000  | 00<br>1                        | Year       | Code                  | Assessed         | Year      | Code                | Assessed              |            |
| BINDER RICHARD S  |            | 0064         | 0091              | 08-29-2005               | U           | I                  | 1   | 1                              | 2023       | 1090                  | 3,093,900        | 2022      | 1090                | 908,500               |            |
| BINDER RICHARD S  |            | 00028        | 0049              | 01-06-1981               | Q           | V                  | 34,500  | 00                             |            | 1090                  | 1,123,100        |           | 1090                | 1,123,100             |            |
| VINEYARD OPEN LAND FDN  |            | 00025        | 0245              | 09-01-1979               |             |                    | 0   |                                |            |                       |                  |           | 1090                | 983,200               |            |
|   |            |              |                   |                          |             |                    |   |                                | Total      | 4,217,000             | Total            | 2,031,600 | Total               | 1,393,100             |            |
| EXEMPTIONS  |            |              | OTHER ASSESSMENTS |                          |             |                    | This signature acknowledges a visit by a Data Collector or Assessor |                                |            |                       |                  |           |                     |                       |            |
| Year  | Code       | Description  | Amount            | Code                     | Description | Number             | Amount  | Comm Int                       |            |                       |                  |           |                     |                       |            |
|   |            |              |                   |                          |             |                    |   |                                |            |                       |                  |           |                     |                       |            |
| Total   |            |              | 0.00              |                          |             |                    |   |                                |            |                       |                  |           |                     |                       |            |
| ASSESSING NEIGHBORHOOD  |            |              |                   |                          |             |                    |   |                                |            |                       |                  |           |                     |                       |            |
| Nbhd  |            | Nbhd Name    |                   | B                        |             | Tracing            |   | Batch                          |            |                       |                  |           |                     |                       |            |
| 0060  |            |              |                   |                          |             |                    |   |                                |            |                       |                  |           |                     |                       |            |
| NOTES   |            |              |                   |                          |             |                    |   |                                |            |                       |                  |           |                     |                       |            |
| 1 & 2/2 demoed Jan'20<br>drive past GH to main house                                      |            |              |                   |                          |             |                    |   |                                |            |                       |                  |           |                     |                       |            |
| BUILDING PERMIT RECORD  |            |              |                   |                          |             |                    |   | VISIT / CHANGE HISTORY         |            |                       |                  |           |                     |                       |            |
| Permit Id   | Issue Date | Type         | Description       | Amount                   | Insp Date   | % Comp             | Date Comp   | Comments                       | Date       | Id                    | Type             | Is        | Cd                  | Purpost/Result        |            |
|   |            |              |                   |                          |             |                    |   |                                | 02-14-2022 | EH                    |                  |           | 01                  | Cyclical Reinspection |            |
| LAND LINE VALUATION SECTION   |            |              |                   |                          |             |                    |   |                                |            |                       |                  |           |                     |                       |            |
| B   | Use Code   | Description  | Zone              | Land Type                | Land Units  | Unit Price         | Size Adj  | Site Index                     | Cond.      | Nbhd.                 | Nbhd. Adj        | Notes     | Location Adjustment | Adj Unit P            | Land Value |
| 2   | 1090       | MULTI HSES   | R60               |                          | 0 SF        | 57.18              | 1.00000   | 6                              | 1.00       | 0060                  | 2.600            |           |                     | 148.67                | 0          |
| Total Card Land Units   |            |              |                   |                          | 0.00        | AC                 | Parcel Total Land Area  |                                |            | 1.52                  | Total Land Value |           |                     |                       | 0          |

| CONSTRUCTION DETAIL            |      |                | CONSTRUCTION DETAIL (CONTINUED) |         |             |
|--------------------------------|------|----------------|---------------------------------|---------|-------------|
| Element                        | Cd   | Description    | Element                         | Cd      | Description |
| Style:                         | 07   | Standard Plus  |                                 |         |             |
| Model                          | 01   | Residential    |                                 |         |             |
| Grade:                         | 06   | Good           |                                 |         |             |
| Stories:                       | 2    | 2 Stories      |                                 |         |             |
| Occupancy                      | 1    |                |                                 |         |             |
| Exterior Wall 1                | 12   | Cedar or Redwd |                                 |         |             |
| Exterior Wall 2                |      |                |                                 |         |             |
| Roof Structure:                | 03   | Gable/Hip      |                                 |         |             |
| Roof Cover                     | 03   | Asph/F Gls/Cmp |                                 |         |             |
| Interior Wall 1                | 05   | Drywall/Sheet  |                                 |         |             |
| Interior Wall 2                | 06   | Cust Wd Panel  |                                 |         |             |
| Interior Flr 1                 | 12   | Hardwood       |                                 |         |             |
| Interior Flr 2                 | 14   | Carpet         |                                 |         |             |
| Heat Fuel                      | 03   | Gas            |                                 |         |             |
| Heat Type:                     | 03   | Hot Air-no Duc |                                 |         |             |
| AC Type:                       | 02   | Heat Pump      |                                 |         |             |
| Total Bedrooms                 | 01   | 1 Bedroom      |                                 |         |             |
| Total Bthrms:                  | 1    |                |                                 |         |             |
| Total Half Baths               | 0    |                |                                 |         |             |
| Total Xtra Fixtrs              |      |                |                                 |         |             |
| Total Rooms:                   |      |                |                                 |         |             |
| Bath Style:                    |      |                |                                 |         |             |
| Kitchen Style:                 |      |                |                                 |         |             |
|                                |      |                |                                 |         |             |
| <b>CONDO DATA</b>              |      |                |                                 |         |             |
| Parcel Id                      |      |                | C                               | Owne    | 0.0         |
|                                |      |                | B                               | S       |             |
| Adjust Type                    | Code | Description    | Factor%                         |         |             |
| Condo Flr                      |      |                |                                 |         |             |
| Condo Unit                     |      |                |                                 |         |             |
| <b>COST / MARKET VALUATION</b> |      |                |                                 |         |             |
| Building Value New             |      |                |                                 | 716,340 |             |
| Year Built                     |      |                |                                 | 2020    |             |
| Effective Year Built           |      |                |                                 | 2022    |             |
| Depreciation Code              |      |                |                                 | A       |             |
| Remodel Rating                 |      |                |                                 |         |             |
| Year Remodeled                 |      |                |                                 |         |             |
| Depreciation %                 |      |                |                                 | 0       |             |
| Functional Obsol               |      |                |                                 | 0       |             |
| External Obsol                 |      |                |                                 | 0       |             |
| Trend Factor                   |      |                |                                 | 1       |             |
| Condition                      |      |                |                                 |         |             |
| Condition %                    |      |                |                                 |         |             |
| Percent Good                   |      |                |                                 | 100     |             |
| Cns Sect Rcnd                  |      |                |                                 | 716,300 |             |
| Dep % Ovr                      |      |                |                                 |         |             |
| Dep Ovr Comment                |      |                |                                 |         |             |
| Misc Imp Ovr                   |      |                |                                 |         |             |
| Misc Imp Ovr Comment           |      |                |                                 |         |             |
| Cost to Cure Ovr               |      |                |                                 |         |             |
| Cost to Cure Ovr Comment       |      |                |                                 |         |             |

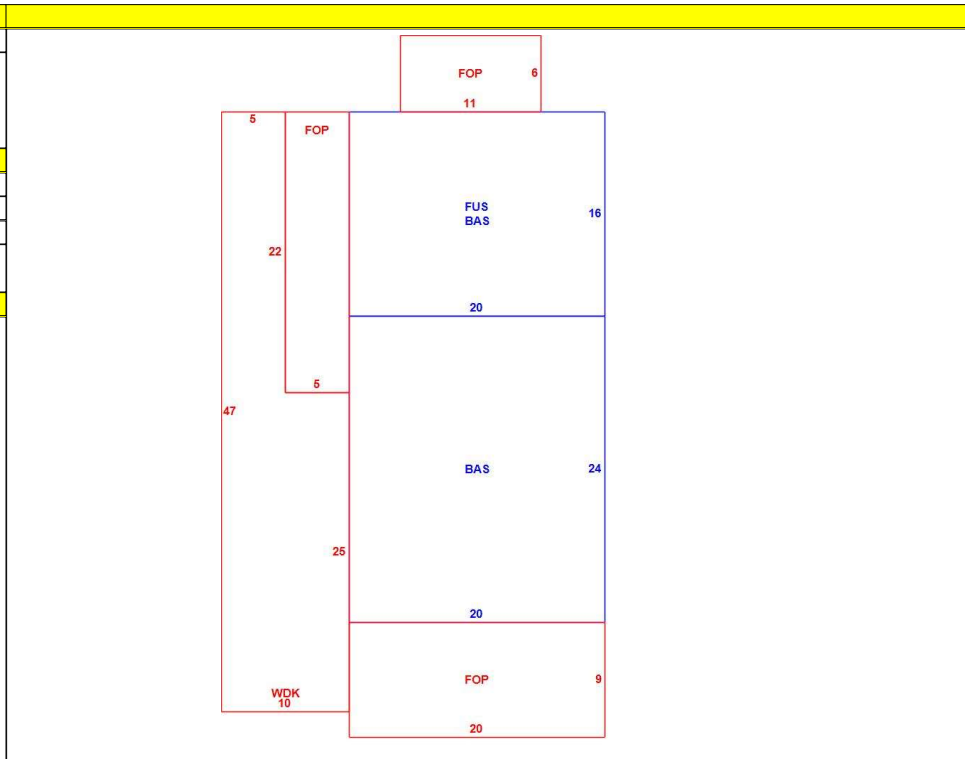

**OB - OUTBUILDING & YARD ITEMS(L) / XF - BUILDING EXTRA FEATURES(B)**

| Code | Description | L/B | Units | Unit Price | Yr Blt | Cond. Cd | % Gd | Grade | Grade Adj. | Appr. Value |
|------|-------------|-----|-------|------------|--------|----------|------|-------|------------|-------------|
| FPL2 | FPL MSNRY 1 | B   | 1     | 3500.00    | 2001   |          | 100  |       | 0.00       | 3,500       |
| ODS  | OUTDOOR S   | L   | 1     | 700.00     |        |          | 100  |       | 0.00       | 700         |

**BUILDING SUB-AREA SUMMARY SECTION**

| Code                       | Description           | Living Area | Floor Area | Eff Area | Unit Cost | Undeprec Value |
|----------------------------|-----------------------|-------------|------------|----------|-----------|----------------|
| BAS                        | First Floor           | 800         | 800        | 800      | 583.81    | 467,051        |
| FOP                        | Porch, Open, Finished | 0           | 356        | 71       | 116.43    | 41,451         |
| FUS                        | Upper Story, Finished | 320         | 320        | 320      | 583.81    | 186,820        |
| WDK                        | Deck, Wood            | 0           | 360        | 36       | 58.38     | 21,017         |
| Ttl Gross Liv / Lease Area |                       | 1,120       | 1,836      | 1,227    |           | 716,339        |

