

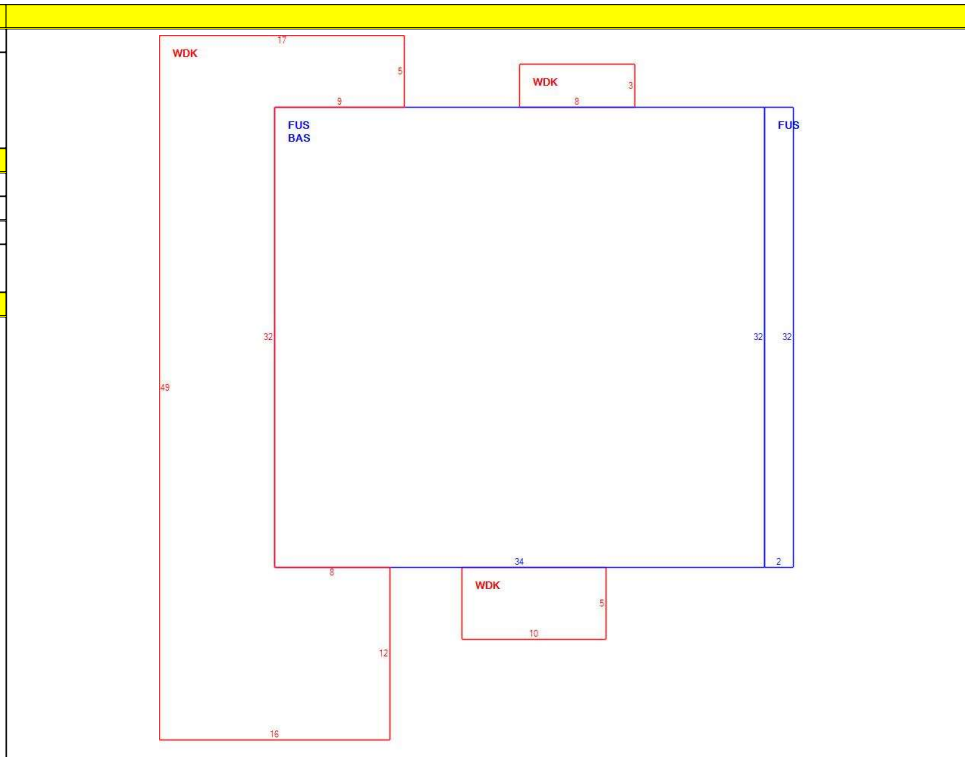

CONSTRUCTION DETAIL			CONSTRUCTION DETAIL (CONTINUED)		
Element	Cd	Description	Element	Cd	Description
Style:	10	Standard Basic			
Model	01	Residential			
Grade:	05	Average +20			
Stories:	2	2 Stories			
Occupancy	1				
Exterior Wall 1	14	Wood Shingle			
Exterior Wall 2					
Roof Structure:	03	Gable/Hip			
Roof Cover	03	Asph/F Gls/Cmp			
Interior Wall 1	05	Drywall/Sheet			
Interior Wall 2					
Interior Flr 1	14	Carpet			
Interior Flr 2					
Heat Fuel	04	Electric			
Heat Type:	07	Electr Basebrd			
AC Type:	02	Heat Pump			
Total Bedrooms	04	4 Bedrooms			
Total Bthrms:	2				
Total Half Baths	0				
Total Xtra Fixtrs					
Total Rooms:					
Bath Style:					
Kitchen Style:					
			<b>CONDO DATA</b>		
			Parcel Id	C	Ownr 0.0
				B	S
			Adjust Type	Code	Description
			Condo Flr		
			Condo Unit		
			<b>COST / MARKET VALUATION</b>		
			Building Value New		282,700
			Year Built		1988
			Effective Year Built		2007
			Depreciation Code		A
			Remodel Rating		
			Year Remodeled		
			Depreciation %		15
			Functional Obsol		0
			External Obsol		0
			Trend Factor		1
			Condition		
			Condition %		
			Percent Good		85
			Cns Sect Rcnd		240,300
			Dep % Ovr		
			Dep Ovr Comment		
			Misc Imp Ovr		
			Misc Imp Ovr Comment		
			Cost to Cure Ovr		
			Cost to Cure Ovr Comment		



OB - OUTBUILDING & YARD ITEMS(L) / XF - BUILDING EXTRA FEATURES(B)										
Code	Description	L/B	Units	Unit Price	Yr Blt	Cond. Cd	% Gd	Grade	Grade Adj.	Appr. Value
ODP	OUTDOOR PL	L	1	700.00			100		0.00	700

BUILDING SUB-AREA SUMMARY SECTION						
Code	Description	Living Area	Floor Area	Eff Area	Unit Cost	Undeprec Value
BAS	First Floor	1,088	1,088	1,088	120.25	130,834
FUS	Upper Story, Finished	1,152	1,152	1,152	120.25	138,530
WDK	Deck, Wood	0	607	61	12.08	7,335
Ttl Gross Liv / Lease Area		2,240	2,847	2,301		276,699

