

| CURRENT OWNER | | TOPO | UTILITIES | STRT / ROAD | LOCATION | CURRENT ASSESSMENT | | | | 1302 EDGARTOWN, MA | | | | | |
|-----------------------------------|------------|---------------|---------------|-------------------|-------------|------------------------|------------|---|--------------------------------------|-----------------------|-----------|------------------|---------------------|-----------------------|------------|
| BRANDON PHILIP R | | | | | | Description | Code | Appraised | Assessed | | | | | | |
| PO BOX 2700 | | | | | | RESIDENTL | 1010 | 403,900 | 403,900 | VISION | | | | | |
| BAKERSFIELD CA 93305 | | | | | | RES LND | 1010 | 312,100 | 312,100 | | | | | | |
| SUPPLEMENTAL DATA | | | | | | Total | | 716,000 | 716,000 | | | | | | |
| Alt Prcl ID | | Restriction | | Hist Distrct | | Other Note | | | | | | | | | |
| PLN#/Rec | | UC-Misc 1 | | UC-Misc 2 | | | | | | | | | | | |
| Lot# | | Assoc Pid# | | | | | | | | | | | | | |
| Plan Notes | | | | | | | | | | | | | | | |
| Plan Notes | | | | | | | | | | | | | | | |
| Plan Notes | | | | | | | | | | | | | | | |
| GIS ID M_278620_795441 | | | | | | | | | | | | | | | |
| RECORD OF OWNERSHIP | | | BK-VOL/PAGE | SALE DATE | Q/U | V/I | SALE PRICE | VC | PREVIOUS ASSESSMENTS (HISTORY) | | | | | | |
| BRANDON PHILIP R | | | 1478 0774 | 10-11-2018 | Q | I | 525,000 | 00 | Year | Code | Assessed | Year | Code | Assessed | |
| SMITH DONALD M & ELIZABETH A--TRS | | | 1283 0529 | 06-15-2012 | U | I | 1 | 1A | 2023 | 1010 | 380,200 | 2022 | 1010 | 270,200 | |
| SMITH DONALD M & ELIZABETH A | | | 0293 0178 | 11-09-1971 | | | 0 | | | 1010 | 283,100 | 2021 | 1010 | 283,100 | |
| | | | | | | | | | Total | | 663,300 | Total | | 553,300 | |
| | | | | | | | | | Total | | 533,200 | Total | | 533,200 | |
| EXEMPTIONS | | | | OTHER ASSESSMENTS | | | | This signature acknowledges a visit by a Data Collector or Assessor | | | | | | | |
| Year | Code | Description | Amount | Code | Description | Number | Amount | Comm Int | | | | | | | |
| | | | | | | | | | | | | | | | |
| Total | | | 0.00 | | | | | | | | | | | | |
| ASSESSING NEIGHBORHOOD | | | | | | | | APPRAISED VALUE SUMMARY | | | | | | | |
| Nbhd | Nbhd Name | B | Tracing | Batch | | | | | Appraised Bldg. Value (Card) 401,700 | | | | | | |
| 0040 | | | | | | | | | Appraised Xf (B) Value (Bldg) 1,500 | | | | | | |
| | | | | | | | | Appraised Ob (B) Value (Bldg) 700 | | | | | | | |
| | | | | | | | | Appraised Land Value (Bldg) 312,100 | | | | | | | |
| | | | | | | | | Special Land Value 0 | | | | | | | |
| | | | | | | | | Total Appraised Parcel Value 716,000 | | | | | | | |
| | | | | | | | | Valuation Method C | | | | | | | |
| | | | | | | | | Total Appraised Parcel Value 716,000 | | | | | | | |
| BUILDING PERMIT RECORD | | | | | | | | VISIT / CHANGE HISTORY | | | | | | | |
| Permit Id | Issue Date | Type | Description | Amount | Insp Date | % Comp | Date Comp | Comments | Date | Id | Type | Is | Cd | Purpost/Result | |
| 2014-476 | 05-24-2014 | RA | Res Add/Alter | | | | | MIN ALTS | 05-26-2022 | DM | | | 11 | Field Review | |
| | | | | | | | | | 11-29-2018 | EP | | | 01 | Cyclical Reinspection | |
| | | | | | | | | | 05-23-2017 | AU | | | 11 | Field Review | |
| | | | | | | | | | 03-27-2015 | EP | | | 01 | Cyclical Reinspection | |
| | | | | | | | | | 11-14-2011 | RK | | | 11 | Field Review | |
| | | | | | | | | | 10-01-2004 | EP | | | 51 | Cyclical Reinspection | |
| | | | | | | | | | 08-04-2000 | WP | | | 43 | Cyclical Reinspection | |
| LAND LINE VALUATION SECTION | | | | | | | | | | | | | | | |
| B | Use Code | Description | Zone | Land Type | Land Units | Unit Price | Size Adj | Site Index | Cond. | Nbhd. | Nbhd. Adj | Notes | Location Adjustment | Adj Unit P | Land Value |
| 1 | 1010 | SINGL FAM M-0 | R20 | | 9,666 SF | 30.75 | 1.00000 | 4 | 1.00 | 0040 | 1.050 | | | 32.29 | 312,100 |
| Total Card Land Units | | | | | 0.22 AC | Parcel Total Land Area | | | | | 0.22 | Total Land Value | | | 312,100 |

| CONSTRUCTION DETAIL | | | CONSTRUCTION DETAIL (CONTINUED) | | |
|--------------------------------|------|----------------|---------------------------------|-----|-------------|
| Element | Cd | Description | Element | Cd | Description |
| Style: | 04 | Cape Cod | | | |
| Model | 01 | Residential | | | |
| Grade: | 03 | Average | | | |
| Stories: | 1.5 | 1 1/2 Stories | | | |
| Occupancy | 1 | | | | |
| Exterior Wall 1 | 14 | Wood Shingle | | | |
| Exterior Wall 2 | | | | | |
| Roof Structure: | 03 | Gable/Hip | | | |
| Roof Cover | 03 | Asph/F Gls/Cmp | | | |
| Interior Wall 1 | 05 | Drywall/Sheet | | | |
| Interior Wall 2 | | | | | |
| Interior Flr 1 | 14 | Carpet | | | |
| Interior Flr 2 | 09 | Pine/Soft Wood | | | |
| Heat Fuel | 04 | Electric | | | |
| Heat Type: | 04 | Forced Air-Duc | | | |
| AC Type: | 02 | Heat Pump | | | |
| Total Bedrooms | 03 | 3 Bedrooms | | | |
| Total Bthrms: | 1 | | | | |
| Total Half Baths | 0 | | | | |
| Total Xtra Fixtrs | | | | | |
| Total Rooms: | 5 | | | | |
| Bath Style: | 02 | Average | | | |
| Kitchen Style: | 02 | Modern | | | |
| CONDO DATA | | | | | |
| Parcel Id | | C | Owne | 0.0 | |
| Adjust Type | Code | Description | Factor% | | |
| Condo Flr | | | | | |
| Condo Unit | | | | | |
| COST / MARKET VALUATION | | | | | |
| Building Value New | | 535,553 | | | |
| Year Built | | 1975 | | | |
| Effective Year Built | | 1997 | | | |
| Depreciation Code | | A | | | |
| Remodel Rating | | | | | |
| Year Remodeled | | | | | |
| Depreciation % | | 25 | | | |
| Functional Obsol | | 0 | | | |
| External Obsol | | 0 | | | |
| Trend Factor | | 1 | | | |
| Condition | | | | | |
| Condition % | | | | | |
| Percent Good | | 75 | | | |
| Cns Sect Rcnld | | 401,700 | | | |
| Dep % Ovr | | | | | |
| Dep Ovr Comment | | | | | |
| Misc Imp Ovr | | | | | |
| Misc Imp Ovr Comment | | | | | |
| Cost to Cure Ovr | | | | | |
| Cost to Cure Ovr Comment | | | | | |

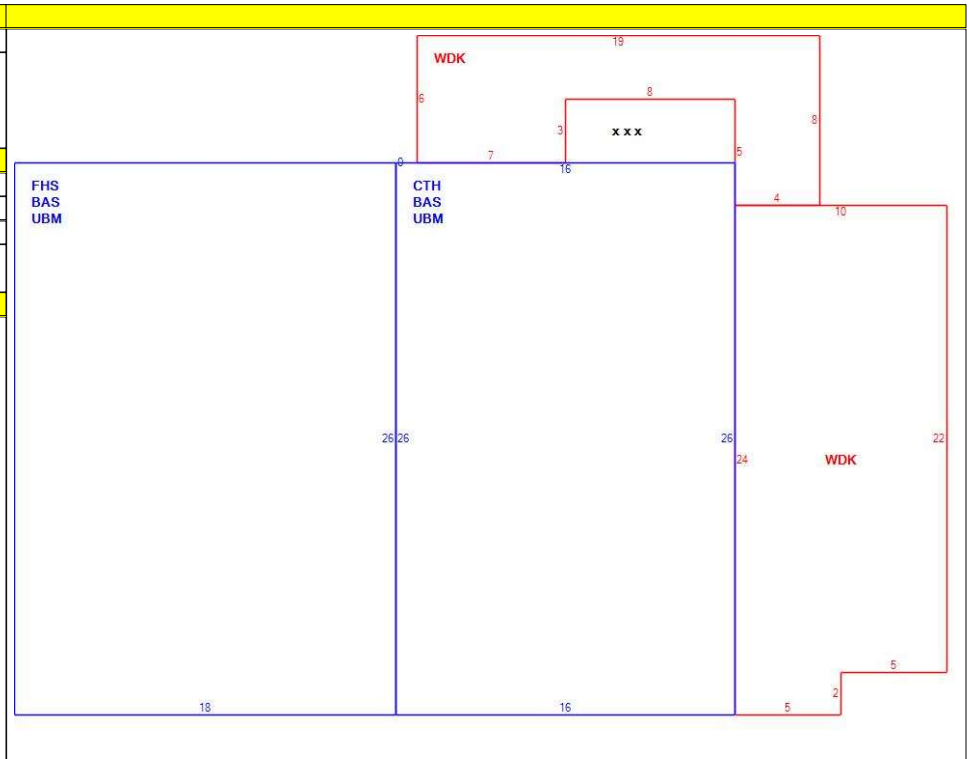

| OB - OUTBUILDING & YARD ITEMS(L) / XF - BUILDING EXTRA FEATURES(B) | | | | | | | | | | |
|--|-------------|-----|-------|------------|--------|----------|------|-------|------------|-------------|
| Code | Description | L/B | Units | Unit Price | Yr Blt | Cond. Cd | % Gd | Grade | Grade Adj. | Appr. Value |
| ODS | OUTDOOR S | L | 1 | 700.00 | 2014 | | 100 | | 0.00 | 700 |
| FPL | MTL-WD C/PI | B | 1 | 2000.00 | 2001 | | 75 | | 0.00 | 1,500 |

| BUILDING SUB-AREA SUMMARY SECTION | | | | | | |
|-----------------------------------|----------------------|-------------|------------|----------|-----------|----------------|
| Code | Description | Living Area | Floor Area | Eff Area | Unit Cost | Undeprec Value |
| BAS | First Floor | 884 | 884 | 884 | 397.00 | 350,948 |
| CTH | Cath Cing | 0 | 416 | 21 | 20.04 | 8,337 |
| FHS | Half Story, Finished | 234 | 468 | 234 | 198.50 | 92,898 |
| UBM | Basement, Unfinished | 0 | 884 | 177 | 79.49 | 70,269 |
| WDK | Deck, Wood | 0 | 328 | 33 | 39.94 | 13,101 |
| Ttl Gross Liv / Lease Area | | 1,118 | 2,980 | 1,349 | | 535,553 |

