

| CURRENT OWNER | | TOPO | UTILITIES | STRT / ROAD | LOCATION | CURRENT ASSESSMENT | | | | 1302 EDGARTOWN, MA VISION | | | | | | |
|--|------------|------------------------|-------------------|---------------|-------------|-------------------------|---|------------------|--------------------------------|--|-----------|--|---------------------|-----------------------|------------|---------|
| CUNNINGHAM ROSEMARY 51 PILGRIM RD EDGARTOWN MA 02539 | | | | 9 Town Street | | Description | Code | Appraised | Assessed | | | RESIDENTL 1010 543,900 543,900 RES LND 1010 330,000 330,000 | | | | |
| | | | | 1 Paved | | Total | | 873,900 | 873,900 | | | | | | | |
| SUPPLEMENTAL DATA | | | | | | | | | | | | | | | | |
| Alt Prcl ID | | PLN#/Rec | | Restriction | | | | | | | | | | | | |
| Lot# | | Plan Notes | | Hist Distrct | | | | | | | | | | | | |
| Plan Notes | | Plan Notes | | Other Note | | | | | | | | | | | | |
| Plan Notes | | GIS ID M_279151_795374 | | UC-Misc 1 | | | | | | | | | | | | |
| | | | | UC-Misc 2 | | | | | | | | | | | | |
| | | | | Assoc Pid# | | | | | | | | | | | | |
| RECORD OF OWNERSHIP | | | BK-VOL/PAGE | SALE DATE | Q/U | V/I | SALE PRICE | VC | PREVIOUS ASSESSMENTS (HISTORY) | | | | | | | |
| CUNNINGHAM ROSEMARY | | | 1361 1024 | 11-18-2014 | U | I | 1 | 1A | Year | Code | Assessed | Year | Code | Assessed | | |
| CUNNINGHAM ROSEMARY & TEIXEIRA ROBERT A & NEIRA NICOLE M | | | 0974 0953 | 10-20-2003 | Q | I | 510,000 | 00 | 2023 | 1010 | 533,000 | 2022 | 1010 | 418,600 | | |
| DICKEY WILLIAM & LAURIE A | | | 0767 0684 | 06-07-1999 | Q | I | 252,000 | 00 | | 1010 | 299,300 | 2021 | 1010 | 299,400 | | |
| | | | 0680 0559 | 07-01-1996 | Q | I | 165,000 | 00 | | | | | | | | |
| | | | 0653 0700 | 04-27-1995 | Q | V | 37,000 | 00 | | | | | | | | |
| | | | Total | | | | 832,300 | | Total | | 717,900 | Total | | 718,000 | | |
| EXEMPTIONS | | | OTHER ASSESSMENTS | | | | This signature acknowledges a visit by a Data Collector or Assessor | | | | | | | | | |
| Year | Code | Description | Amount | Code | Description | Number | Amount | Comm Int | | | | | | | | |
| | | | | | | | | | | | | | | | | |
| Total | | | 0.00 | | | | | | | | | | | | | |
| ASSESSING NEIGHBORHOOD | | | | | | APPRAISED VALUE SUMMARY | | | | | | | | | | |
| Nbhd | Nbhd Name | | B | Tracing | | Batch | | | | | | | | | | |
| 0040 | | | | | | | | | | | | | | | | |
| NOTES | | | | | | | | | | | | Appraised Bldg. Value (Card) | | 542,100 | | |
| LTS26-29 87 88 BLK L OH CONTIG | | | | | | | | | | | | Appraised Xf (B) Value (Bldg) | | 1,800 | | |
| | | | | | | | | | | | | Appraised Ob (B) Value (Bldg) | | 0 | | |
| | | | | | | | | | | | | Appraised Land Value (Bldg) | | 330,000 | | |
| | | | | | | | | | | | | Special Land Value | | 0 | | |
| | | | | | | | | | | | | Total Appraised Parcel Value | | 873,900 | | |
| | | | | | | | | | | | | Valuation Method | | C | | |
| | | | | | | | | | | | | Total Appraised Parcel Value | | 873,900 | | |
| BUILDING PERMIT RECORD | | | | | | VISIT / CHANGE HISTORY | | | | | | | | | | |
| Permit Id | Issue Date | Type | Description | Amount | Insp Date | % Comp | Date Comp | Comments | Date | Id | Type | Is | Cd | Purpost/Result | | |
| 2022-535 | 02-24-2022 | RA | Res Add/Alter | | | 0 | | REPLACE WINDOW | 04-12-2023 | EH | | | 01 | Cyclical Reinspection | | |
| 2012-147 | 11-16-2011 | RA | Res Add/Alter | | | | | MINOR ALTERATION | 08-24-2022 | EH | | 6 | 01 | Cyclical Reinspection | | |
| | | | | | | | | | 05-25-2022 | DM | | | 11 | Field Review | | |
| | | | | | | | | | 05-23-2017 | AU | | | 11 | Field Review | | |
| | | | | | | | | | 03-07-2012 | EP | | | 11 | Field Review | | |
| | | | | | | | | | 11-10-2011 | RK | | | 11 | Field Review | | |
| | | | | | | | | | 04-30-2004 | CR | | | 01 | Cyclical Reinspection | | |
| LAND LINE VALUATION SECTION | | | | | | | | | | | | | | | | |
| B | Use Code | Description | Zone | Land Type | Land Units | Unit Price | Size Adj | Site Index | Cond. | Nbhd. | Nbhd. Adj | Notes | Location Adjustment | Adj Unit P | Land Value | |
| 1 | 1010 | SINGL FAM M-0 | R20 | | 18,000 SF | 17.46 | 1.00000 | 4 | 1.00 | 0040 | 1.050 | | | 18.33 | 330,000 | |
| Total Card Land Units | | | | | 0.41 | AC | Parcel Total Land Area | | | | | 0.41 | Total Land Value | | | 330,000 |

| CONSTRUCTION DETAIL | | | CONSTRUCTION DETAIL (CONTINUED) | | |
|---------------------|----|----------------|---------------------------------|----|-------------|
| Element | Cd | Description | Element | Cd | Description |
| Style: | 03 | Colonial | | | |
| Model | 01 | Residential | | | |
| Grade: | 04 | Above Ave | | | |
| Stories: | 2 | 2 Stories | | | |
| Occupancy | 1 | | | | |
| Exterior Wall 1 | 14 | Wood Shingle | | | |
| Exterior Wall 2 | 11 | Clapboard | | | |
| Roof Structure: | 03 | Gable/Hip | | | |
| Roof Cover | 03 | Asph/F Gls/Cmp | | | |
| Interior Wall 1 | 05 | Drywall/Sheet | | | |
| Interior Wall 2 | | | | | |
| Interior Flr 1 | 14 | Carpet | | | |
| Interior Flr 2 | | | | | |
| Heat Fuel | 02 | Oil | | | |
| Heat Type: | 04 | Forced Air-Duc | | | |
| AC Type: | 02 | Heat Pump | | | |
| Total Bedrooms | 03 | 3 Bedrooms | | | |
| Total Bthrms: | 2 | | | | |
| Total Half Baths | 0 | | | | |
| Total Xtra Fixtrs | | | | | |
| Total Rooms: | 6 | 6 Rooms | | | |
| Bath Style: | 02 | Average | | | |
| Kitchen Style: | 02 | Modern | | | |

| CONDO DATA | | | |
|-------------|------|-------------|---------|
| Parcel Id | C | Ownr | 0.0 |
| Adjust Type | Code | Description | Factor% |
| Condo Flr | | | |
| Condo Unit | | | |

| COST / MARKET VALUATION | |
|--------------------------|---------|
| Building Value New | 602,321 |
| Year Built | 1995 |
| Effective Year Built | 2012 |
| Depreciation Code | G |
| Remodel Rating | |
| Year Remodeled | |
| Depreciation % | 10 |
| Functional Obsol | 0 |
| External Obsol | 0 |
| Trend Factor | 1 |
| Condition | |
| Condition % | |
| Percent Good | 90 |
| Cns Sect Rcnd | 542,100 |
| Dep % Ovr | |
| Dep Ovr Comment | |
| Misc Imp Ovr | |
| Misc Imp Ovr Comment | |
| Cost to Cure Ovr | |
| Cost to Cure Ovr Comment | |

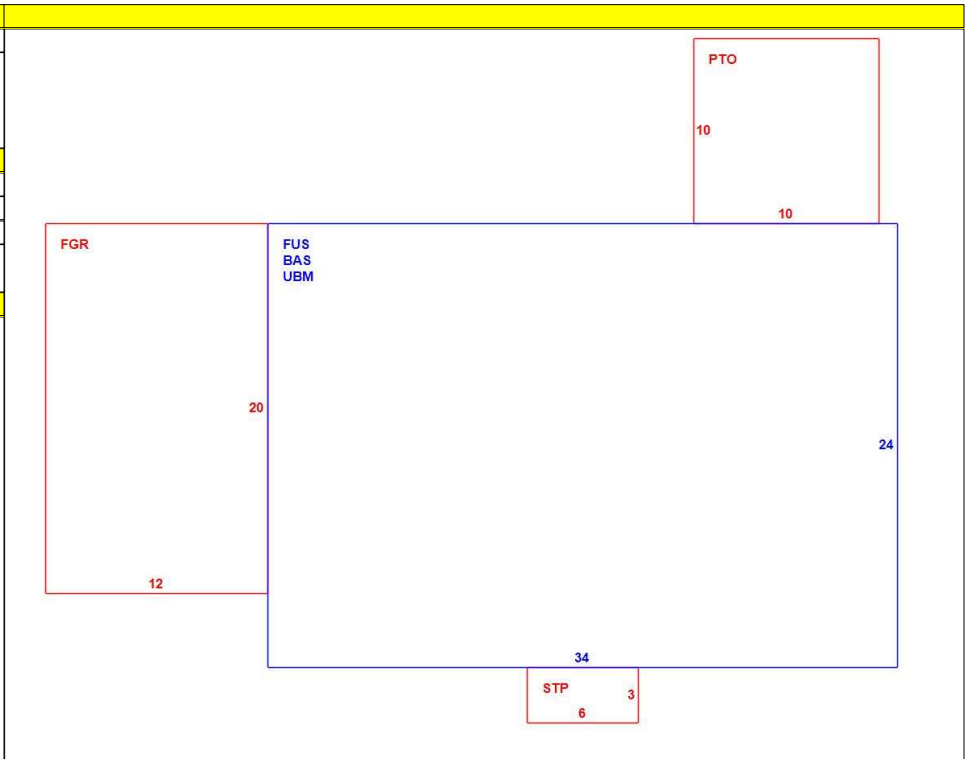

| OB - OUTBUILDING & YARD ITEMS(L) / XF - BUILDING EXTRA FEATURES(B) | | | | | | | | | | |
|--|-------------|-----|-------|------------|--------|----------|------|-------|------------|-------------|
| Code | Description | L/B | Units | Unit Price | Yr Blt | Cond. Cd | % Gd | Grade | Grade Adj. | Appr. Value |
| FPL | MTL-WD C/PI | B | 1 | 2000.00 | 2011 | | 90 | | 0.00 | 1,800 |

| BUILDING SUB-AREA SUMMARY SECTION | | | | | | |
|-----------------------------------|-----------------------|-------------|------------|----------|-----------|----------------|
| Code | Description | Living Area | Floor Area | Eff Area | Unit Cost | Undeprec Value |
| BAS | First Floor | 816 | 816 | 816 | 313.62 | 255,915 |
| FGR | Garage | 0 | 240 | 96 | 125.45 | 30,108 |
| FUS | Upper Story, Finished | 816 | 816 | 816 | 313.62 | 255,915 |
| PTO | Patio | 0 | 100 | 10 | 31.36 | 3,136 |
| STP | Stoop | 0 | 18 | 2 | 34.85 | 627 |
| UBM | Basement, Unfinished | 0 | 816 | 163 | 62.65 | 51,120 |
| Ttl Gross Liv / Lease Area | | 1,632 | 2,806 | 1,903 | | 596,821 |

