

| CURRENT OWNER               |            | TOPO          | UTILITIES     | STRT / ROAD       | LOCATION                      | CURRENT ASSESSMENT     |            |   |                                |       |           | 1302<br>EDGARTOWN, MA |                     |                          |            |      |          |
|-----------------------------|------------|---------------|---------------|-------------------|-------------------------------|------------------------|------------|---|--------------------------------|-------|-----------|-----------------------|---------------------|--------------------------|------------|------|----------|
| LENT MARINA                 |            |               |               |                   |                               | Description            | Code       | Appraised   | Assessed                       |       |           |                       |                     |                          |            |      |          |
| PO BOX 622                  |            |               |               |                   |                               | RESIDENTL              | 1010       | 613,600   | 613,600                        |       |           |                       |                     |                          |            |      |          |
| CHILMARK MA 02535           |            |               |               |                   |                               | RES LND                | 1010       | 317,300   | 317,300                        |       |           |                       |                     |                          |            |      |          |
| Alt Prcl ID                 |            | Restriction   |               |                   |                               |                        |            |   |                                |       |           |                       |                     |                          |            |      |          |
| PLN#/Rec                    |            | Hist Distrct  |               |                   |                               |                        |            |   |                                |       |           |                       |                     |                          |            |      |          |
| Lot#                        |            | Other Note    |               |                   |                               |                        |            |   |                                |       |           |                       |                     |                          |            |      |          |
| Plan Notes                  |            | UC-Misc 1     |               |                   |                               |                        |            |   |                                |       |           |                       |                     |                          |            |      |          |
| Plan Notes                  |            | UC-Misc 2     |               |                   |                               |                        |            |   |                                |       |           |                       |                     |                          |            |      |          |
| Plan Notes                  |            |               |               |                   |                               |                        |            |   |                                |       |           |                       |                     |                          |            |      |          |
| GIS ID M_278584_795262      |            | Assoc Pid#    |               |                   |                               |                        |            |   |                                |       |           |                       |                     |                          |            |      |          |
|                             |            |               |               |                   |                               | Total                  |            | 930,900   | 930,900                        |       |           |                       |                     |                          |            |      |          |
| RECORD OF OWNERSHIP         |            |               | BK-VOL/PAGE   | SALE DATE         | Q/U                           | V/I                    | SALE PRICE | VC  | PREVIOUS ASSESSMENTS (HISTORY) |       |           |                       |                     |                          |            |      |          |
| LENT MARINA                 |            |               | 1466 0796     | 05-07-2018        | U                             | I                      | 1          | 1A  | Year                           | Code  | Assessed  | Year                  | Code                | Assessed                 | Year       | Code | Assessed |
| LENT BRIGITTE               |            |               | 0662 0301     | 09-29-1995        | U                             | I                      | 139,900    | 1J  | 2023                           | 1010  | 578,200   | 2022                  | 1010                | 365,500                  | 2021       | 1010 | 338,900  |
| LEONARD PAUL J              |            |               | 00443 0318    | 03-11-1986        | U                             | V                      | 75,000     | 1   |                                | 1010  | 287,800   |                       | 1010                | 287,800                  |            | 1010 | 287,800  |
| JAMPEL MICHAEL              |            |               | 00437 0651    | 11-22-1985        | U                             | V                      | 18,000     | 1   |                                |       |           |                       |                     |                          |            |      |          |
| GEDDIS JAMES B SR           |            |               | 00381 0460    | 02-27-1981        | U                             | V                      | 1          | 1A  |                                |       |           |                       |                     |                          |            |      |          |
|                             |            |               |               |                   |                               | Total                  |            | 866,000   | Total                          |       | 653,300   | Total                 |                     | 626,700                  |            |      |          |
| EXEMPTIONS                  |            |               |               | OTHER ASSESSMENTS |                               |                        |            | This signature acknowledges a visit by a Data Collector or Assessor |                                |       |           |                       |                     |                          |            |      |          |
| Year                        | Code       | Description   | Amount        | Code              | Description                   | Number                 | Amount     | Comm Int  |                                |       |           |                       |                     |                          |            |      |          |
|                             |            |               |               |                   |                               |                        |            |   |                                |       |           |                       |                     |                          |            |      |          |
| Total                       |            |               | 0.00          |                   |                               |                        |            |   |                                |       |           |                       |                     |                          |            |      |          |
| ASSESSING NEIGHBORHOOD      |            |               |               |                   |                               |                        |            | APPRAISED VALUE SUMMARY   |                                |       |           |                       |                     |                          |            |      |          |
| Nbhd                        | Nbhd Name  | B             | Tracing       | Batch             | Appraised Bldg. Value (Card)  |                        |            |   |                                |       | 609,700   |                       |                     |                          |            |      |          |
| 0040                        |            |               |               |                   | Appraised Xf (B) Value (Bldg) |                        |            |   |                                |       | 1,700     |                       |                     |                          |            |      |          |
|                             |            |               |               |                   | Appraised Ob (B) Value (Bldg) |                        |            |   |                                |       | 2,200     |                       |                     |                          |            |      |          |
|                             |            |               |               |                   | Appraised Land Value (Bldg)   |                        |            |   |                                |       | 317,300   |                       |                     |                          |            |      |          |
|                             |            |               |               |                   | Special Land Value            |                        |            |   |                                |       | 0         |                       |                     |                          |            |      |          |
|                             |            |               |               |                   | Total Appraised Parcel Value  |                        |            |   |                                |       | 930,900   |                       |                     |                          |            |      |          |
|                             |            |               |               |                   | Valuation Method              |                        |            |   |                                |       | C         |                       |                     |                          |            |      |          |
|                             |            |               |               |                   | Total Appraised Parcel Value  |                        |            |   |                                |       | 930,900   |                       |                     |                          |            |      |          |
| BUILDING PERMIT RECORD      |            |               |               |                   |                               |                        |            | VISIT / CHANGE HISTORY  |                                |       |           |                       |                     |                          |            |      |          |
| Permit Id                   | Issue Date | Type          | Description   | Amount            | Insp Date                     | % Comp                 | Date Comp  | Comments  | Date                           | Id    | Type      | Is                    | Cd                  | Purpost/Result           |            |      |          |
| 2023-709                    | 06-15-2023 | SOLR          | Solar Panels  |                   |                               | 0                      |            |   | 05-31-2022                     | DM    |           |                       | 11                  | Field Review             |            |      |          |
| 2019-124                    | 09-11-2018 | RA            | Res Add/Alter |                   |                               | 0                      |            | RECONFIGURE BEDROOMS  | 10-04-2019                     | EP    |           |                       | 01                  | Cyclical Reinspection    |            |      |          |
| 2019-55                     | 08-03-2018 | RA            | Res Add/Alter |                   |                               | 0                      |            | DOG RAMP, FIX ODS, WOOD   | 02-15-2019                     | EP    |           |                       | 01                  | Cyclical Reinspection    |            |      |          |
| 2004-257                    | 04-14-2004 | RN            | Res New Cons  |                   |                               | 100                    |            | SHED 8X12   | 05-24-2017                     | AU    |           |                       | 11                  | Field Review             |            |      |          |
|                             |            |               |               |                   |                               |                        |            |   | 11-09-2011                     | RK    |           |                       | 11                  | Field Review             |            |      |          |
|                             |            |               |               |                   |                               |                        |            |   | 01-04-2005                     | EP    |           |                       | 12                  | Bldg Permit/Measur/New C |            |      |          |
|                             |            |               |               |                   |                               |                        |            |   | 09-27-2004                     | EP    |           |                       | 51                  | Cyclical Reinspection    |            |      |          |
| LAND LINE VALUATION SECTION |            |               |               |                   |                               |                        |            |   |                                |       |           |                       |                     |                          |            |      |          |
| B                           | Use Code   | Description   | Zone          | Land Type         | Land Units                    | Unit Price             | Size Adj   | Site Index  | Cond.                          | Nbhd. | Nbhd. Adj | Notes                 | Location Adjustment | Adj Unit P               | Land Value |      |          |
| 1                           | 1010       | SINGL FAM M-0 | R20           |                   | 10,800 SF                     | 27.98                  | 1.00000    | 4   | 1.00                           | 0040  | 1.050     |                       |                     | 29.38                    | 317,300    |      |          |
| Total Card Land Units       |            |               |               |                   | 0.25 AC                       | Parcel Total Land Area |            |   |                                |       | 0.25      | Total Land Value      |                     |                          | 317,300    |      |          |

**VISION**

| CONSTRUCTION DETAIL |     |                | CONSTRUCTION DETAIL (CONTINUED) |    |             |
|---------------------|-----|----------------|---------------------------------|----|-------------|
| Element             | Cd  | Description    | Element                         | Cd | Description |
| Style:              | 04  | Cape Cod       |                                 |    |             |
| Model               | 01  | Residential    |                                 |    |             |
| Grade:              | 04  | Average +10    |                                 |    |             |
| Stories:            | 1.5 | 1 1/2 Stories  |                                 |    |             |
| Occupancy           | 1   |                |                                 |    |             |
| Exterior Wall 1     | 14  | Wood Shingle   |                                 |    |             |
| Exterior Wall 2     |     |                |                                 |    |             |
| Roof Structure:     | 03  | Gable/Hip      |                                 |    |             |
| Roof Cover          | 03  | Asph/F Gls/Cmp |                                 |    |             |
| Interior Wall 1     | 05  | Drywall/Sheet  |                                 |    |             |
| Interior Wall 2     |     |                |                                 |    |             |
| Interior Flr 1      | 14  | Carpet         |                                 |    |             |
| Interior Flr 2      | 12  | Hardwood       |                                 |    |             |
| Heat Fuel           | 04  | Electric       |                                 |    |             |
| Heat Type:          | 04  | Forced Air-Duc |                                 |    |             |
| AC Type:            | 02  | Heat Pump      |                                 |    |             |
| Total Bedrooms      | 03  | 3 Bedrooms     |                                 |    |             |
| Total Bthrms:       |     |                |                                 |    |             |
| Total Half Baths    | 2   |                |                                 |    |             |
| Total Xtra Fixtrs   | 1   |                |                                 |    |             |
| Total Rooms:        |     |                |                                 |    |             |
| Bath Style:         |     |                |                                 |    |             |
| Kitchen Style:      |     |                |                                 |    |             |

| CONDO DATA               |      |             |         |
|--------------------------|------|-------------|---------|
| Parcel Id                | C    | Owne        | 0.0     |
| Adjust Type              | Code | Description | Factor% |
| Condo Flr                |      |             |         |
| Condo Unit               |      |             |         |
| COST / MARKET VALUATION  |      |             |         |
| Building Value New       |      | 717,330     |         |
| Year Built               |      | 1986        |         |
| Effective Year Built     |      | 2007        |         |
| Depreciation Code        |      | A           |         |
| Remodel Rating           |      |             |         |
| Year Remodeled           |      |             |         |
| Depreciation %           |      | 15          |         |
| Functional Obsol         |      | 0           |         |
| External Obsol           |      | 0           |         |
| Trend Factor             |      | 1           |         |
| Condition                |      |             |         |
| Condition %              |      |             |         |
| Percent Good             |      | 85          |         |
| Cns Sect Rcnld           |      | 609,700     |         |
| Dep % Ovr                |      |             |         |
| Dep Ovr Comment          |      |             |         |
| Misc Imp Ovr             |      |             |         |
| Misc Imp Ovr Comment     |      |             |         |
| Cost to Cure Ovr         |      |             |         |
| Cost to Cure Ovr Comment |      |             |         |

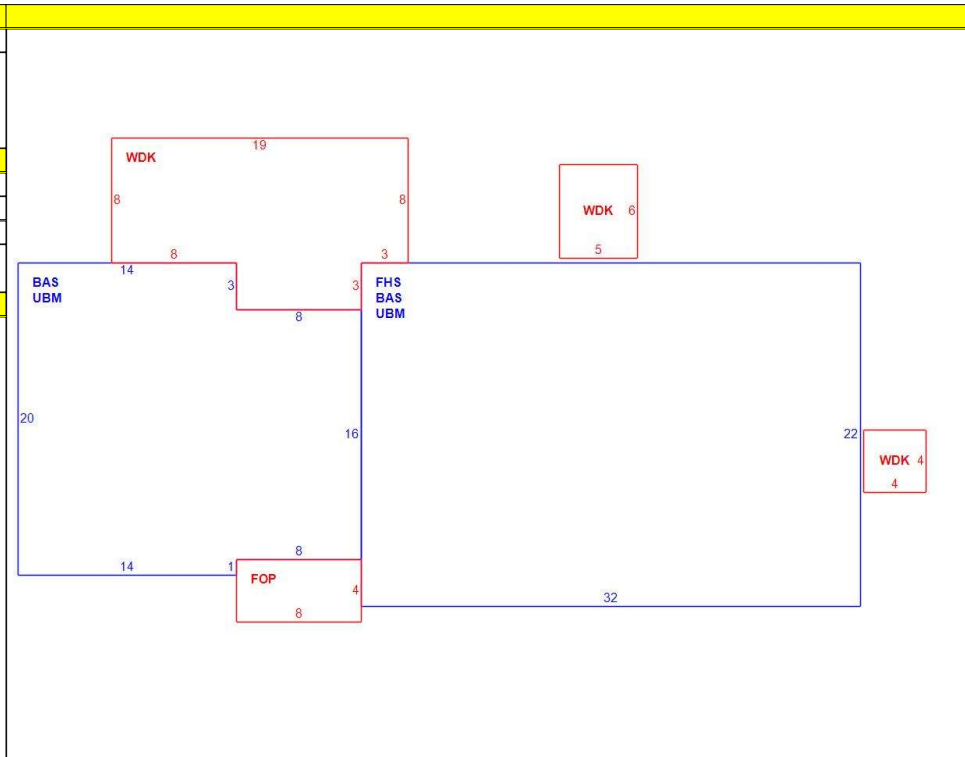

| OB - OUTBUILDING & YARD ITEMS(L) / XF - BUILDING EXTRA FEATURES(B) |             |     |       |            |        |          |      |       |            |             |
|--|-------------|-----|-------|------------|--------|----------|------|-------|------------|-------------|
| Code   | Description | L/B | Units | Unit Price | Yr Blt | Cond. Cd | % Gd | Grade | Grade Adj. | Appr. Value |
| FPL  | MTL-WD C/PI | B   | 1     | 2000.00    | 2001   |          | 85   |       | 0.00       | 1,700       |
| SHD1   | SHED FRAME  | L   | 96    | 16.00      | 2004   |          | 100  |       | 0.00       | 1,500       |
| ODS  | OUTDOOR S   | L   | 1     | 700.00     |        |          | 100  |       | 0.00       | 700         |

| BUILDING SUB-AREA SUMMARY SECTION |                       |             |            |          |           |                |
|-----------------------------------|-----------------------|-------------|------------|----------|-----------|----------------|
| Code                              | Description           | Living Area | Floor Area | Eff Area | Unit Cost | Undeprec Value |
| BAS                               | First Floor           | 1,112       | 1,112      | 1,112    | 413.70    | 460,033        |
| FHS                               | Half Story, Finished  | 352         | 704        | 352      | 206.85    | 145,622        |
| FOP                               | Porch, Open, Finished | 0           | 32         | 6        | 77.57     | 2,482          |
| UBM                               | Basement, Unfinished  | 0           | 1,112      | 222      | 82.59     | 91,841         |
| WDK                               | Deck, Wood            | 0           | 222        | 22       | 41.00     | 9,101          |
| Ttl Gross Liv / Lease Area        |                       | 1,464       | 3,182      | 1,714    |           | 709,079        |

