

| CURRENT OWNER  |  | TOPO   | UTILITIES      | STRT / ROAD | LOCATION | CURRENT ASSESSMENT |      |           |           |                       |
|--|--|--|----------------|-------------|----------|--------------------|------|-----------|-----------|-----------------------|
| CASTELLUCCI GIOVANNI   |  |  | 2 Public Water |             |          | Description        | Code | Appraised | Assessed  | 1302<br>EDGARTOWN, MA |
| 7 PRINCE GATE MEWS   |  |  |                |             |          | RESIDENTL          | 1010 | 1,756,800 | 1,756,800 |                       |
| LONDON SW72PS  |  | <b>SUPPLEMENTAL DATA</b>   |                |             |          | RES LND            | 1010 | 1,384,600 | 1,384,600 | <b>VISION</b>         |
| Alt Prcl ID<br>PLN#/Rec LC 14161 A&B<br>Lot#<br>Plan Notes<br>Plan Notes<br>Plan Notes<br>GIS ID M_279281_795677 |  | Restriction<br>Hist District<br>Other Note<br>UC-Misc 1<br>UC-Misc 2<br>Assoc Pid# |                |             |          | Total              |      | 3,141,400 | 3,141,400 |                       |

| RECORD OF OWNERSHIP          |      | BK-VOL/PAGE | SALE DATE  | Q/U | V/I | SALE PRICE | VC | PREVIOUS ASSESSMENTS (HISTORY) |      |           |       |      |           |
|------------------------------|------|-------------|------------|-----|-----|------------|----|--------------------------------|------|-----------|-------|------|-----------|
| BOWEN HILARY VALLIERES       | 0085 | 0142        | 11-22-2023 | Q   | I   | 4,400,000  | 00 | Year                           | Code | Assessed  | Year  | Code | Assessed  |
| CASTELLUCCI GIOVANNI         | 0063 | 0335        | 06-01-2005 | U   | I   | 1          | 1A | 2023                           | 1010 | 1,842,500 | 2022  | 1010 | 1,240,600 |
| CASTELLUCCI GIOVANNI TRS     | 0063 | 0333        | 06-01-2005 | Q   | I   | 879,000    | 00 |                                | 1010 | 1,201,000 |       | 1010 | 1,105,057 |
| DRAGONFLY MANAGEMENT INC TRS | 0057 | 0243        | 05-15-2000 | U   | I   | 1          | 1A | Total                          |      | 3,043,500 | Total |      | 2,345,657 |
| BRISTOL ANDREW SUTHERLAND &  | 0051 | 0143        | 11-04-1996 | U   | I   | 1          | 1A | Total                          |      | 2,174,050 | Total |      | 2,174,050 |

| EXEMPTIONS |      |             | OTHER ASSESSMENTS |      |             |        |        |          |
|------------|------|-------------|-------------------|------|-------------|--------|--------|----------|
| Year       | Code | Description | Amount            | Code | Description | Number | Amount | Comm Int |
| Total      |      |             | 0.00              |      |             |        |        |          |

| ASSESSING NEIGHBORHOOD |           |   |         |       |
|------------------------|-----------|---|---------|-------|
| Nbhd                   | Nbhd Name | B | Tracing | Batch |
| 0050                   |           |   |         |       |

  

| APPRAISED VALUE SUMMARY       |           |
|-------------------------------|-----------|
| Appraised Bldg. Value (Card)  | 1,715,700 |
| Appraised Xf (B) Value (Bldg) | 5,800     |
| Appraised Ob (B) Value (Bldg) | 35,300    |
| Appraised Land Value (Bldg)   | 1,384,600 |
| Special Land Value            | 0         |
| Total Appraised Parcel Value  | 3,141,400 |
| Valuation Method              | C         |
| Total Appraised Parcel Value  | 3,141,400 |

| BUILDING PERMIT RECORD |            |      |              |         |           |        |           | VISIT / CHANGE HISTORY   |            |    |      |    |    |                       |
|------------------------|------------|------|--------------|---------|-----------|--------|-----------|--------------------------|------------|----|------|----|----|-----------------------|
| Permit Id              | Issue Date | Type | Description  | Amount  | Insp Date | % Comp | Date Comp | Comments                 | Date       | Id | Type | Is | Cd | Purpost/Result        |
| 588-2020               | 02-12-2020 | CO   |              |         |           | 0      |           | GARAGE/DBR 545 SF        | 05-31-2022 | DM |      |    | 11 | Field Review          |
| 2019-43                | 08-01-2018 | SOLR | Solar Panels | 28,920  |           | 0      |           | SOLAR ROOF 6.12 KW       | 02-04-2020 | EP |      |    | 01 | Cyclical Reinspection |
| 2018-590               | 06-05-2018 | RN   | Res New Cons | 74,000  |           | 0      |           | 32.7 X 13.4 POOL         | 03-13-2019 | EP |      |    | 01 | Cyclical Reinspection |
| 2018-588               | 06-05-2018 | RN   | Res New Cons | 200,000 |           | 0      |           | GARAGE/DBR 545 SF        | 05-25-2017 | AU |      |    | 11 | Field Review          |
| 457-2015               | 11-24-2015 | CO   | CO ISSUED    |         |           | 0      |           | SFR NEW                  | 02-25-2016 | EP |      |    | 00 | Measur+Listed         |
| 2015-457               | 05-26-2015 | RN   | Res New Cons | 600,000 |           | 0      |           | DEMO & BUILD SFR 2587 SF | 04-07-2014 | JR |      |    | 01 | Cyclical Reinspection |
| 2007:60                | 10-16-2006 | RN   | Res New Cons |         |           |        |           |                          | 11-29-2011 | RK |      |    | 11 | Field Review          |

| LAND LINE VALUATION SECTION |          |               |      |           |            |            |                        |            |       |       |           |       |                     |            |            |
|-----------------------------|----------|---------------|------|-----------|------------|------------|------------------------|------------|-------|-------|-----------|-------|---------------------|------------|------------|
| B                           | Use Code | Description   | Zone | Land Type | Land Units | Unit Price | Size Adj               | Site Index | Cond. | Nbhd. | Nbhd. Adj | Notes | Location Adjustment | Adj Unit P | Land Value |
| 1                           | 1010     | SINGL FAM M-0 | R20  |           | 21,780     | SF         | 14.57                  | 1.00000    | 5     | 1.00  | 0053      | 2.700 | V15                 | 59.02      | 1,285,500  |
| 1                           | 1010     | SINGL FAM M-0 | R20  |           | 1.200      | AC         | 34,000.00              | 1.00000    | 0     | 0.60  | 0053      | 2.700 | V15                 | 82,620     | 99,100     |
| Total Card Land Units       |          |               |      |           | 1.70       | AC         | Parcel Total Land Area |            |       |       |           | 1.70  | Total Land Value    |            | 1,384,600  |

| CONSTRUCTION DETAIL            |      |                     | CONSTRUCTION DETAIL (CONTINUED) |     |             |
|--------------------------------|------|---------------------|---------------------------------|-----|-------------|
| Element                        | Cd   | Description         | Element                         | Cd  | Description |
| Style:                         | 63   | Modern/Contemporary |                                 |     |             |
| Model                          | 01   | Residential         |                                 |     |             |
| Grade:                         | 06   | Good                |                                 |     |             |
| Stories:                       | 2    |                     |                                 |     |             |
| Occupancy                      | 1    |                     |                                 |     |             |
| Exterior Wall 1                | 14   | Wood Shingle        |                                 |     |             |
| Exterior Wall 2                | 12   | Cedar or Redwd      |                                 |     |             |
| Roof Structure:                | 03   | Gable/Hip           |                                 |     |             |
| Roof Cover                     | 10   | Wood Shingle        |                                 |     |             |
| Interior Wall 1                | 05   | Drywall/Sheet       |                                 |     |             |
| Interior Wall 2                |      |                     |                                 |     |             |
| Interior Flr 1                 | 12   | Hardwood            |                                 |     |             |
| Interior Flr 2                 | 15   | Quarry Tile         |                                 |     |             |
| Heat Fuel                      | 03   | Gas                 |                                 |     |             |
| Heat Type:                     | 04   | Forced Air-Duc      |                                 |     |             |
| AC Type:                       | 03   | Central             |                                 |     |             |
| Total Bedrooms                 | 04   | 4 Bedrooms          |                                 |     |             |
| Total Bthrms:                  | 4    |                     |                                 |     |             |
| Total Half Baths               | 1    |                     |                                 |     |             |
| Total Xtra Fixtrs              |      |                     |                                 |     |             |
| Total Rooms:                   | 8    |                     |                                 |     |             |
| Bath Style:                    | 03   | Modern              |                                 |     |             |
| Kitchen Style:                 | 03   | Luxurious           |                                 |     |             |
| <b>CONDO DATA</b>              |      |                     |                                 |     |             |
| Parcel Id                      |      | C                   | Owne                            | 0.0 |             |
| Adjust Type                    | Code | Description         | Factor%                         |     |             |
| Condo Flr                      |      |                     |                                 |     |             |
| Condo Unit                     |      |                     |                                 |     |             |
| <b>COST / MARKET VALUATION</b> |      |                     |                                 |     |             |
| Building Value New             |      | 1,037,818           |                                 |     |             |
| Year Built                     |      | 2015                |                                 |     |             |
| Effective Year Built           |      | 2019                |                                 |     |             |
| Depreciation Code              |      | A                   |                                 |     |             |
| Remodel Rating                 |      |                     |                                 |     |             |
| Year Remodeled                 |      |                     |                                 |     |             |
| Depreciation %                 |      | 3                   |                                 |     |             |
| Functional Obsol               |      | 0                   |                                 |     |             |
| External Obsol                 |      | 0                   |                                 |     |             |
| Trend Factor                   |      | 1                   |                                 |     |             |
| Condition                      |      |                     |                                 |     |             |
| Condition %                    |      |                     |                                 |     |             |
| Percent Good                   |      | 97                  |                                 |     |             |
| Cns Sect Rcnd                  |      | 1,006,700           |                                 |     |             |
| Dep % Ovr                      |      |                     |                                 |     |             |
| Dep Ovr Comment                |      |                     |                                 |     |             |
| Misc Imp Ovr                   |      |                     |                                 |     |             |
| Misc Imp Ovr Comment           |      |                     |                                 |     |             |
| Cost to Cure Ovr               |      |                     |                                 |     |             |
| Cost to Cure Ovr Comment       |      |                     |                                 |     |             |

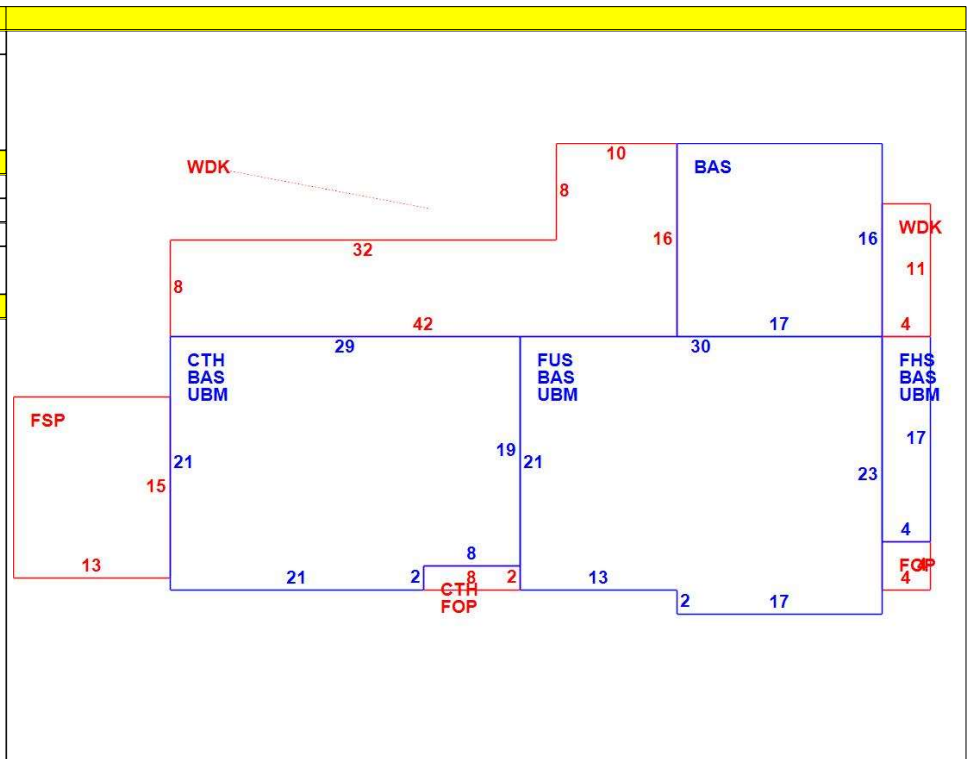

| OB - OUTBUILDING & YARD ITEMS(L) / XF - BUILDING EXTRA FEATURES(B) |              |     |       |            |        |          |      |       |            |             |
|--|--------------|-----|-------|------------|--------|----------|------|-------|------------|-------------|
| Code   | Description  | L/B | Units | Unit Price | Yr Blt | Cond. Cd | % Gd | Grade | Grade Adj. | Appr. Value |
| ODS  | OUTDOOR S    | L   | 1     | 700.00     |        |          | 100  |       | 0.00       | 700         |
| SHD1   | SHED FRAME   | L   | 80    | 16.00      |        |          | 100  |       | 0.00       | 1,300       |
| WDK  | WOOD DECK    | L   | 480   | 20.00      | 2013   |          | 100  |       | 0.00       | 9,600       |
| FPL3   | FPL MSNRY 2  | B   | 1     | 4000.00    | 2016   |          | 97   |       | 0.00       | 3,900       |
| FPL5   | GAS VENTED   | B   | 1     | 2000.00    | 2016   |          | 97   |       | 0.00       | 1,900       |
| SPL2   | INGR VINYL/P | L   | 384   | 60.00      | 2018   |          | 100  |       | 0.00       | 23,000      |

| BUILDING SUB-AREA SUMMARY SECTION |                         |             |            |          |           |                |
|-----------------------------------|-------------------------|-------------|------------|----------|-----------|----------------|
| Code                              | Description             | Living Area | Floor Area | Eff Area | Unit Cost | Undeprec Value |
| BAS                               | First Floor             | 1,597       | 1,597      | 1,597    | 376.56    | 601,363        |
| CTH                               | Cath Cing               | 0           | 609        | 30       | 18.55     | 11,297         |
| FHS                               | Half Story, Finished    | 34          | 68         | 34       | 188.28    | 12,803         |
| FOP                               | Porch, Open, Finished   | 0           | 32         | 6        | 70.60     | 2,259          |
| FSP                               | Porch, Screen, Finished | 0           | 195        | 49       | 94.62     | 18,451         |
| FUS                               | Upper Story, Finished   | 664         | 664        | 664      | 376.56    | 250,035        |
| UBM                               | Basement, Unfinished    | 0           | 1,325      | 265      | 75.31     | 99,788         |
| WDK                               | Deck, Wood              | 0           | 460        | 46       | 37.66     | 17,322         |
| Ttl Gross Liv / Lease Area        |                         | 2,295       | 4,950      | 2,691    |           | 1,013,318      |



| CURRENT OWNER  |  | TOPO   | UTILITIES   | STRT / ROAD | LOCATION | CURRENT ASSESSMENT        |      |           |           |                       |
|--|--|--------|---|-------------|----------|---------------------------|------|-----------|-----------|-----------------------|
| CASTELLUCCI GIOVANNI   |  |        | 2 Public Water  |             |          | Description               | Code | Appraised | Assessed  | 1302<br>EDGARTOWN, MA |
| 7 PRINCE GATE MEWS   |  |        |   |             |          | RESIDENTL                 | 1010 | 1,756,800 | 1,756,800 |                       |
| LONDON   |  | SW72PS |   |             |          | RES LND                   | 1010 | 1,384,600 | 1,384,600 | <b>VISION</b>         |
| SUPPLEMENTAL DATA  |  |        |   |             |          |                           |      |           |           |                       |
| Alt Prcl ID<br>PLN#/Rec LC 14161 A&B<br>Lot#<br>Plan Notes<br>Plan Notes<br>Plan Notes |  |        | Restriction<br>Hist Distrct<br>Other Note<br>UC-Misc 1<br>UC-Misc 2 |             |          |                           |      |           |           |                       |
| GIS ID M_279281_795677   |  |        | Assoc Pid#  |             |          | Total 3,141,400 3,141,400 |      |           |           |                       |

| RECORD OF OWNERSHIP          |      | BK-VOL/PAGE | SALE DATE  | Q/U | V/I | SALE PRICE | VC | PREVIOUS ASSESSMENTS (HISTORY) |      |           |      |           |           |       |      |           |  |
|------------------------------|------|-------------|------------|-----|-----|------------|----|--------------------------------|------|-----------|------|-----------|-----------|-------|------|-----------|--|
| BOWEN HILARY VALLIERES       | 0085 | 0142        | 11-22-2023 | Q   | I   | 4,400,000  | 00 | Year                           | Code | Assessed  | Year | Code      | Assessed  | Year  | Code | Assessed  |  |
| CASTELLUCCI GIOVANNI         | 0063 | 0335        | 06-01-2005 | U   | I   | 1          | 1A | 2023                           | 1010 | 1,842,500 | 2022 | 1010      | 1,240,600 | 2021  | 1010 | 1,207,600 |  |
| CASTELLUCCI GIOVANNI TRS     | 0063 | 0333        | 06-01-2005 | Q   | I   | 879,000    | 00 |                                | 1010 | 1,201,000 |      | 1010      | 1,105,057 |       | 1010 | 966,450   |  |
| DRAGONFLY MANAGEMENT INC TRS | 0057 | 0243        | 05-15-2000 | U   | I   | 1          | 1A |                                |      |           |      |           |           |       |      |           |  |
| BRISTOL ANDREW SUTHERLAND &  | 0051 | 0143        | 11-04-1996 | U   | I   | 1          | 1A |                                |      |           |      |           |           |       |      |           |  |
| Total                        |      |             |            |     |     |            |    | 3,043,500                      |      | Total     |      | 2,345,657 |           | Total |      | 2,174,050 |  |

| EXEMPTIONS |      |             |        | OTHER ASSESSMENTS |             |        |        | This signature acknowledges a visit by a Data Collector or Assessor |  |  |  |  |  |  |  |  |
|------------|------|-------------|--------|-------------------|-------------|--------|--------|---|--|--|--|--|--|--|--|--|
| Year       | Code | Description | Amount | Code              | Description | Number | Amount | Comm Int  |  |  |  |  |  |  |  |  |
| Total      |      |             | 0.00   |                   |             |        |        |   |  |  |  |  |  |  |  |  |

| ASSESSING NEIGHBORHOOD        |           |   |         |       |  | APPRAISED VALUE SUMMARY |  |  |  |  |  |
|-------------------------------|-----------|---|---------|-------|--|-------------------------|--|--|--|--|--|
| Nbhd                          | Nbhd Name | B | Tracing | Batch |  |                         |  |  |  |  |  |
| 0050                          |           |   |         |       |  |                         |  |  |  |  |  |
| NOTES                         |           |   |         |       |  |                         |  |  |  |  |  |
| 1/2 BATH IN GARAGE AREA       |           |   |         |       |  |                         |  |  |  |  |  |
| Appraised Bldg. Value (Card)  |           |   |         |       |  | 1,715,700               |  |  |  |  |  |
| Appraised Xf (B) Value (Bldg) |           |   |         |       |  | 5,800                   |  |  |  |  |  |
| Appraised Ob (B) Value (Bldg) |           |   |         |       |  | 35,300                  |  |  |  |  |  |
| Appraised Land Value (Bldg)   |           |   |         |       |  | 1,384,600               |  |  |  |  |  |
| Special Land Value            |           |   |         |       |  | 0                       |  |  |  |  |  |
| Total Appraised Parcel Value  |           |   |         |       |  | 3,141,400               |  |  |  |  |  |
| Valuation Method              |           |   |         |       |  | C                       |  |  |  |  |  |
| Total Appraised Parcel Value  |           |   |         |       |  | 3,141,400               |  |  |  |  |  |

| BUILDING PERMIT RECORD |            |      |             |        |           |        |           | VISIT / CHANGE HISTORY |      |    |      |    |    |                |
|------------------------|------------|------|-------------|--------|-----------|--------|-----------|------------------------|------|----|------|----|----|----------------|
| Permit Id              | Issue Date | Type | Description | Amount | Insp Date | % Comp | Date Comp | Comments               | Date | Id | Type | Is | Cd | Purpost/Result |
|                        |            |      |             |        |           |        |           |                        |      |    |      |    |    |                |

| LAND LINE VALUATION SECTION |          |               |      |           |            |            |                        |            |       |       |           |       |                     |            |            |   |
|-----------------------------|----------|---------------|------|-----------|------------|------------|------------------------|------------|-------|-------|-----------|-------|---------------------|------------|------------|---|
| B                           | Use Code | Description   | Zone | Land Type | Land Units | Unit Price | Size Adj               | Site Index | Cond. | Nbhd. | Nbhd. Adj | Notes | Location Adjustment | Adj Unit P | Land Value |   |
| 2                           | 1010     | SINGL FAM M-0 |      |           | SF         |            | 1.00000                | 4          | 1.00  |       | 1.000     |       |                     |            | 0          |   |
| Total Card Land Units       |          |               |      |           | 0.00       | AC         | Parcel Total Land Area |            |       |       |           | 1.70  | Total Land Value    |            |            | 0 |

| CONSTRUCTION DETAIL            |      |                | CONSTRUCTION DETAIL (CONTINUED) |     |             |
|--------------------------------|------|----------------|---------------------------------|-----|-------------|
| Element                        | Cd   | Description    | Element                         | Cd  | Description |
| Style:                         | 06   | Custom         |                                 |     |             |
| Model                          | 01   | Residential    |                                 |     |             |
| Grade:                         | 06   | Good           |                                 |     |             |
| Stories:                       | 2    |                |                                 |     |             |
| Occupancy                      | 01   |                |                                 |     |             |
| Exterior Wall 1                | 12   | Cedar or Redwd |                                 |     |             |
| Exterior Wall 2                |      |                |                                 |     |             |
| Roof Structure:                | 03   | Gable/Hip      |                                 |     |             |
| Roof Cover                     | 10   | Wood Shingle   |                                 |     |             |
| Interior Wall 1                | 05   | Drywall/Sheet  |                                 |     |             |
| Interior Wall 2                | 07   | K PINE/A WD    |                                 |     |             |
| Interior Flr 1                 | 12   | Hardwood       |                                 |     |             |
| Interior Flr 2                 |      |                |                                 |     |             |
| Heat Fuel                      | 04   | Electric       |                                 |     |             |
| Heat Type:                     | 04   | Forced Air-Duc |                                 |     |             |
| AC Type:                       | 02   | Heat Pump      |                                 |     |             |
| Total Bedrooms                 | 01   | 1 Bedroom      |                                 |     |             |
| Total Bthrms:                  | 1    |                |                                 |     |             |
| Total Half Baths               | 1    |                |                                 |     |             |
| Total Xtra Fixtrs              |      |                |                                 |     |             |
| Total Rooms:                   | 3    |                |                                 |     |             |
| Bath Style:                    | 02   | Average        |                                 |     |             |
| Kitchen Style:                 | 02   | Modern         |                                 |     |             |
| <b>CONDO DATA</b>              |      |                |                                 |     |             |
| Parcel Id                      |      | C              | Ownr                            | 0.0 |             |
|                                |      |                | B                               | S   |             |
| Adjust Type                    | Code | Description    | Factor%                         |     |             |
| Condo Flr                      |      |                |                                 |     |             |
| Condo Unit                     |      |                |                                 |     |             |
| <b>COST / MARKET VALUATION</b> |      |                |                                 |     |             |
| Building Value New             |      |                | 708,978                         |     |             |
| Year Built                     |      |                | 2018                            |     |             |
| Effective Year Built           |      |                | 2022                            |     |             |
| Depreciation Code              |      |                | A                               |     |             |
| Remodel Rating                 |      |                |                                 |     |             |
| Year Remodeled                 |      |                |                                 |     |             |
| Depreciation %                 |      |                | 0                               |     |             |
| Functional Obsol               |      |                |                                 |     |             |
| External Obsol                 |      |                |                                 |     |             |
| Trend Factor                   |      |                | 1                               |     |             |
| Condition                      |      |                |                                 |     |             |
| Condition %                    |      |                |                                 |     |             |
| Percent Good                   |      |                | 100                             |     |             |
| Cns Sect Rcnld                 |      |                | 709,000                         |     |             |
| Dep % Ovr                      |      |                |                                 |     |             |
| Dep Ovr Comment                |      |                |                                 |     |             |
| Misc Imp Ovr                   |      |                |                                 |     |             |
| Misc Imp Ovr Comment           |      |                |                                 |     |             |
| Cost to Cure Ovr               |      |                |                                 |     |             |
| Cost to Cure Ovr Comment       |      |                |                                 |     |             |

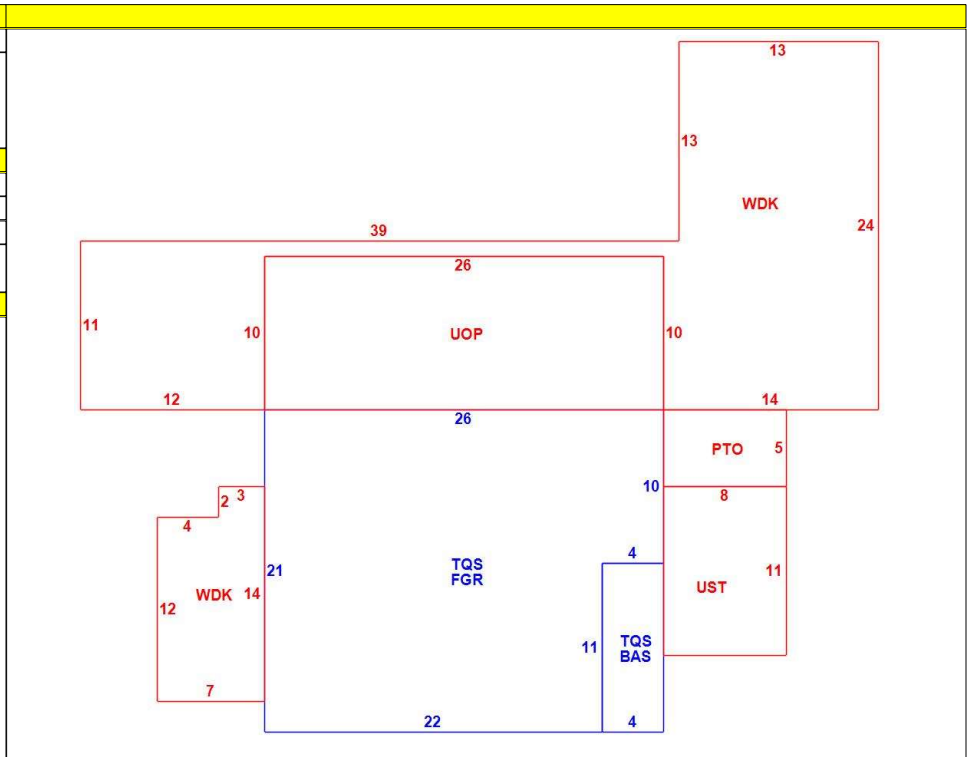

| OB - OUTBUILDING & YARD ITEMS(L) / XF - BUILDING EXTRA FEATURES(B) |             |     |       |            |        |          |      |       |            |             |
|--|-------------|-----|-------|------------|--------|----------|------|-------|------------|-------------|
| Code   | Description | L/B | Units | Unit Price | Yr Blt | Cond. Cd | % Gd | Grade | Grade Adj. | Appr. Value |
| ODS  | OUTDOOR S   | L   | 1     | 700.00     | 2018   |          | 100  |       | 0.00       | 700         |

| BUILDING SUB-AREA SUMMARY SECTION |                              |             |            |          |           |                |
|-----------------------------------|------------------------------|-------------|------------|----------|-----------|----------------|
| Code                              | Description                  | Living Area | Floor Area | Eff Area | Unit Cost | Undeprec Value |
| BAS                               | First Floor                  | 44          | 44         | 44       | 902.15    | 39,694         |
| FGR                               | Garage                       | 0           | 502        | 201      | 361.22    | 181,331        |
| PTO                               | Patio                        | 0           | 40         | 4        | 90.21     | 3,609          |
| TQS                               | Three Quarter Story          | 410         | 546        | 410      | 677.44    | 369,880        |
| UOP                               | Porch, Open, Unfinished      | 0           | 260        | 26       | 90.21     | 23,456         |
| UST                               | Utility, Storage, Unfinished | 0           | 88         | 40       | 410.07    | 36,086         |
| WDK                               | Deck, Wood                   | 0           | 571        | 57       | 90.06     | 51,422         |
| Ttl Gross Liv / Lease Area        |                              | 454         | 2,051      | 782      |           | 705,478        |

