

| CURRENT OWNER   |            | TOPO          | UTILITIES   | STRT / ROAD                          | LOCATION   | CURRENT ASSESSMENT     |                  |   |   | 1302<br>EDGARTOWN, MA |           |  |                     |                       |            |         |      |          |
|---|------------|---------------|---|--------------------------------------|--|------------------------|------------------|---|---|-----------------------|-----------|--|---------------------|-----------------------|------------|---------|------|----------|
| SAND STEPHEN P &<br>CHAO PAULINE Y<br>50 FULLER ST<br><br>DEDHAM, MA 02026  |            |               | 2 Public Water  |                                      |  | Description            | Code             | Appraised                                   | Assessed  |                       |           | <b>VISION</b>                          |                     |                       |            |         |      |          |
|   |            |               |   |                                      |  | RESIDENTL              | 1010             | 689,200                                     | 689,200   |                       |           |  |                     |                       |            |         |      |          |
|   |            |               |   |                                      |  | RES LND                | 1010             | 584,100                                     | 584,100   |                       |           |  |                     |                       |            |         |      |          |
| SUPPLEMENTAL DATA   |            |               |   |                                      |  |                        |                  |   |   |                       |           |  |                     |                       |            |         |      |          |
| Alt Prcl ID<br>PLN#/Rec<br>Lot#<br>Plan Notes<br>Plan Notes<br>Plan Notes<br>GIS ID M_277475_796145               |            |               | Restriction<br>Hist Distrct<br>Other Note<br>UC-Misc 1<br>UC-Misc 2<br><br>Assoc Pid# |                                      |  |                        |                  |   |   |                       |           |  |                     |                       |            |         |      |          |
|   |            |               |   |                                      |  | Total                  |                  | 1,273,300                                   | 1,273,300   |                       |           |  |                     |                       |            |         |      |          |
| RECORD OF OWNERSHIP   |            |               | BK-VOL/PAGE   | SALE DATE                            | Q/U  | V/I                    | SALE PRICE       | VC  | PREVIOUS ASSESSMENTS (HISTORY)                                      |                       |           |  |                     |                       |            |         |      |          |
| SAND STEPHEN P &<br>NATHANSON RICHARD M<br>MCGRATH JOHN J JR<br>MCMICHAEL ARCHIBALD W JR<br>VAN ROSBECK PETER TRS |            |               | 0042<br>00036<br>00030<br>00026<br>00024  | 0137<br>0141<br>0071<br>0485<br>0459 | 09-14-1990<br>06-16-1986<br>09-23-1982<br>04-11-1980<br>03-01-1979 | U<br>Q<br>Q<br>Q       | I<br>I<br>V<br>V | 205,000<br>180,000<br>38,900<br>23,750<br>0 | 1<br>00<br>00<br>00<br>00   | Year                  | Code      | Assessed                               | Year                | Code                  | Assessed   | Year    | Code | Assessed |
|   |            |               |   |                                      |  |                        |                  |   |   | 2023                  | 1010      | 649,000                                | 2022                | 1010                  | 431,700    | 2021    | 1010 | 399,800  |
|   |            |               |   |                                      |  |                        |                  |   |   |                       | 1010      | 355,900                                |                     | 1010                  | 338,300    |         | 1010 | 518,200  |
|   |            |               |   |                                      |  |                        |                  |   |   | Total                 |           | 1,004,900                              | Total               |                       | 770,000    | Total   |      | 918,000  |
| EXEMPTIONS  |            |               | OTHER ASSESSMENTS   |                                      |  |                        |                  |   | This signature acknowledges a visit by a Data Collector or Assessor |                       |           |  |                     |                       |            |         |      |          |
| Year  | Code       | Description   | Amount  | Code                                 | Description  | Number                 | Amount           | Comm Int                                    |   |                       |           |  |                     |                       |            |         |      |          |
|   |            |               |   |                                      |  |                        |                  |   |   |                       |           |  |                     |                       |            |         |      |          |
| Total   |            |               | 0.00  |                                      |  |                        |                  |   |   |                       |           |  |                     |                       |            |         |      |          |
| ASSESSING NEIGHBORHOOD  |            |               |   |                                      |  |                        |                  |   |   |                       |           |  |                     |                       |            |         |      |          |
| Nbhd  | Nbhd Name  | B             | Tracing   | Batch                                |  |                        |                  |   |   |                       |           |  |                     |                       |            |         |      |          |
| 0050  |            |               |   |                                      |  |                        |                  |   |   |                       |           |  |                     |                       |            |         |      |          |
| NOTES   |            |               |   |                                      |  |                        |                  |   |   |                       |           |  |                     |                       |            |         |      |          |
| ABUTTS HIGHWAY<br>LOT 848 LC 11405K   |            |               |   |                                      |  |                        |                  |   |   |                       |           |  |                     |                       |            |         |      |          |
|   |            |               |   |                                      |  |                        |                  |   |   |                       |           | Appraised Bldg. Value (Card) 688,500   |                     |                       |            |         |      |          |
|   |            |               |   |                                      |  |                        |                  |   |   |                       |           | Appraised Xf (B) Value (Bldg) 0        |                     |                       |            |         |      |          |
|   |            |               |   |                                      |  |                        |                  |   |   |                       |           | Appraised Ob (B) Value (Bldg) 700      |                     |                       |            |         |      |          |
|   |            |               |   |                                      |  |                        |                  |   |   |                       |           | Appraised Land Value (Bldg) 584,100    |                     |                       |            |         |      |          |
|   |            |               |   |                                      |  |                        |                  |   |   |                       |           | Special Land Value 0                   |                     |                       |            |         |      |          |
|   |            |               |   |                                      |  |                        |                  |   |   |                       |           | Total Appraised Parcel Value 1,273,300 |                     |                       |            |         |      |          |
|   |            |               |   |                                      |  |                        |                  |   |   |                       |           | Valuation Method C                     |                     |                       |            |         |      |          |
|   |            |               |   |                                      |  |                        |                  |   |   |                       |           | Total Appraised Parcel Value 1,273,300 |                     |                       |            |         |      |          |
| BUILDING PERMIT RECORD  |            |               |   |                                      |  |                        |                  |   |   |                       |           | VISIT / CHANGE HISTORY                 |                     |                       |            |         |      |          |
| Permit Id   | Issue Date | Type          | Description   | Amount                               | Insp Date  | % Comp                 | Date Comp        | Comments                                    | Date  | Id                    | Type      | Is                                     | Cd                  | Purpost/Result        |            |         |      |          |
| 2018-388  | 03-09-2018 | RA            | Res Add/Alter   | 50,000                               |  | 0                      |                  | DINING ROOM ADDITION                        | 05-31-2022  | LS                    |           |  | 11                  | Field Review          |            |         |      |          |
| 2016-179  | 10-16-2015 | RA            | Res Add/Alter   | 12,000                               |  | 0                      |                  | SHINGLE ROOF                                | 02-11-2019  | EP                    |           |  | 01                  | Cyclical Reinspection |            |         |      |          |
|   |            |               |   |                                      |  |                        |                  |   | 05-22-2017  | AU                    |           |  | 11                  | Field Review          |            |         |      |          |
|   |            |               |   |                                      |  |                        |                  |   | 11-30-2011  | RK                    |           |  | 11                  | Field Review          |            |         |      |          |
|   |            |               |   |                                      |  |                        |                  |   | 12-07-2009  | EP                    |           |  | 01                  | Cyclical Reinspection |            |         |      |          |
|   |            |               |   |                                      |  |                        |                  |   | 04-21-2004  | CR                    |           |  | 01                  | Cyclical Reinspection |            |         |      |          |
|   |            |               |   |                                      |  |                        |                  |   | 07-07-2000  | WP                    |           |  | 43                  | Cyclical Reinspection |            |         |      |          |
| LAND LINE VALUATION SECTION   |            |               |   |                                      |  |                        |                  |   |   |                       |           |  |                     |                       |            |         |      |          |
| B   | Use Code   | Description   | Zone  | Land Type                            | Land Units   | Unit Price             | Size Adj         | Site Index                                  | Cond.   | Nbhd.                 | Nbhd. Adj | Notes                                  | Location Adjustment | Adj Unit P            | Land Value |         |      |          |
| 1   | 1010       | SINGL FAM M-0 | R20   |                                      | 21,780 SF  | 14.57                  | 1.00000          | 5   | 1.00  | 0050                  | 1.800     |  |                     | 26.23                 | 571,200    |         |      |          |
| 1   | 1010       | SINGL FAM M-0 | R20   |                                      | 0.210 AC   | 34,000.00              | 1.00000          | 0   | 1.00  | 0050                  | 1.800     |  |                     | 61,200                | 12,900     |         |      |          |
| Total Card Land Units   |            |               |   |                                      | 0.71 AC  | Parcel Total Land Area |                  |   |   |                       | 0.71      | Total Land Value                       |                     |                       |            | 584,100 |      |          |

| CONSTRUCTION DETAIL      |      |                | CONSTRUCTION DETAIL (CONTINUED) |      |             |
|--------------------------|------|----------------|---------------------------------|------|-------------|
| Element                  | Cd   | Description    | Element                         | Cd   | Description |
| Style:                   | 04   | Cape Cod       |                                 |      |             |
| Model                    | 01   | Residential    |                                 |      |             |
| Grade:                   | 05   | Average +20    |                                 |      |             |
| Stories:                 | 1.75 |                |                                 |      |             |
| Occupancy                | 1    |                |                                 |      |             |
| Exterior Wall 1          | 14   | Wood Shingle   |                                 |      |             |
| Exterior Wall 2          |      |                |                                 |      |             |
| Roof Structure:          | 03   | Gable/Hip      |                                 |      |             |
| Roof Cover               | 03   | Asph/F Gls/Cmp |                                 |      |             |
| Interior Wall 1          | 05   | Drywall/Sheet  |                                 |      |             |
| Interior Wall 2          |      |                |                                 |      |             |
| Interior Flr 1           | 14   | Carpet         |                                 |      |             |
| Interior Flr 2           | 12   | Hardwood       |                                 |      |             |
| Heat Fuel                | 04   | Electric       |                                 |      |             |
| Heat Type:               | 04   | Forced Air-Duc |                                 |      |             |
| AC Type:                 | 02   | Heat Pump      |                                 |      |             |
| Total Bedrooms           | 03   | 3 Bedrooms     |                                 |      |             |
| Total Bthrms:            |      |                |                                 |      |             |
| Total Half Baths         | 0    |                |                                 |      |             |
| Total Xtra Fixtrs        |      |                |                                 |      |             |
| Total Rooms:             |      |                |                                 |      |             |
| Bath Style:              |      |                |                                 |      |             |
| Kitchen Style:           |      |                |                                 |      |             |
|                          |      |                | <b>CONDO DATA</b>               |      |             |
| Parcel Id                |      |                | C                               | Owne | 0.0         |
|                          |      |                | B                               | S    |             |
| Adjust Type              | Code | Description    | Factor%                         |      |             |
| Condo Flr                |      |                |                                 |      |             |
| Condo Unit               |      |                |                                 |      |             |
|                          |      |                | <b>COST / MARKET VALUATION</b>  |      |             |
| Building Value New       |      | 809,974        |                                 |      |             |
| Year Built               |      | 1982           |                                 |      |             |
| Effective Year Built     |      | 2007           |                                 |      |             |
| Depreciation Code        |      | G              |                                 |      |             |
| Remodel Rating           |      |                |                                 |      |             |
| Year Remodeled           |      |                |                                 |      |             |
| Depreciation %           |      | 15             |                                 |      |             |
| Functional Obsol         |      | 0              |                                 |      |             |
| External Obsol           |      | 0              |                                 |      |             |
| Trend Factor             |      | 1              |                                 |      |             |
| Condition                |      |                |                                 |      |             |
| Condition %              |      |                |                                 |      |             |
| Percent Good             |      | 85             |                                 |      |             |
| Cns Sect Rcnd            |      | 688,500        |                                 |      |             |
| Dep % Ovr                |      |                |                                 |      |             |
| Dep Ovr Comment          |      |                |                                 |      |             |
| Misc Imp Ovr             |      |                |                                 |      |             |
| Misc Imp Ovr Comment     |      |                |                                 |      |             |
| Cost to Cure Ovr         |      |                |                                 |      |             |
| Cost to Cure Ovr Comment |      |                |                                 |      |             |

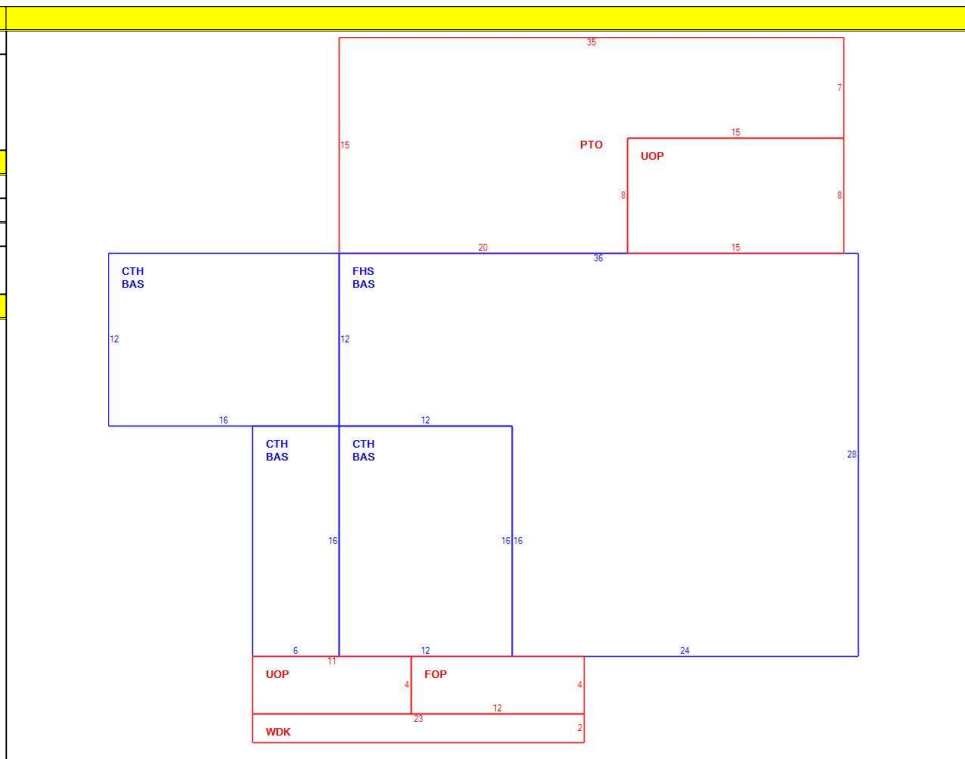

| OB - OUTBUILDING & YARD ITEMS(L) / XF - BUILDING EXTRA FEATURES(B) |             |     |       |            |        |          |      |       |            |             |
|--|-------------|-----|-------|------------|--------|----------|------|-------|------------|-------------|
| Code   | Description | L/B | Units | Unit Price | Yr Blt | Cond. Cd | % Gd | Grade | Grade Adj. | Appr. Value |
| ODP  | OUTDOOR PL  | L   | 1     | 700.00     |        |          | 100  |       | 0.00       | 700         |

| BUILDING SUB-AREA SUMMARY SECTION |                         |             |            |          |           |                |  |
|-----------------------------------|-------------------------|-------------|------------|----------|-----------|----------------|--|
| Code                              | Description             | Living Area | Floor Area | Eff Area | Unit Cost | Undeprec Value |  |
| BAS                               | First Floor             | 1,296       | 1,296      | 1,296    | 446.65    | 578,861        |  |
| CTH                               | Cath Cing               | 0           | 480        | 24       | 22.33     | 10,720         |  |
| FHS                               | Half Story, Finished    | 408         | 816        | 408      | 223.33    | 182,234        |  |
| FOP                               | Porch, Open, Finished   | 0           | 48         | 10       | 93.05     | 4,467          |  |
| PTO                               | Patio                   | 0           | 405        | 41       | 45.22     | 18,313         |  |
| UOP                               | Porch, Open, Unfinished | 0           | 164        | 16       | 43.58     | 7,146          |  |
| WDK                               | Deck, Wood              | 0           | 46         | 5        | 48.55     | 2,233          |  |
| Ttl Gross Liv / Lease Area        |                         | 1,704       | 3,255      | 1,800    |           | 803,974        |  |

