

Key: 1391

Town of SCITUATE - Fiscal Year 2024

10/18/2023 5:31 pm SEQ #: 1.339

LEGAL

CURRENT OWNER				PARCEL ID				LOCATION			
BOWLING ELIZABETH S 108 SATUIT TRAIL SCITUATE, MA 02066				48-3-19-0				108 SATUIT TRL			
TRANSFER HISTORY				DOS	T	SALE PRICE	BK-PG (Cert)				
BOWLING ELIZABETH S				01/01/1984	QS		5644-437				
BOWLING WILLIAM H & ELIZA				01/01/1979	XX		4584-469				
ABBOTT ROBERT O III & CAT				01/01/1978	XX		4316-286				

CLASS	CLASS%	DESCRIPTION			BN ID	BN	CARD
1010	100	SINGLE FAMILY				1	1 of 1
PMT NO	PMT DT	TY	DESC	AMOUNT	INSP	BY	1st %
01-423	08/07/2001	3	ALTERATIONS				100 100

LAND

CD	T	AC/SF/UN	Ngh	Infl1	Infl2	ADJ BASE	SAF	Infl3	Lpi	VC	CREDIT AMT	ADJ VALUE
100	S	40,000	SC 1.00	100	1.00	396,000	1.00	100	1.00	R04	0.90	363,640
300	A	0.071	SC 1.00	100	1.00	17,820	1.00	100	1.00	R04	0.90	1,270

TOTAL	43,092 SF	ZONING	FRNT	41	ASSESSED	CURRENT	PREVIOUS
Ngh	SCITUATE	NOTE			LAND	364,900	350,200
Infl1	FACTOR 100		BUILDING	377,500	335,800		
Infl2	PHY 100		DETACHED	0	0		
			OTHER	0	0		
					TOTAL	742,400	686,000

DETACHED

TY	QUAL	COND	DIM/NOTE	YB	UNITS	ADJ PRICE	RCNLD

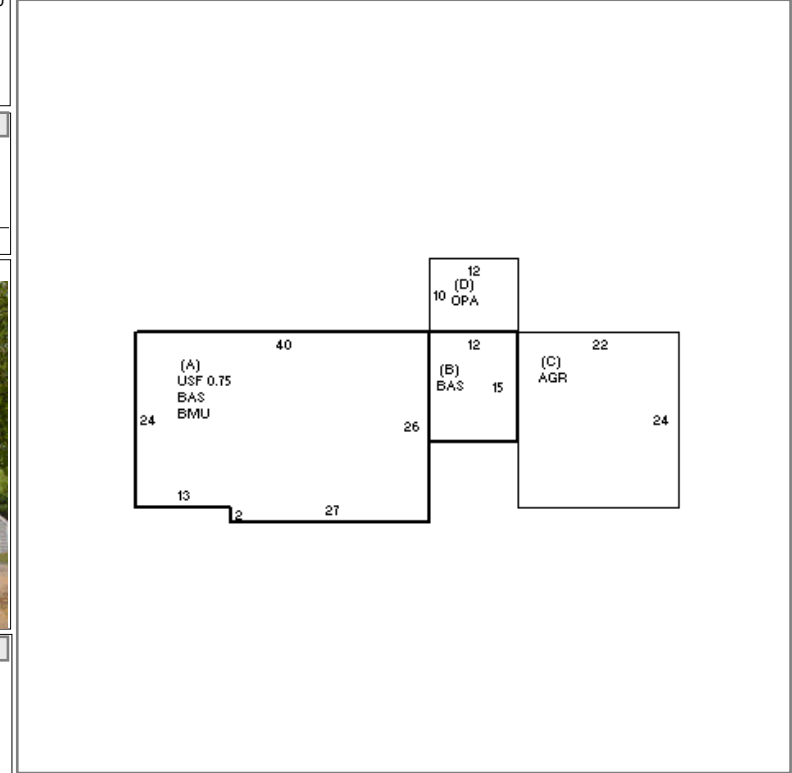

BUILDING

BUILDING	CD	ADJ	DESC	MEASURE	8/13/2010	PL
MODEL	1		RESIDENTIAL	LIST	8/13/2010	EST
STYLE	4	1.10	CAPE [100%]	REVIEW	3/18/2011	KT
QUALITY	A	1.00	AVERAGE [100%]	BLDG COMMENTS		
FRAME	1	1.00	WOOD FRAME [100%]	FY12 FR-G TO AVE		

INDING

YEAR BLT	1962	SIZE ADJ	1.000	ELEMENT	CD	DESCRIPTION	ADJ	S	BAT	T	DESCRIPTION	UNITS	YB	ADJ PRICE	RCN	TOTAL RCN	510,165																							
NET AREA	1,955	DETAIL ADJ	1.100	FOUNDATION	4	CONT BSMT WALL	1.00	A	BMU	N	BSMT UNFINISHED	1,014		46.98	47,641	<table border="1"> <thead> <tr> <th>CONDITION ELEM</th> <th>CD</th> </tr> </thead> <tbody> <tr> <td>EXTERIOR</td> <td></td> </tr> <tr> <td>INTERIOR</td> <td></td> </tr> <tr> <td>KITCHEN</td> <td></td> </tr> <tr> <td>BATHS</td> <td></td> </tr> <tr> <td>HEAT</td> <td></td> </tr> <tr> <td>ELECT</td> <td></td> </tr> </tbody> </table>	CONDITION ELEM	CD	EXTERIOR		INTERIOR		KITCHEN		BATHS		HEAT		ELECT											
CONDITION ELEM	CD																																							
EXTERIOR																																								
INTERIOR																																								
KITCHEN																																								
BATHS																																								
HEAT																																								
ELECT																																								
\$NLA(RCN)	\$261	OVERALL	1.000	EXT COVER	1	WD SHINGLES	1.00	A	USF	L	UPPER STORY FIN	761	1962	202.43	154,053																									
				ROOF SHAPE	1	GABLE	1.00	+	BAS	L	BASE AREA	1,194	1962	222.60	265,790																									
				ROOF COVER	1	ASPH SHINGLES	1.00	C	AGR	N	ATT GARAGE	528		43.53	22,982																									
				FLOOR COVER	99	N/A	1.00	D	OPA	N	OPEN PORCH	120		51.50	6,180																									
				INT FINISH	99	N/A	1.00	F21	O	FPL 2S 1OP	1		8,239.00	8,239																										
				HEATING/COOLING	1	FORCED AIR	1.00																																	
				FUEL SOURCE	99	N/A	1.00																																	
				<table border="1"> <thead> <tr> <th>CAPACITY</th> <th>UNITS</th> <th>ADJ</th> </tr> </thead> <tbody> <tr> <td>STORIES</td> <td>1.75</td> <td>1.00</td> </tr> <tr> <td>ROOMS</td> <td>8</td> <td>1.00</td> </tr> <tr> <td>BEDROOMS</td> <td>3</td> <td>1.00</td> </tr> <tr> <td>BATHROOMS</td> <td>2</td> <td>1.00</td> </tr> <tr> <td># 1/2 BATHS</td> <td>0</td> <td>1.00</td> </tr> <tr> <td>TOT FIXTURES</td> <td>6</td> <td>\$5,280</td> </tr> <tr> <td># UNITS</td> <td>1</td> <td>1.00</td> </tr> </tbody> </table>													CAPACITY	UNITS	ADJ	STORIES	1.75	1.00	ROOMS	8	1.00	BEDROOMS	3	1.00	BATHROOMS	2	1.00	# 1/2 BATHS	0	1.00	TOT FIXTURES	6	\$5,280	# UNITS	1	1.00
CAPACITY	UNITS	ADJ																																						
STORIES	1.75	1.00																																						
ROOMS	8	1.00																																						
BEDROOMS	3	1.00																																						
BATHROOMS	2	1.00																																						
# 1/2 BATHS	0	1.00																																						
TOT FIXTURES	6	\$5,280																																						
# UNITS	1	1.00																																						
<table border="1"> <thead> <tr> <th>EFF.YR/AGE</th> <td colspan="2">1985 / 37</td> </tr> </thead> <tbody> <tr> <td>COND</td> <td>26</td> <td>26 %</td> </tr> <tr> <td>FUNC</td> <td>0</td> <td></td> </tr> <tr> <td>ECON</td> <td>0</td> <td></td> </tr> <tr> <td>DEPR</td> <td>26</td> <td>% GD 74</td> </tr> </tbody> </table>																EFF.YR/AGE	1985 / 37		COND	26	26 %	FUNC	0		ECON	0		DEPR	26	% GD 74										
EFF.YR/AGE	1985 / 37																																							
COND	26	26 %																																						
FUNC	0																																							
ECON	0																																							
DEPR	26	% GD 74																																						
<table border="1"> <thead> <tr> <th>RCNLD</th> <td>\$377,500</td> </tr> </thead> </table>																RCNLD	\$377,500																							
RCNLD	\$377,500																																							