

Key: 2003

Town of SCITUATE - Fiscal Year 2024

10/18/2023 5:31 pm SEQ #: 1.927

LEGAL

CURRENT OWNER		PARCEL ID		LOCATION	
CROSIER SCOTT G & MEGHAN A 68 OLD OAKEN BUCKET RD SCITUATE, MA 02066		47-2-14-0		68 OLD OAKEN BUCKET RD	
TRANSFER HISTORY		DOS	T	SALE PRICE	BK-PG (Cert)
CROSIER SCOTT G & MEGHAN		05/23/2016	U	275,000	46956-240
MACPHETRES CHARLOTTE A		03/09/1988	QS	8322-332	
MACPHETRES BRUCE A & CHAR		01/01/1976	XX	4101-232	

CLASS	CLASS%	DESCRIPTION		BN ID	BN	CARD	
1010	100	SINGLE FAMILY			1	1 of 1	
PMT NO	PMT DT	TY	DESC	AMOUNT	INSP	BY	1st %
16-92	03/03/2016	3	ALTERATIONS	20,000	07/22/2016	SJ	100 20
16-92	03/03/2016	3	ALTERATIONS	20,000	08/02/2017	SJ	100 100
93-53	02/01/1993	3	ALTERATIONS				100 100

LAND

CD	T	AC/SF/UN	Ngh	Infl1	Infl2	ADJ BASE	SAF	Infl3	Lpi	VC	CREDIT AMT	ADJ VALUE
100	S	40,000	WS 1.00	100	1.00	374,000	1.00	100	1.00	R03	0.85	343,430
300	A	0.000	WS 1.00	100	1.00	16,830	1.00	100	1.00	R03	0.85	

TOTAL	40,002 SF	ZONING	FRNT	321	ASSESSED	CURRENT	PREVIOUS
Ngh	W. SCITUATE	N O T E IN M52. . . .			LAND	343,400	312,200
Infl1	FACTOR 100		BUILDING	327,200	308,100		
Infl2	PHY 100		DETACHED	0	0		
			OTHER	0	0		
TOTAL						670,600	620,300

DETACHED

TY	QUAL	COND	DIM/NOTE	YB	UNITS	ADJ PRICE	RCNLD

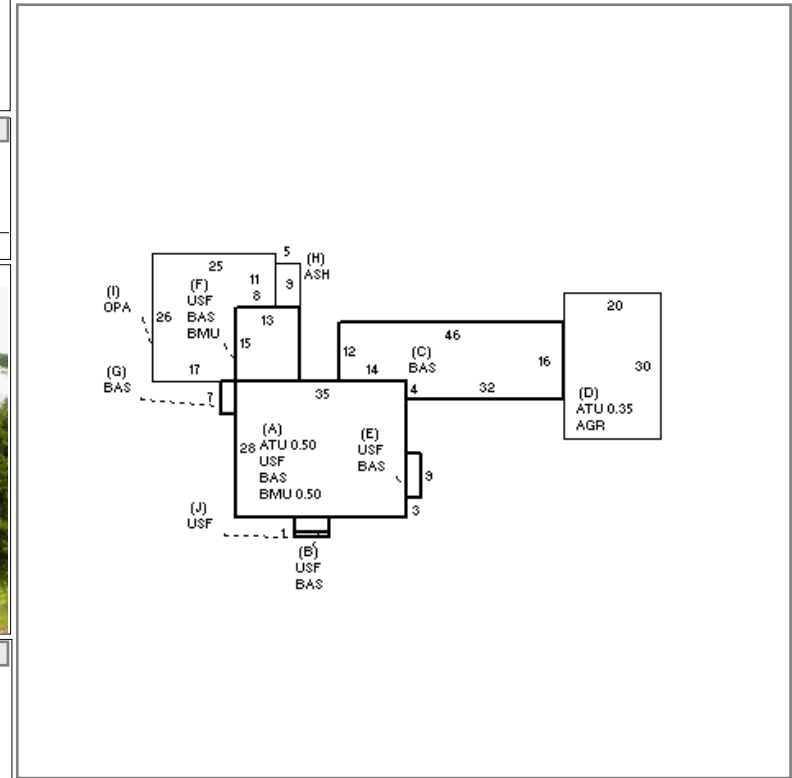

BUILDING

BUILDING	CD	ADJ	DESC	MEASURE	9/22/2010	DR
MODEL	1		RESIDENTIAL	LIST	9/22/2010	EST
STYLE	19	1.15	ANTIQUE [100%]	REVIEW	3/24/2011	KT
QUALITY	G	1.20	GOOD [100%]			
FRAME	1	1.00	WOOD FRAME [100%]			

BLDG COMMENTS

LOADING

YEAR BLT	1804	SIZE ADJ	1.000	ELEMENT	CD	DESCRIPTION	ADJ	S	BAT	T	DESCRIPTION	UNITS	YB	ADJ PRICE	RCN	TOTAL RCN	962,389																														
NET AREA	3,154	DETAIL ADJ	1.173	FOUNDATION	5	BRICK/STONE	1.00	+	BMU	N	BSMT UNFINISHED	685		64.01	43,846																																
\$NLA(RCN)	\$305	OVERALL	1.000	EXT COVER	2	CLAPBOARD	1.00	+	ATU	N	ATTIC UNF	700		44.40	31,080																																
				ROOF SHAPE	1	GABLE	1.00	+	BAS	L	BASE AREA	1,924	1804	264.68	509,237																																
				ROOF COVER	1	ASPH SHINGLES	1.00	D	AGR	N	ATT GARAGE	600		50.70	30,419																																
				FLOOR COVER	99	N/A	1.00	H	ASH	N	ATT SHED	45		26.83	1,207																																
				INT FINISH	99	N/A	1.00	I	OPA	N	OPEN PORCH	530		61.80	32,754																																
				HEATING/COOLING	2	HOT WATER	1.02	+	USF	L	UPPER STORY FIN	1,230	1804	240.69	296,054																																
				FUEL SOURCE	99	N/A	1.00		F31	O	FPL 3S 1OP	1		11,036.40	11,036																																
<table border="1" style="width: 100%;"> <tr> <th colspan="2">CAPACITY</th> <th>UNITS</th> <th>ADJ</th> </tr> <tr> <td>STORIES</td> <td></td> <td>2.5</td> <td>1.00</td> </tr> <tr> <td>ROOMS</td> <td></td> <td>9</td> <td>1.00</td> </tr> <tr> <td>BEDROOMS</td> <td></td> <td>4</td> <td>1.00</td> </tr> <tr> <td>BATHROOMS</td> <td></td> <td>2</td> <td>1.00</td> </tr> <tr> <td># 1/2 BATHS</td> <td></td> <td>0</td> <td>1.00</td> </tr> <tr> <td>TOT FIXTURES</td> <td></td> <td>6</td> <td>\$6,756</td> </tr> <tr> <td># UNITS</td> <td></td> <td>1</td> <td>1.00</td> </tr> </table>																CAPACITY		UNITS	ADJ	STORIES		2.5	1.00	ROOMS		9	1.00	BEDROOMS		4	1.00	BATHROOMS		2	1.00	# 1/2 BATHS		0	1.00	TOT FIXTURES		6	\$6,756	# UNITS		1	1.00
CAPACITY		UNITS	ADJ																																												
STORIES		2.5	1.00																																												
ROOMS		9	1.00																																												
BEDROOMS		4	1.00																																												
BATHROOMS		2	1.00																																												
# 1/2 BATHS		0	1.00																																												
TOT FIXTURES		6	\$6,756																																												
# UNITS		1	1.00																																												
<table border="1" style="width: 100%;"> <tr> <th colspan="2">EFF.YR/AGE</th> <td colspan="2">1951 / 71</td> </tr> <tr> <td>COND</td> <td>66</td> <td colspan="2">66 %</td> </tr> <tr> <td>FUNC</td> <td>0</td> <td colspan="2"></td> </tr> <tr> <td>ECON</td> <td>0</td> <td colspan="2"></td> </tr> <tr> <td>DEPR</td> <td>66</td> <td>% GD</td> <td>34</td> </tr> <tr> <td colspan="2">RCNLD</td> <td colspan="2">\$327,200</td> </tr> </table>																EFF.YR/AGE		1951 / 71		COND	66	66 %		FUNC	0			ECON	0			DEPR	66	% GD	34	RCNLD		\$327,200									
EFF.YR/AGE		1951 / 71																																													
COND	66	66 %																																													
FUNC	0																																														
ECON	0																																														
DEPR	66	% GD	34																																												
RCNLD		\$327,200																																													