

Key: 3266

Town of SCITUATE - Fiscal Year 2024

10/18/2023 5:31 pm SEQ #: 3.148

LEGAL

LAND

DETACHED

BUILDING

CURRENT OWNER				PARCEL ID				LOCATION			
CASWELL JONATHAN & PATRICIA M				28-6-1-0				23 ALDEN AV			
23 ALDEN AVE SCITUATE, MA 02066				TRANSFER HISTORY				DOS	T	SALE PRICE	BK-PG (Cert)
				CASWELL JONATHAN & BANG, JENS & KENNEALLY MARY				02/01/2013	T	423,000	42627-37
								04/26/2010	QS	540,000	38459-246
								01/01/1961	QS	2769-236	

CLASS	CLASS%	DESCRIPTION		BN ID	BN	CARD
1010	100	SINGLE FAMILY			1	1 of 1
PMT NO	PMT DT	TY	DESC	AMOUNT	INSP	BY
95-598	10/01/1995	3	ALTERATIONS			100
92-104	02/11/1992	3	ALTERATIONS			100
91-808	12/02/1991	3	ALTERATIONS			100
89-125	04/01/1989	3	ALTERATIONS			100
		7	OTHERS			100

CD	T	AC/SF/UN	Ngh	Inf1	Inf2	ADJ BASE	SAF	Inf3	Lpi	VC	CREDIT AMT	ADJ VALUE	
100	S	11,283	OS 1.00	100	1.00	100	1.00	704,000	3.19	100	1.00	WF7 1.60	581,810

TOTAL	11,283 SF	ZONING	FRNT	185	ASSESSED	CURRENT	PREVIOUS
Ngh	OCEANSIDE	NOTE	LAND	581,800	528,900		
Inf1	FACTOR 100		BUILDING	180,700	169,600		
Inf2	PHY 100		DETACHED	0	0		
			OTHER	0	0		
			TOTAL	762,500	698,500		

TY	QUAL	COND	DIM/NOTE	YB	UNITS	ADJ PRICE	RCNLD



BLDG COMMENTS

BUILDING	CD	ADJ	DESC	MEASURE	4/13/2009	PL
MODEL	1		RESIDENTIAL	LIST		
STYLE	7	1.20	CONVENTIONAL [100%]	REVIEW	4/6/2011	KT
QUALITY	A	1.00	AVERAGE [100%]			
FRAME	1	1.00	WOOD FRAME [100%]			

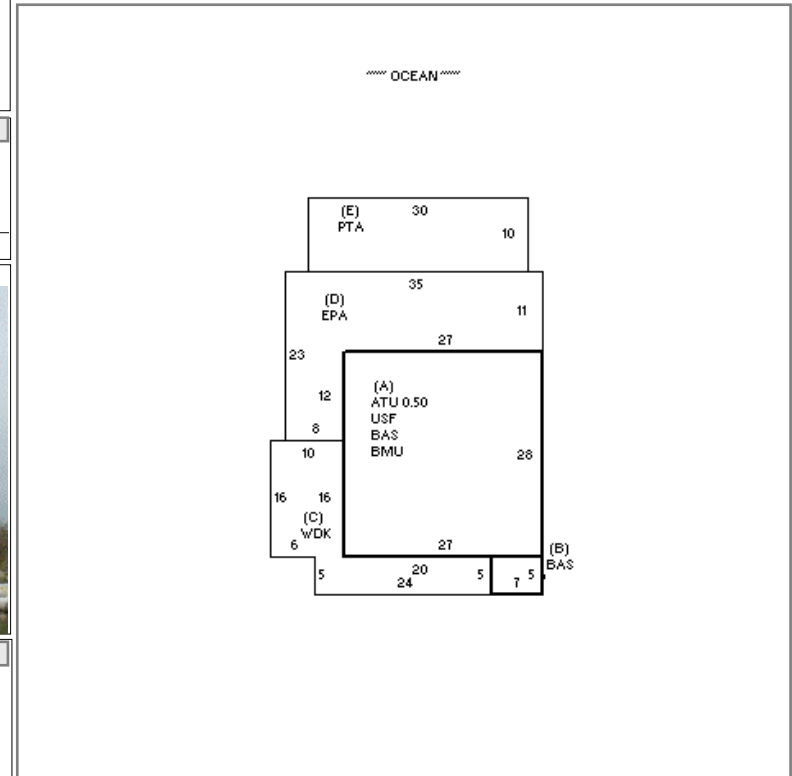

YEAR BLT	1910	SIZE ADJ	1.000	ELEMENT	CD	DESCRIPTION	ADJ	S	BAT	T	DESCRIPTION	UNITS	YB	ADJ PRICE	RCN	TOTAL RCN	501,873		
NET AREA	1,547	DETAIL ADJ	1.198	FOUNDATION	1	PIER	0.98	A	BMU	N	BSMT UNFINISHED	756		51.49	38,925	CONDITION ELEM	CD		
\$NLA(RCN)	\$324	OVERALL	1.000	EXT COVER	1	WD SHINGLES	1.00	A	USF	L	UPPER STORY FIN	756	1910	231.49	175,009	EXTERIOR			
				ROOF SHAPE	1	GABLE	1.00	A	ATU	N	ATTIC UNF	378		37.00	13,986	INTERIOR			
				ROOF COVER	1	ASPH SHINGLES	1.00	+	BAS	L	BASE AREA	791	1910	254.56	201,356	KITCHEN			
				FLOOR COVER	99	N/A	1.00	C	WDK	N	WOOD DECK	280		38.40	10,752	BATHS			
				INT FINISH	99	N/A	1.00	D	EPA	N	ENCLOSED PORCH	481		90.20	43,386	BATHS			
				HEATING/COOLING	2	HOT WATER	1.02	E	PTA	N	PATIO	300		14.90	4,470	HEAT			
				FUEL SOURCE	99	N/A	1.00	F31	O		FPL 3S 10P	1		9,197.00	9,197	ELECT			
																		EFF.YR/AGE	1952 / 70
																		COND	64 64 %
																		FUNC	0
																		ECON	0
																		DEPR	64 % GD 36
																		RCNLD	\$180,700