

Key: 3544

Town of SCITUATE - Fiscal Year 2024

10/18/2023 5:31 pm SEQ #: 3.403

LEGAL

CURRENT OWNER				PARCEL ID				LOCATION			
COOK NICK JAMES 311 TILDEN RD SCITUATE, MA 02066				34-31-29-0				311 TILDEN RD			
TRANSFER HISTORY				DOS	T	SALE PRICE	BK-PG (Cert)				
COOK NICK JAMES				02/01/2021	QS	407,500	54308-25				
JILLETT GAIL F				06/04/2018	H		1 49876-189				
SAFERIAN DIANNE L				09/30/1988	QS	157,000	8742-66				

CLASS	CLASS%	DESCRIPTION			BN ID	BN	CARD	
1010	100	SINGLE FAMILY				1	1 of 1	
PMT NO	PMT DT	TY	DESC	AMOUNT	INSP	BY	1st	%

LAND

CD	T	AC/SF/UN	Ngh	Inf1	Inf2	ADJ BASE	SAF	Inf3	Lpi	VC	CREDIT AMT	ADJ VALUE	
100	S	29,630	OS 1.00	100	1.00	100	1.00	440,000	1.31	100	1.00	R02 1.00	390,940

TOTAL	29,630 SF	ZONING	FRNT	115	ASSESSED	CURRENT	PREVIOUS
Ngh	OCEANSIDE	NOTE			LAND	390,900	355,400
Inf1	FACTOR 100		BUILDING	117,500	109,300		
Inf2	PHY 100		DETACHED	3,000	2,900		
			OTHER	0	0		
					TOTAL	511,400	467,600

DETACHED

TY	QUAL	COND	DIM/NOTE	YB	UNITS	ADJ PRICE	RCNLD
SHF	A	1.00	30 0.70		20	17.03	200
DDK	A	1.00	50 0.50		220	25.43	2,800

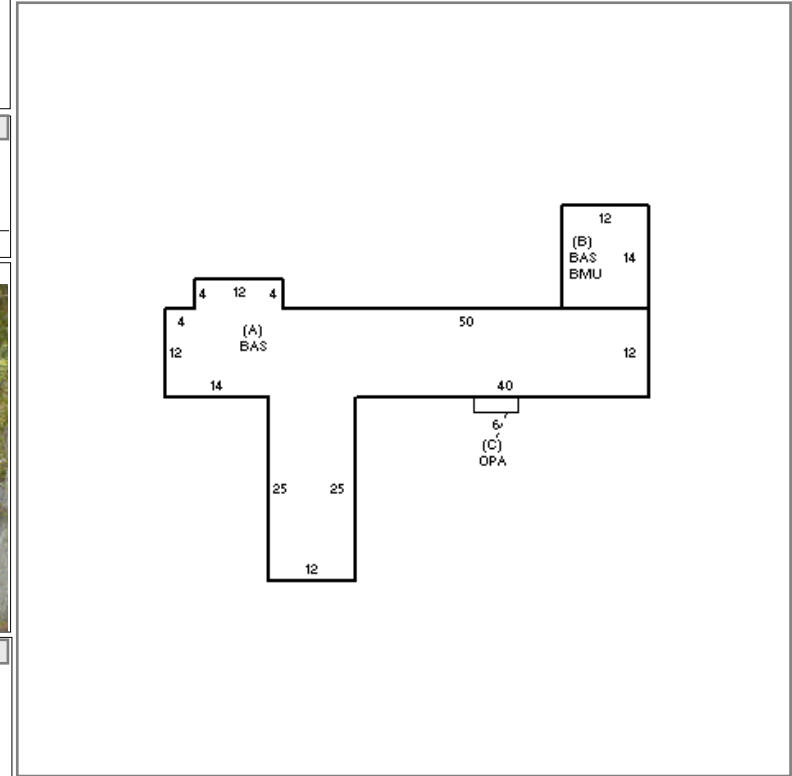

BUILDING

BUILDING	CD	ADJ	DESC	MEASURE	9/10/2010	PL
MODEL	1		RESIDENTIAL	LIST	9/10/2010	EST
STYLE	1	0.85	RANCH [100%]	REVIEW	4/8/2011	ER
QUALITY	A	1.00	AVERAGE [100%]			
FRAME	1	1.00	WOOD FRAME [100%]			

BLDG COMMENTS

BUILDING

YEAR BLT	1930	SIZE ADJ	1.000	ELEMENT	CD	DESCRIPTION	ADJ	S	BAT	T	DESCRIPTION	UNITS	YB	ADJ PRICE	RCN	TOTAL RCN	267,079															
NET AREA	1,308	DETAIL ADJ	0.850	FOUNDATION	4	CONT BSMT WALL	1.00	+	BAS	L	BASE AREA	1,308	1930	187.96	245,851																	
\$NLA(RCN)	\$204	OVERALL	1.000	EXT COVER	1	WD SHINGLES	1.00	B	BMU	N	BSMT UNFINISHED	168		63.15	10,609																	
				ROOF SHAPE	1	GABLE	1.00	C	OPA	N	OPEN PORCH	12		51.50	618																	
				ROOF COVER	1	ASPH SHINGLES	1.00		F11	O	FPL 1S 1OP	1		7,281.00	7,281																	
				FLOOR COVER	2	SOFTWOOD	1.00																									
				INT FINISH	1	PLASTER	1.00																									
				HEATING/COOLING	1	FORCED AIR	1.00																									
				FUEL SOURCE	99	N/A	1.00																									
				<table border="1"> <thead> <tr> <th>CONDITION ELEM</th> <th>CD</th> </tr> </thead> <tbody> <tr> <td>EXTERIOR</td> <td></td> </tr> <tr> <td>INTERIOR</td> <td></td> </tr> <tr> <td>KITCHEN</td> <td></td> </tr> <tr> <td>BATHS</td> <td></td> </tr> <tr> <td>HEAT</td> <td></td> </tr> <tr> <td>ELECT</td> <td></td> </tr> </tbody> </table>														CONDITION ELEM	CD	EXTERIOR		INTERIOR		KITCHEN		BATHS		HEAT		ELECT		
CONDITION ELEM	CD																															
EXTERIOR																																
INTERIOR																																
KITCHEN																																
BATHS																																
HEAT																																
ELECT																																
				<table border="1"> <thead> <tr> <th>EFF.YR/AGE</th> <td colspan="2">1956 / 66</td> </tr> </thead> <tbody> <tr> <td>COND</td> <td>56</td> <td>56 %</td> </tr> <tr> <td>FUNC</td> <td>0</td> <td></td> </tr> <tr> <td>ECON</td> <td>0</td> <td></td> </tr> <tr> <td>DEPR</td> <td>56</td> <td>% GD 44</td> </tr> </tbody> </table>														EFF.YR/AGE	1956 / 66		COND	56	56 %	FUNC	0		ECON	0		DEPR	56	% GD 44
EFF.YR/AGE	1956 / 66																															
COND	56	56 %																														
FUNC	0																															
ECON	0																															
DEPR	56	% GD 44																														
				<table border="1"> <thead> <tr> <th>RCNLD</th> <td>\$117,500</td> </tr> </thead> </table>														RCNLD	\$117,500													
RCNLD	\$117,500																															