

Key: 5305

Town of SCITUATE - Fiscal Year 2024

10/18/2023 5:31 pm SEQ #: 5.049

LEGAL

LAND

DETACHED

BUILDING

CURRENT OWNER				PARCEL ID				LOCATION			
MUIR JEAN M 19 STEWART PL SCITUATE, MA 02066				45-4-4-0				19 STEWART PL			
TRANSFER HISTORY				DOS	T	SALE PRICE	BK-PG (Cert)				
MUIR JEAN M				03/21/2016	F		1 (C21-11)				
MUIR CHRISTIANE				03/21/2016	F		1 (C21-11)				
MUIR JEAN M				12/15/2011	QS	300,000	1 (C-21-8)				

CLASS	CLASS%	DESCRIPTION			BN ID	BN	CARD
1020	100	CONDOMINIUM				1	1 of 1
PMT NO	PMT DT	TY	DESC	AMOUNT	INSP	BY	1st %

CD	T	AC/SF/UN	Ngh	Inf1	Inf2	ADJ BASE	SAF	Inf3	Lpi	VC	CREDIT AMT	ADJ VALUE

TOTAL	SF	ZONING	FRNT	87	ASSESSED	CURRENT	PREVIOUS
Ngh		NOTE			LAND	0	0
Inf1			BUILDING	528,500	478,600		
Inf2			DETACHED	900	0		
			OTHER	0	0		
					TOTAL	529,400	478,600

TY	QUAL	COND	DIM/NOTE	YB	UNITS	ADJ PRICE	RCNLD
SHF	A	1.00 30 0.70	8X10		80	15.97	900



BLDG COMMENTS
BMF=FAM RM/BEDROOM/BATH

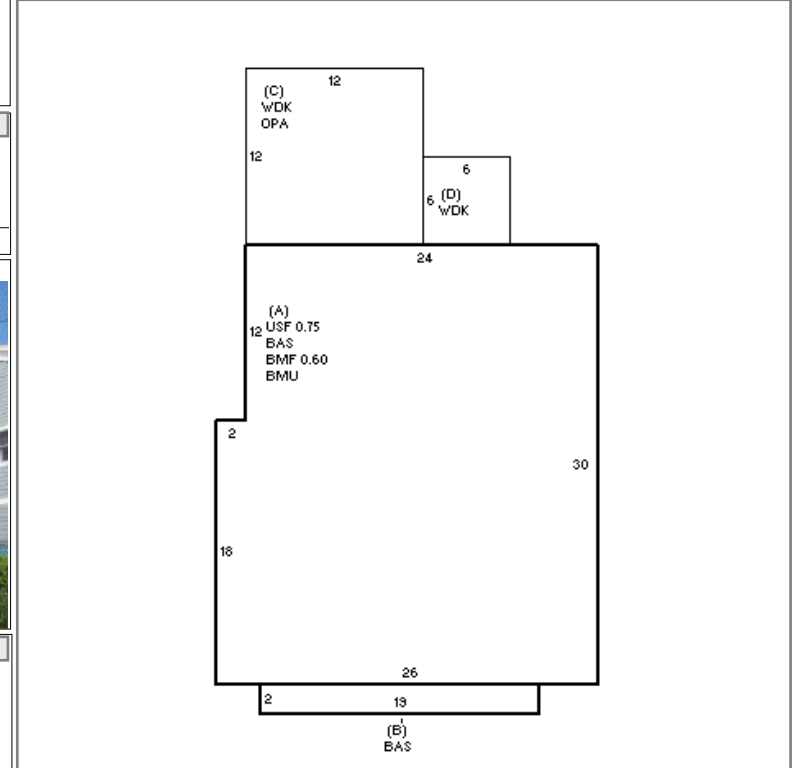

BUILDING	CD	ADJ	DESC	MEASURE	5/8/2023	NC
MODEL	10		CONDO	LIST	5/8/2023	NC
STYLE	1	1.00	CONDO [100%]	REVIEW	6/17/2023	MR
QUALITY	A	1.00	AVERAGE [100%]			
FRAME	1	1.00	WOOD FRAME [100%]			

YEAR BLT	1988	SIZE ADJ	1.000	ELEMENT	CD	DESCRIPTION	ADJ	S	BAT	T	DESCRIPTION	UNITS	YB	ADJ PRICE	RCN
NET AREA	1,361	DETAIL ADJ	1.802	COMPLEX	34	STEWART PLACE	1.75	A	BMU	N	BSMT UNFINISHED	756		22.80	17,237
\$NLA(RCN)	\$436	OVERALL	1.000	STYLE	22	DUPLEX	1.00	A	BMF	N	BSMT FINISH-ADD	454		17.20	7,809
				VIEW/LOC	9	NONE	1.00	A	USF	L	UP-STRY FIN	567	1988	402.66	228,306
				HVAC	11	HW/COOL AIR	1.03	+	BAS	L	BAS AREA	794	1988	402.66	319,710
ROOMS	5	1.00		FUEL SOURCE	2	GAS	1.00	C	OPA	N	OPEN PORCH	144		24.40	3,514
BEDROOMS	2	1.00		FLOOR LEVEL	5	END UNIT	1.00	+	WDK	N	ATT WOOD DECK	180		19.00	3,420
BATHROOMS	2	1.00		CONDO MODEL	99		1.00		BMG	O	BSMT GARAGE	1		2,260.00	2,260
# 1/2 BATHS	1	1.00		INT QUALITY	0		1.00								
TOT FIXTURES	8	\$11,533													

TOTAL RCN	593,789
CONDITION ELEM	CD
INTERIOR	A
KITCHEN	A
BATHS	A
EXTERIOR	A
EFF.YR/AGE	1988 / 34
COND	11 11 %
FUNC	0
ECON	0
DEPR	11 % GD 89
RCNLD	\$528,500