

Key: 7228

Town of SCITUATE - Fiscal Year 2024

10/18/2023 5:31 pm SEQ #: 6.910

LEGAL

LAND

DETACHED

BUILDING

CURRENT OWNER				PARCEL ID				LOCATION			
BARRY KENNETH & MAUREEN & S/O BARRY KENNETH & MAUREEN 156 CENTRAL AV SCITUATE, MA 02066				70-2-11-0				156 CENTRAL AV			
TRANSFER HISTORY				DOS	T	SALE PRICE	BK-PG (Cert)				
BARRY KENNETH & MAUREEN				09/28/2023	A	1	58317-191				
BARRY KENNETH & MAUREEN &				12/01/2009	F	-100	37983-97				
BARRY KENNETH & MAUREEN &				01/30/2004	A	100	27473-316				

CLASS	CLASS%	DESCRIPTION			BN ID	BN	CARD
1010	100	SINGLE FAMILY				1	1 of 1
PMT NO	PMT DT	TY	DESC	AMOUNT	INSP	BY	1st %
93-425	07/19/1993	3	ALTERATIONS				100 100
92-881	12/01/1992	3	ALTERATIONS				100 100
90-436	07/26/1990	3	ALTERATIONS				100 100
90-344	06/20/1990	3	ALTERATIONS				100 100
88-174	04/01/1988	3	ALTERATIONS				100 100

CD	T	AC/SF/UN	Ngh	Inf1	Inf2	ADJ BASE	SAF	Inf3	Lpi	VC	CREDIT AMT	ADJ VALUE	
100	S	4,395 HUM	1.00	100	1.00	100	1.00	550,000	7.83	100	1.00	RV2 1.25	434,490

TOTAL	4,395 SF	ZONING		FRNT	100	ASSESSED	CURRENT	PREVIOUS
Ngh	HUMAROCK	NOTE		LAND	434,500	395,000		
Inf1	FACTOR 100		BUILDING	73,100	71,600			
Inf2	PHY 100		DETACHED	100	100			
			OTHER	0	0			
TOTAL				TOTAL	507,700	466,700		

TY	QUAL	COND	DIM/NOTE	YB	UNITS	ADJ PRICE	RCNLD
SHF	A	1.00 30 0.70			10	17.03	100



BLDG COMMENTS	
---------------	--

BUILDING	CD	ADJ	DESC	MEASURE	4/5/2010	PL
MODEL	1		RESIDENTIAL	LIST	4/5/2010	EST
STYLE	6	0.85	COTT/BUNGALOW [100%]	REVIEW	3/10/2011	ER
QUALITY	A	1.00	AVERAGE [100%]			
FRAME	1	1.00	WOOD FRAME [100%]			

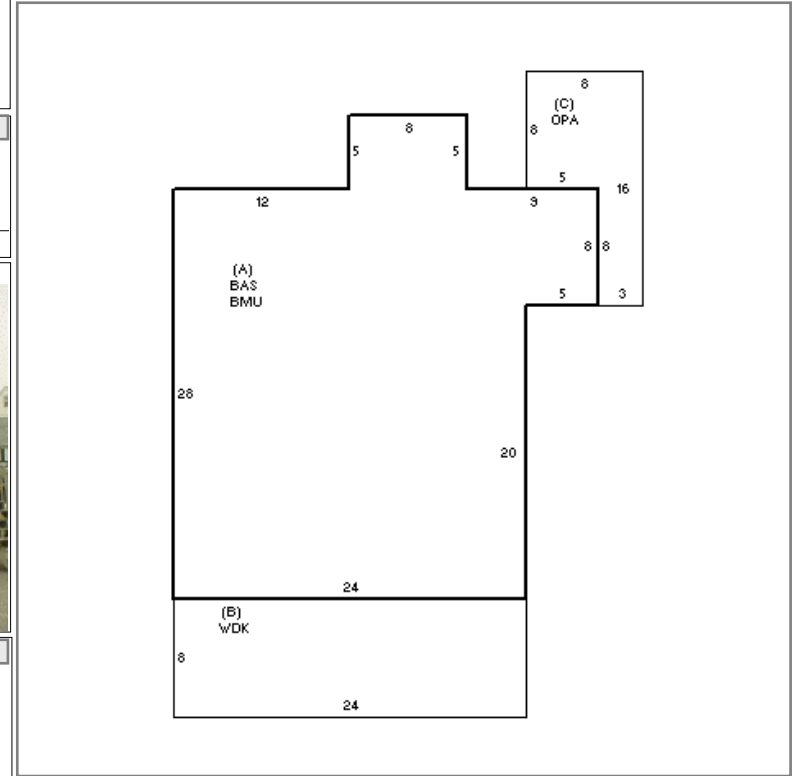

YEAR BLT	1930	SIZE ADJ	1.000	ELEMENT	CD	DESCRIPTION	ADJ	S	BAT	T	DESCRIPTION	UNITS	YB	ADJ PRICE	RCN	TOTAL RCN	203,102																						
NET AREA	752	DETAIL ADJ	0.722	FOUNDATION	4	CONT BSMT WALL	1.00	A	BMU	N	BSMT UNFINISHED	752		51.61	38,814																								
\$NLA(RCN)	\$270	OVERALL	1.000	EXT COVER	1	WD SHINGLES	1.00	A	BAS	L	BASE AREA	752	1930	189.94	142,837																								
				ROOF SHAPE	1	GABLE	1.00	B	WDK	N	WOOD DECK	192		38.40	7,373																								
				ROOF COVER	1	ASPH SHINGLES	1.00	C	OPA	N	OPEN PORCH	88		51.50	4,532																								
				FLOOR COVER	2	SOFTWOOD	1.00		FPL	O	FIREPLACE	1		7,813.00	7,813																								
				INT FINISH	1	PLASTER	1.00																																
				HEATING/COOLING	13	NONE	0.85																																
				FUEL SOURCE	8	NONE	1.00																																
<table border="1"> <tr> <th>CAPACITY</th> <th>UNITS</th> <th>ADJ</th> </tr> <tr> <td>STORIES</td> <td>1</td> <td>1.00</td> </tr> <tr> <td>ROOMS</td> <td>4</td> <td>1.00</td> </tr> <tr> <td>BEDROOMS</td> <td>2</td> <td>1.00</td> </tr> <tr> <td>BATHROOMS</td> <td>1</td> <td>1.00</td> </tr> <tr> <td># 1/2 BATHS</td> <td>0</td> <td>1.00</td> </tr> <tr> <td>TOT FIXTURES</td> <td>3</td> <td>\$1,733</td> </tr> <tr> <td># UNITS</td> <td>1</td> <td>1.00</td> </tr> </table>																CAPACITY	UNITS	ADJ	STORIES	1	1.00	ROOMS	4	1.00	BEDROOMS	2	1.00	BATHROOMS	1	1.00	# 1/2 BATHS	0	1.00	TOT FIXTURES	3	\$1,733	# UNITS	1	1.00
CAPACITY	UNITS	ADJ																																					
STORIES	1	1.00																																					
ROOMS	4	1.00																																					
BEDROOMS	2	1.00																																					
BATHROOMS	1	1.00																																					
# 1/2 BATHS	0	1.00																																					
TOT FIXTURES	3	\$1,733																																					
# UNITS	1	1.00																																					
<table border="1"> <tr> <th>CONDITION ELEM</th> <th>CD</th> </tr> <tr> <td>EXTERIOR</td> <td></td> </tr> <tr> <td>INTERIOR</td> <td></td> </tr> <tr> <td>KITCHEN</td> <td></td> </tr> <tr> <td>BATHS</td> <td></td> </tr> <tr> <td>HEAT</td> <td></td> </tr> <tr> <td>ELECT</td> <td></td> </tr> </table>																CONDITION ELEM	CD	EXTERIOR		INTERIOR		KITCHEN		BATHS		HEAT		ELECT											
CONDITION ELEM	CD																																						
EXTERIOR																																							
INTERIOR																																							
KITCHEN																																							
BATHS																																							
HEAT																																							
ELECT																																							
<table border="1"> <tr> <th>EFF.YR/AGE</th> <td>1952 / 70</td> </tr> <tr> <td>COND</td> <td>64 64 %</td> </tr> <tr> <td>FUNC</td> <td>0</td> </tr> <tr> <td>ECON</td> <td>0</td> </tr> <tr> <td>DEPR</td> <td>64 % GD 36</td> </tr> <tr> <td>RCNLD</td> <td>\$73,100</td> </tr> </table>																EFF.YR/AGE	1952 / 70	COND	64 64 %	FUNC	0	ECON	0	DEPR	64 % GD 36	RCNLD	\$73,100												
EFF.YR/AGE	1952 / 70																																						
COND	64 64 %																																						
FUNC	0																																						
ECON	0																																						
DEPR	64 % GD 36																																						
RCNLD	\$73,100																																						