

Key: 7749

Town of SCITUATE - Fiscal Year 2024

10/18/2023 5:31 pm SEQ #: 7.415

LEGAL

LAND

DETACHED

BUILDING

CURRENT OWNER		PARCEL ID		LOCATION	
SO HUMAROCK BEACH ASSOC P O BOX 534 HUMAROCK, MA 02047		73-15-A-0		8 JULIAN ST	
TRANSFER HISTORY		DOS	T	SALE PRICE	BK-PG (Cert)
SO HUMAROCK BEACH ASSOC			QS		-
SO HUMAROCK BEACH ASSOC			XX		N/A-N/A

CLASS	CLASS%	DESCRIPTION			BN ID	BN	CARD
9520	100	AUX USE				1	1 of 1
PMT NO	PMT DT	TY	DESC	AMOUNT	INSP	BY	1st %

CD	T	AC/SF/UN	Ngh	Inf1	Inf2	ADJ BASE	SAF	Inf3	Lpi	VC	CREDIT AMT	ADJ VALUE	
100	S	8,200	HUM 1.00	100	1.00	100	1.00	550,000	4.32	100	1.00	R08 1.25	446,850

TOTAL	8,200 SF	ZONING		FRNT	91	ASSESSED	CURRENT	PREVIOUS
Ngh	HUMAROCK	NOTE		LAND	446,900	406,200		
Inf1	FACTOR 100		BUILDING	187,800	179,200			
Inf2	PHY 100		DETACHED	0	0			
			OTHER	0	0			
				TOTAL	634,700	585,400		

TY	QUAL	COND	DIM/NOTE	YB	UNITS	ADJ PRICE	RCNLD

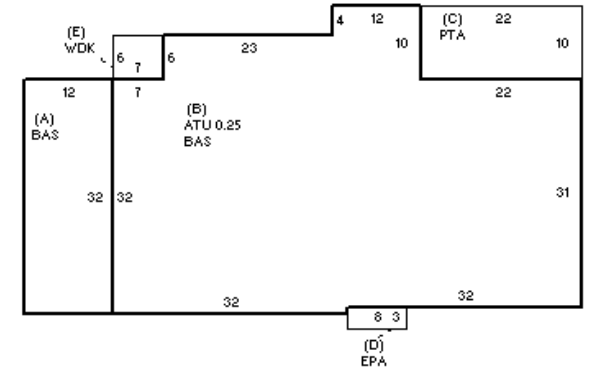

BLDG COMMENTS		
		SO HUMAROCK BEACH ASSOC

BUILDING	CD	ADJ	DESC	MEASURE	10/1/2018	TCK
MODEL	5		CIM-5	LIST	10/1/2018	TCK
STYLE	71	0.60	CLUB/LODGE/HALL [100%]	REVIEW	10/10/2018	MR
QUALITY	A	1.00	AVERAGE [100%]			
FRAME	1	1.00	WOOD FRAME [100%]			

YEAR BLT	1940	SIZE ADJ	1.000	ELEMENT	CD	DESCRIPTION	ADJ	S	BAT	T	DESCRIPTION	UNITS	YB	ADJ PRICE	RCN	TOTAL RCN	293,455
NET AREA	2,658	DETAIL ADJ	0.550	FOUNDATION	3	FOUND. WALL	1.00	A	BAS	L	BASE AREA	384	1940	102.80	39,477	CONDITION ELEM	CD
\$NLA(RCN)	\$110	OVERALL	1.000	EXT. COVER	1	WOOD SHINGLE	1.00	B	BAS	L	BASE AREA	2,274	1940	102.80	233,776	EXTERIOR	A
				ROOF SHAPE	1	GABLE	1.00	B	ATU	N	ATTIC UNF	569		30.00	17,070	INTERIOR	A
				ROOF COVER	1	ASPH/CMP SHIN	1.00	C	PTA	N	PATIO	220		6.00	1,320	CDN/APP	A
				FLOOR COVER	1	HARDWOOD	1.00	D	EPA	N	ENCL PORCH	24		37.00	888		
				INT. FINISH	1	PLASTER	1.04	E	WDK	N	WOOD DECK	42		22.00	924		
				HEATING/COOL	13	NONE	0.95										
				FUEL SOURCE	8	NONE	1.00										
																EFF.YR/AGE	1977 / 45
																COND	36 36 %
																FUNC	0
																ECON	0
																DEPR	36 % GD 64
																RCNLD	\$187,800