

Key: 8356

Town of SCITUATE - Fiscal Year 2024

10/18/2023 5:31 pm SEQ #: 7.967

LAND

Table with columns: CURRENT OWNER, PARCEL ID, LOCATION, TRANSFER HISTORY, DOS, T, SALE PRICE, BK-PG (Cert). Includes owner ISAAC STEPHEN J & DIANE and transfer history from 2013 to 2009.

Table with columns: CLASS, CLASS%, DESCRIPTION, BN ID, BN, CARD. Includes CONDOMINIUM details with PMT NO, PMT DT, TY, DESC, AMOUNT, INSP, BY, 1st, %.

LAND

Table with columns: TOTAL, SF, ZONING, FRNT, ASSESSED, CURRENT, PREVIOUS. Includes ZONING OCEAN/HARBOR VIEW and assessed values for LAND, BUILDING, DETACHED, OTHER.

Table with columns: TY, QUAL, COND, DIM/NOTE, YB, UNITS, ADJ PRICE, RCNLD. Includes a PHOTO of the property dated 05/10/2023.

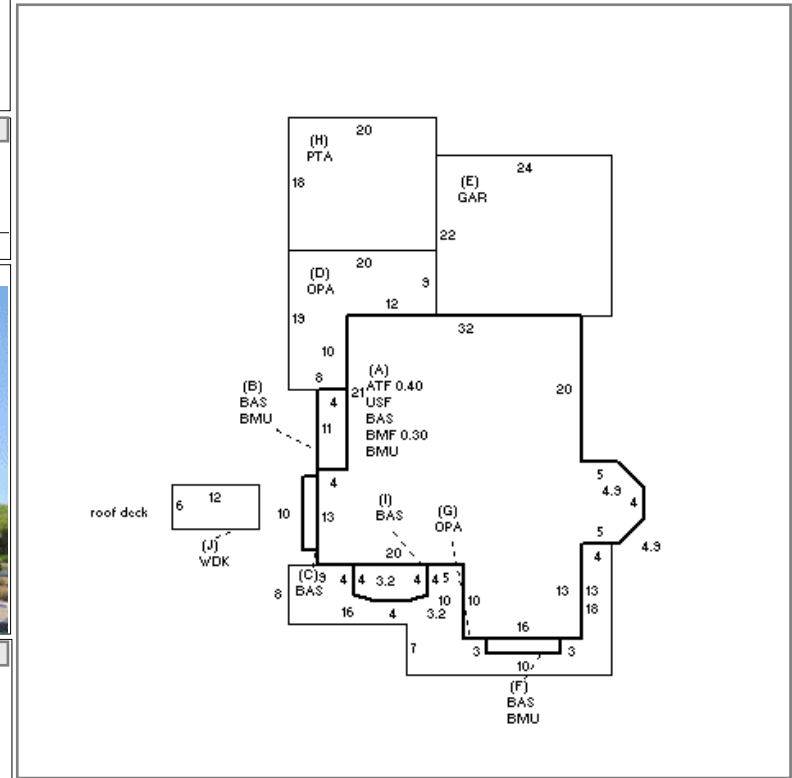

DETACHED

Table with columns: BUILDING, CD, ADJ, DESC, MEASURE, 5/10/2023, NC. Includes BLDG COMMENTS: QUAL=SIZE, 6X12 ROOF DECK.

BUILDING

Main summary table with columns: YEAR BLT, NET AREA, \$NLA(RCN), CAPACITY, UNITS, ADJ, ELEMENT, CD, DESCRIPTION, ADJ, S, BAT, T, DESCRIPTION, UNITS, YB, ADJ PRICE, RCN, TOTAL RCN, CONDITION ELEM, CD, EFF.YR/AGE, COND, FUNC, ECON, DEPR, RCNLD. Includes detailed breakdown of building elements and their associated costs and values.