

Key: 8386

Town of SCITUATE - Fiscal Year 2024

10/18/2023 5:31 pm SEQ #: 7.994

LEGAL

CURRENT OWNER				PARCEL ID				LOCATION			
NELSON DAVID E & ROSEMARY TRS 13 AMY'S WAY SCITUATE, MA 02066				27-7-13-J				13 AMY'S WAY			
TRANSFER HISTORY				DOS	T	SALE PRICE	BK-PG (Cert)				
NELSON DAVID E & ROSEMARY				07/29/2022	F	100	57080-161				
NELSON DAVID E & ROSEMARY				05/14/1990	QS	295,000	9748-317				

CLASS	CLASS%	DESCRIPTION			BN ID	BN	CARD
1010	100	SINGLE FAMILY				1	1 of 1
PMT NO	PMT DT	TY	DESC	AMOUNT	INSP	BY	1st %
96-561	11/18/1996	2	ADDITIONS				100 100
88-375	07/01/1988	1	NEW CONST				100 100
		7	OTHERS				0 0

LAND

CD	T	AC/SF/UN	Ngh	Inf1	Inf2	ADJ BASE	SAF	Inf3	Lpi	VC	CREDIT AMT	ADJ VALUE
100	S	20,034	SC 1.00	100	1.00	616,000	1.87	100	1.00	R06	1.40	528,910

TOTAL	20,034 SF	ZONING	FRNT	152	ASSESSED	CURRENT	PREVIOUS
Ngh	SCITUATE	NOTE			LAND	528,900	377,800
Inf1	FACTOR 100		BUILDING	519,900	481,200		
Inf2	PHY 100		DETACHED	0	0		
			OTHER	0	0		
			TOTAL		1,048,800	859,000	

DETAILED

TY	QUAL	COND	DIM/NOTE	YB	UNITS	ADJ PRICE	RCNLD

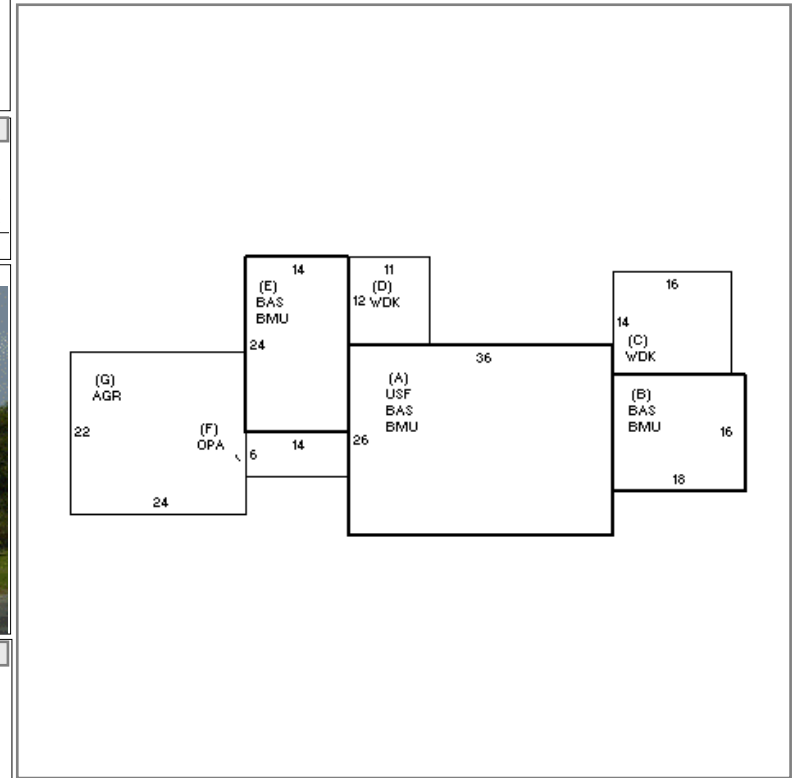

BUILDING

BUILDING	CD	ADJ	DESC	MEASURE	4/10/2009	PL
MODEL	1		RESIDENTIAL	LIST	4/10/2009	EST
STYLE	5	1.00	COLONIAL [100%]	REVIEW	3/3/2011	ER
QUALITY	+	1.10	AVG +/GOOD - [100%]			
FRAME	1	1.00	WOOD FRAME [100%]			

BLDG COMMENTS
FY12 FR-VG TO AVE

INDING

YEAR BLT	1990	SIZE ADJ	1.000	ELEMENT	CD	DESCRIPTION	ADJ	S	BAT	T	DESCRIPTION	UNITS	YB	ADJ PRICE	RCN	TOTAL RCN	658,106																						
NET AREA	2,496	DETAIL ADJ	1.020	FOUNDATION	4	CONT BSMT WALL	1.00	+	BMU	N	BSMT UNFINISHED	1,560		46.54	72,604																								
\$NLA(RCN)	\$264	OVERALL	1.000	EXT COVER	2	CLAPBOARD	1.00	+	BAS	L	BASE AREA	1,560	1990	217.83	339,819																								
				ROOF SHAPE	1	GABLE	1.00	A	USF	L	UPPER STORY FIN	936	1990	198.10	185,417																								
				ROOF COVER	1	ASPH SHINGLES	1.00	+	WDK	N	WOOD DECK	356		42.24	15,037																								
				FLOOR COVER	13	COMB	1.00	F	OPA	N	OPEN PORCH	84		56.65	4,759																								
				INT FINISH	2	DRYWALL	1.00	G	AGR	N	ATT GARAGE	528		47.88	25,280																								
				HEATING/COOLING	2	HOT WATER	1.02	F11	O		FPL 1S 1OP	1		8,009.10	8,009																								
				FUEL SOURCE	99	N/A	1.00																																
<table border="1"> <tr> <th>CAPACITY</th> <th>UNITS</th> <th>ADJ</th> </tr> <tr> <td>STORIES</td> <td>2</td> <td>1.00</td> </tr> <tr> <td>ROOMS</td> <td>8</td> <td>1.00</td> </tr> <tr> <td>BEDROOMS</td> <td>4</td> <td>1.00</td> </tr> <tr> <td>BATHROOMS</td> <td>2</td> <td>1.00</td> </tr> <tr> <td># 1/2 BATHS</td> <td>1</td> <td>1.00</td> </tr> <tr> <td>TOT FIXTURES</td> <td>8</td> <td>\$7,181</td> </tr> <tr> <td># UNITS</td> <td>1</td> <td>1.00</td> </tr> </table>																CAPACITY	UNITS	ADJ	STORIES	2	1.00	ROOMS	8	1.00	BEDROOMS	4	1.00	BATHROOMS	2	1.00	# 1/2 BATHS	1	1.00	TOT FIXTURES	8	\$7,181	# UNITS	1	1.00
CAPACITY	UNITS	ADJ																																					
STORIES	2	1.00																																					
ROOMS	8	1.00																																					
BEDROOMS	4	1.00																																					
BATHROOMS	2	1.00																																					
# 1/2 BATHS	1	1.00																																					
TOT FIXTURES	8	\$7,181																																					
# UNITS	1	1.00																																					
<table border="1"> <tr> <th>CONDITION ELEM</th> <th>CD</th> </tr> <tr> <td>EXTERIOR</td> <td></td> </tr> <tr> <td>INTERIOR</td> <td></td> </tr> <tr> <td>KITCHEN</td> <td></td> </tr> <tr> <td>BATHS</td> <td></td> </tr> <tr> <td>HEAT</td> <td></td> </tr> <tr> <td>ELECT</td> <td></td> </tr> </table>																CONDITION ELEM	CD	EXTERIOR		INTERIOR		KITCHEN		BATHS		HEAT		ELECT											
CONDITION ELEM	CD																																						
EXTERIOR																																							
INTERIOR																																							
KITCHEN																																							
BATHS																																							
HEAT																																							
ELECT																																							
<table border="1"> <tr> <th>EFF.YR/AGE</th> <td colspan="2">2000 / 22</td> </tr> <tr> <td>COND</td> <td>20</td> <td>20 %</td> </tr> <tr> <td>FUNC</td> <td>0</td> <td></td> </tr> <tr> <td>ECON</td> <td>0</td> <td></td> </tr> <tr> <td>DEPR</td> <td>21</td> <td>% GD 79</td> </tr> <tr> <td>RCNLD</td> <td colspan="2">\$519,900</td> </tr> </table>																EFF.YR/AGE	2000 / 22		COND	20	20 %	FUNC	0		ECON	0		DEPR	21	% GD 79	RCNLD	\$519,900							
EFF.YR/AGE	2000 / 22																																						
COND	20	20 %																																					
FUNC	0																																						
ECON	0																																						
DEPR	21	% GD 79																																					
RCNLD	\$519,900																																						