

Key: 1539

Town of TRURO - Fiscal Year 2024

9/27/2023 7:11 pm SEQ #: 1.547

LEGAL

LAND

CURRENT OWNER		PARCEL ID		LOCATION	
MOTTA TODD H & CAROL A PO BOX 262 NO TRURO, MA 02652-0262		40-119-0		20 SO HIGHLAND RD	
TRANSFER HISTORY		DOS	T	SALE PRICE	BK-PG (Cert)
MOTTA TODD H & CAROL A		08/14/1998	QS	70,000	11635-055
MOTTA		08/14/1998	P	70,000	11635-55
THOMPSON ALBERT H HEIRS O		05/15/1998	F		11430-234

CLASS	CLASS%	DESCRIPTION		BN ID	BN	CARD	
1040	100	TWO FAMILY			1	1 of 1	
PMT NO	PMT DT	TY	DESC	AMOUNT	INSP	BY	1st %
FY2018		35	RES EXEMPT		10/01/2017		0 0
98-172	10/01/1998	30	CHECK DATA		07/05/2002	BT	100 100
		1	SINGLE FAM R	150,000	01/01/2000		100 100

CD	T	AC/SF/UN	Nbhd	Inf1	Inf2	ADJ BASE	SAF	Inf3	Lpi	VC	CREDIT AMT	ADJ VALUE
100	A	0.775	12 1.00	1 1.00	1 1.00	360,100	1.00	1 1.00	R04	1.00		279,080
300	A	0.255	12 1.00	1 1.00	1 1.00	27,500	1.00	1 1.00	R04	1.00		7,010

TOTAL	1.030 Acres	ZONING	RES	FRNT	0	ASSESSED	CURRENT	PREVIOUS
Nbhd	EAST TRURO	NOTE				LAND	286,100	248,700
Inf1	NO ADJ		BUILDING	700,500	602,400			
Inf2	NO ADJ		DETACHED	0	0			
			OTHER	0	0			
						TOTAL	986,600	851,100

TY	QUAL	COND	DIM/NOTE	YB	UNITS	ADJ PRICE	RCNLD

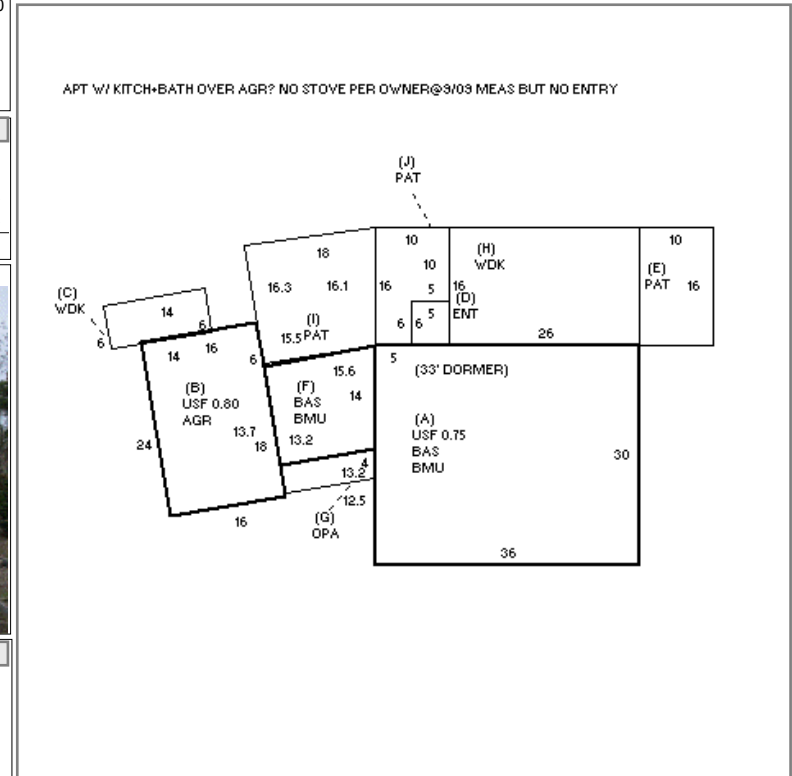

BUILDING	CD	ADJ	DESC	MEASURE	5/10/2017	LG
MODEL	1		RESIDENTIAL	LIST	9/3/2009	EST
STYLE	4	1.10	CAPE [100%]	REVIEW	11/15/2010	MR
QUALITY	A	1.00	AVERAGE [100%]			
FRAME	1	1.00	WOOD FRAME [100%]			

BLDG COMMENTS
FY05 CHGS PER 7/02 CYCLICAL. FY11 CHGS PER 9/09 MEAS.

DETACHED

BU I L D I N G

YEAR BLT	1998	SIZE ADJ	0.995	ELEMENT	CD	DESCRIPTION	ADJ	S	BAT	T	DESCRIPTION	UNITS	YB	ADJ PRICE	RCN	TOTAL RCN	921,684
NET AREA	2,394	DETAIL ADJ	1.000	FOUNDATION			1.00	+	BMU	N	BSMT UNFINISHED	1,277		72.22	92,221		
\$NLA(RCN)	\$385	OVERALL	1.093	EXT. COVER	1	WOOD SHINGLES	1.00	+	BAS	L	BAS AREA	1,277	1998	327.11	417,716		
				ROOF SHAPE	1	GABLE	1.00	+	USF	L	UP-STRY FIN	1,117	1998	252.13	281,634		
				ROOF COVER	1	ASPHALT SHINGLE	1.00	B	AGR	N	ATTACHED GARAGE	384		107.22	41,173		
				FLOOR COVER	1	HARDWOOD	1.00	+	WDK	N	ATT WOOD DECK	500		52.29	26,144		
				INT. FINISH	2	DRYWALL	1.00	D	ENT	N	ENCL ENTRY	30		218.70	6,561		
				HEATING/COOLING	11	HOT WAT.-CL AIR	1.05	+	PAT	N	PATIO	560		14.27	7,993		
				FUEL SOURCE	1	OIL	1.00	G	OPA	N	OPEN PORCH	50		123.00	6,150		
									F21	O	FPL 2S 1OP	1		16,363.10	16,363		
									KIT	O	XTRA KITCHEN	1		18,029.20	18,029		
																CONDITION ELEM	CD
																EFF.YR/AGE	1998 / 24
																COND	24 24 %
																FUNC	0
																ECON	0
																DEPR	24 % GD 76
																RCNLD	\$700,500