

Key: 159

Town of TRURO - Fiscal Year 2024

9/27/2023 7:11 pm SEQ #: 98

LEGAL

Table with columns: CURRENT OWNER, PARCEL ID, LOCATION, TRANSFER HISTORY, DOS, T, SALE PRICE, BK-PG (Cert)

Table with columns: CLASS, CLASS%, DESCRIPTION, BN ID, BN, CARD, PMT NO, PMT DT, TY, DESC, AMOUNT, INSP, BY, 1st, %

LAND

Table with columns: CD, T, AC/SF/UN, Nbh, Inf1, Inf2, ADJ BASE, SAF, Inf3, Lpi, VC, CREDIT AMT, ADJ VALUE

Table with columns: TOTAL, ZONING, LBP, FRNT, ASSESSED, CURRENT, PREVIOUS, Nbh, BEACH POINT, Inf1, NO ADJ, Inf2, NO ADJ, LAND, BUILDING, DETACHED, OTHER, TOTAL

DETACHED

Table with columns: TY, QUAL, COND, DIM/NOTE, YB, UNITS, ADJ PRICE, RCNLD

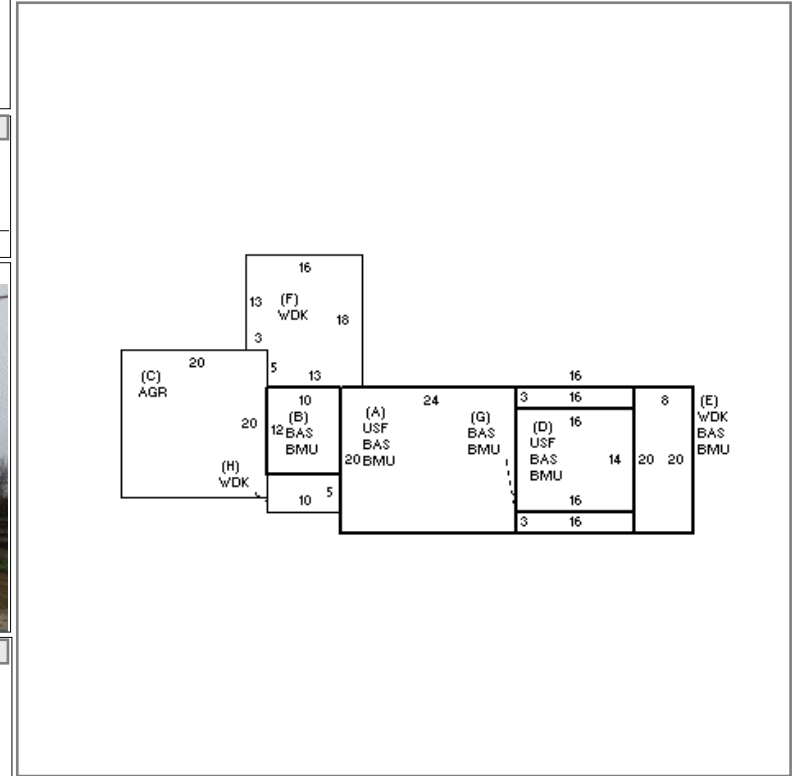

BUILDING

Table with columns: BUILDING, CD, ADJ, DESC, MEASURE, LIST, REVIEW

Table with columns: BLDG COMMENTS

UNIT

Table with columns: YEAR BLT, SIZE ADJ, NET AREA, \$NLA(RCN), CAPACITY, UNITS, ADJ

Table with columns: ELEMENT, CD, DESCRIPTION, ADJ, S, BAT, T, DESCRIPTION, UNITS, YB, ADJ PRICE, RCN

Table with columns: TOTAL RCN, CONDITION ELEM, CD, EFF. YR/AGE, COND, FUNC, ECON, DEPR, RCNLD

Key: 159

Town of TRURO - Fiscal Year 2024

9/27/2023 7:11 pm SEQ #: 99

LEGAL

| | | | | | | | | | | | |
|--|--|--|--|-----------|---|------------|--------------|--------------|--|--|--|
| CURRENT OWNER | | | | PARCEL ID | | | | LOCATION | | | |
| NEAREN & CUBBERLEY NOMINEE TR C/O LEXVEST 627 SHORE, LLC 141 PARKER ST, SUITE 305 MAYNARD, MA 01754 | | | | 3-2-0 | | | | 627 SHORE RD | | | |
| TRANSFER HISTORY | | | | DOS | T | SALE PRICE | BK-PG (Cert) | | | | |

| CLASS | CLASS% | DESCRIPTION | | | BN ID | BN | CARD | |
|--------|--------|---------------|------|--------|-------|----|--------|---|
| 0130 | 75 | MULTI-USE RES | | | | 2 | 2 of 2 | |
| PMT NO | PMT DT | TY | DESC | AMOUNT | INSP | BY | 1st | % |

LAND

| CD | T | AC/SF/UN | Nbhd | Inf1 | Inf2 | ADJ BASE | SAF | Inf3 | Lpi | VC | CREDIT AMT | ADJ VALUE |
|----|---|----------|------|------|------|----------|-----|------|-----|----|------------|-----------|
|----|---|----------|------|------|------|----------|-----|------|-----|----|------------|-----------|

DETACHED

| TOTAL | ZONING | FRNT | ASSESSED | CURRENT | PREVIOUS |
|-------|--------|----------|----------|---------|----------|
| Nbhd | NOTE | | LAND | 36,000 | |
| Inf1 | | BUILDING | | | |
| Inf2 | | DETACHED | | | |
| | | | OTHER | | |
| | | | TOTAL | | |

BUILDING

| TY | QUAL | COND | DIM/NOTE | YB | UNITS | ADJ PRICE | RCNLD | PHOTO |
|----|------|------|----------|----|-------|-----------|-------|------------|
| | | | | | | | | 09/29/2011 |

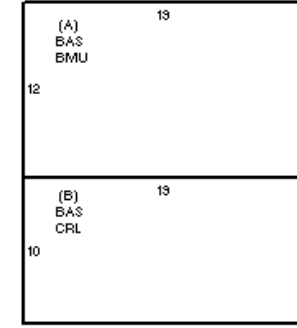

| BUILDING | CD | ADJ | DESC | MEASURE | 9/29/2011 | MR |
|----------|----|------|---------------------|---------|------------|-----|
| MODEL | 1 | | RESIDENTIAL | LIST | 9/29/2011 | EST |
| STYLE | 6 | 0.90 | COTTAGE/BUNG [100%] | REVIEW | 11/15/2011 | DF |
| QUALITY | - | 0.75 | AVE-/LOW+ [100%] | | | |
| FRAME | 1 | 1.00 | WOOD FRAME [100%] | | | |

| ELEMENT | CD | DESCRIPTION | ADJ | S | BAT | T | DESCRIPTION | UNITS | YB | ADJ PRICE | RCN |
|-----------------|----|-----------------|------|---|-----|---|-----------------|-------|------|-----------|--------|
| FOUNDATION | 4 | BSMT WALL | 1.00 | A | BMU | N | BSMT UNFINISHED | 228 | | 52.08 | 11,873 |
| EXT. COVER | 1 | WOOD SHINGLES | 1.00 | + | BAS | L | BAS AREA | 418 | 1940 | 193.64 | 80,943 |
| ROOF SHAPE | 1 | GABLE | 1.00 | B | CRL | N | CRAWL SPACE | 190 | | 26.15 | 4,968 |
| ROOF COVER | 1 | ASPHALT SHINGLE | 1.00 | | | | | | | | |
| FLOOR COVER | 3 | W/W CARPET | 1.00 | | | | | | | | |
| INT. FINISH | 2 | DRYWALL | 1.00 | | | | | | | | |
| HEATING/COOLING | 5 | ELECTRIC | 0.95 | | | | | | | | |
| FUEL SOURCE | 3 | ELECTRIC | 1.00 | | | | | | | | |

| | | | | | | | | | | | | | |
|---------------|--|--|--|--|--|--|--|--|--|--|----------------|-----------|----|
| BLDG COMMENTS | | | | | | | | | | | TOTAL RCN | 99,885 | |
| | | | | | | | | | | | CONDITION ELEM | | CD |
| | | | | | | | | | | | EFF.YR/AGE | 1950 / 72 | |
| | | | | | | | | | | | COND | 64 64 % | |
| | | | | | | | | | | | FUNC | 0 | |
| | | | | | | | | | | | ECON | 0 | |
| | | | | | | | | | | | DEPR | 64 % GD | 36 |
| | | | | | | | | | | | RCNLD | \$36,000 | |