

Key: 1731

Town of TRURO - Fiscal Year 2024

9/27/2023 7:11 pm SEQ #: 1.742

LEGAL

CURRENT OWNER				PARCEL ID				LOCATION			
WABER THOMAS E & GAIL J SANSON 408A SACKETT ST BROOKLYN, NY 11231				42-148-47				7 GREAT HOLLOW RD			
TRANSFER HISTORY				DOS	T	SALE PRICE		BK-PG (Cert)			
WABER THOMAS E & GAIL J S				12/21/1993	QS	53,000		8961-088			

CLASS	CLASS%	DESCRIPTION			BN ID	BN	CARD	
1020	100	CONDOMINIUM				1	1 of 1	
PMT NO	PMT DT	TY	DESC	AMOUNT	INSP	BY	1st	%
CYC 09-116	05/26/2023	30	CHECK DATA		04/14/2023	LG	100	100
07-122	06/26/2009	6	SHED	1,200	05/20/2010	JH	100	100
	06/13/2007	90	BP NVC	2,491	05/19/2008	JH	100	100

LAND

CD	T	AC/SF/UN	Nbhd	Inf1	Inf2	ADJ BASE	SAF	Inf3	Lpi	VC	CREDIT AMT	ADJ VALUE

TOTAL	SF	ZONING	GR6	FRNT	0	ASSESSED	CURRENT	PREVIOUS
Nbhd		WHITMAN HOUSE CONDO				LAND	0	0
Inf1		NOTE				BUILDING	414,800	356,700
Inf2						DETACHED	300	300
						OTHER	0	0
						<b>TOTAL</b>	<b>415,100</b>	<b>357,000</b>

DETACHED

TY	QUAL	COND	DIM/NOTE	YB	UNITS	ADJ PRICE	RCNLD
SHF	A	G	3*6	2009	18	17.17	300



BLDG COMMENTS

BUILDING

BUILDING	CD	ADJ	DESC	MEASURE	3/28/2023	LG
MODEL	10		CONDO	LIST	4/14/2023	LG
STYLE	1	1.00	CONDO [100%]	REVIEW	7/16/2007	RJM
QUALITY	A	1.00	AVERAGE [100%]			
FRAME	1	1.00	WOOD FRAME [100%]			

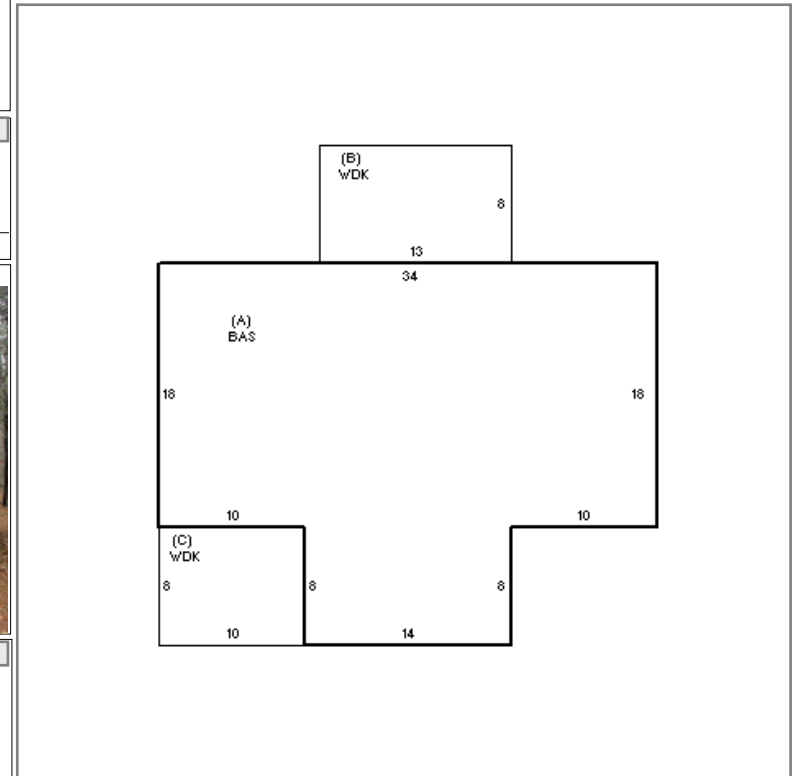

G

YEAR BLT	1966	SIZE ADJ	0.930	ELEMENT	CD	DESCRIPTION	ADJ	S	BAT	T	DESCRIPTION	UNITS	YB	ADJ PRICE	RCN	TOTAL RCN	488.030		
NET AREA	724	DETAIL ADJ	0.784	COMPLEX	19	WHITMAN HOUSE	0.80	A	BAS	L	BASE CONDO AREA	724	1966	661.90	479,214	CONDITION ELEM	CD		
\$NLA(RCN)	\$674	OVERALL	1.000	CONDO STYLE	4	COTTAGE	1.00	+	WDK	N	ATT WOOD DECK	184		36.50	6,716	EXTERIOR	A		
				BASEMENT	4	CRAWL	1.00											INTERIOR	A
				HEATING	5	ELECTRIC	0.98											KITCHEN	U
				FUEL SOURCE	3	ELECTRIC	1.00											BATHS	A
				PLUMBING	1	STANDARD	1.00											HEAT/ELEC	A
				VIEW/LOC	99	N/A	1.00											EFF.YR/AGE	1974 / 48
																	COND	15 15%	
																	FUNC	0	
																	ECON	0	
																	DEPR	15 % GD 85	
																	RCNLD	\$414,800	