

Key: 1913

Town of TRURO - Fiscal Year 2024

9/27/2023 7:11 pm SEQ #: 1.937

LEG
AL
LAND

CURRENT OWNER				PARCEL ID				LOCATION				
TUCK MICHAEL R PO BOX 780 TRURO, MA 02666-0780				43-36-0				17 QUAIL RIDGE RD				
				TRANSFER HISTORY				DOS	T	SALE PRICE	BK-PG (Cert)	
				TUCK MICHAEL R				08/28/1981	99		3351-044	

CLASS	CLASS%	DESCRIPTION			BN ID	BN	CARD	
1010	100	SINGLE FAMILY				1	1 of 1	
PMT NO	PMT DT	TY	DESC	AMOUNT	INSP	BY	1st	%
FY2018		35	RES EXEMPT		12/04/2017			0
		30	CHECK DATA		05/24/2002	BT	100	100
90-002	01/03/1990	1	SINGLE FAM R	140,000	09/04/1990		100	100

CD	T	AC/SF/UN	Nbhd	Inf1	Inf2	ADJ BASE	SAF	Inf3	Lpi	VC	CREDIT AMT	ADJ VALUE
100	A	0.775	12	1.00	1	1.00	1	1.00	R03	1.00		279,080
300	A	0.055	12	1.00	1	1.00	1	1.00	R03	1.00		1,510

TOTAL	36,155 SF	ZONING	RES	FRNT	0	ASSESSED	CURRENT	PREVIOUS
Nbhd	EAST TRURO	NOTE				LAND	280,600	244,000
Inf1	NO ADJ		BUILDING	491,000	398,800			
Inf2	NO ADJ		DETACHED	0	0			
			OTHER	0	0			
						TOTAL	771,600	642,800

TY	QUAL	COND	DIM/NOTE	YB	UNITS	ADJ PRICE	RCNLD



BLDG COMMENTS
LLF=HEATED FAM RM+2 BR'S (SLAB FLOOR) AND FULL BATH (TILE FLOOR). LLF HAS EGRESS WINDOW.

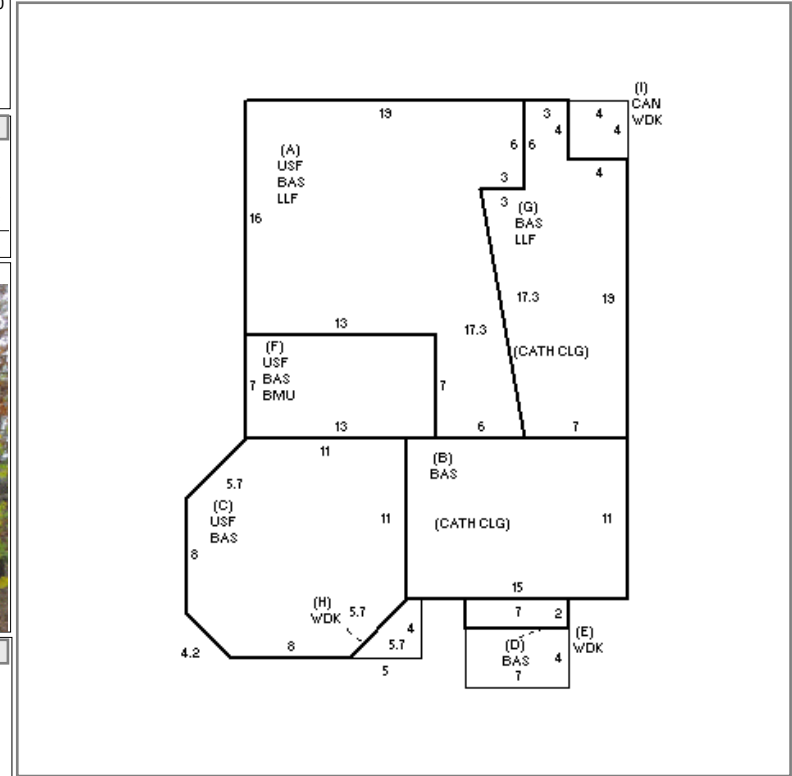

DET
ACHED

BU
ILD
ING

BUILDING	CD	ADJ	DESC	MEASURE	11/12/2021	LG
MODEL	1		RESIDENTIAL	LIST	11/18/2021	LG
STYLE	5	1.05	COLONIAL [100%]	REVIEW	11/29/2010	MR
QUALITY	+	1.15	GOOD-AVE+ [100%]			
FRAME	1	1.00	WOOD FRAME [100%]			

YEAR BLT	1990	SIZE ADJ	1.000
NET AREA	2,076	DETAIL ADJ	1.005
\$NLA(RCN)	\$338	OVERALL	1.070
CAPACITY		UNITS	ADJ
STORIES(FAR)		2	1.00
ROOMS		9	1.00
BEDROOMS		5	1.00
BATHROOMS		2.5	1.00
FIXTURES		8	\$5,600
UNITS		0	1.00

ELEMENT	CD	DESCRIPTION	ADJ	S	BAT	T	DESCRIPTION	UNITS	YB	ADJ PRICE	RCN
FOUNDATION	4	BSMT WALL	1.00	+	LLF	L	LOWER LEVEL FIN	492	1990	256.09	125,995
EXT. COVER	2	CLAPBOARD	1.00	+	USF	L	UP-STRY FIN	617	1990	291.22	179,684
ROOF SHAPE	1	GABLE	1.00	+	BAS	L	BAS AREA	336	1990	373.77	125,587
ROOF COVER	1	ASPHALT SHINGLE	1.00	+	BAS	L	BAS AREA	631	1990	373.77	235,850
FLOOR COVER	2	SOFTWOOD	1.00	+	WDK	N	ATT WOOD DECK	56		96.13	5,383
INT. FINISH	2	DRYWALL	1.00	F	BMU	N	BSMT UNFINISHED	91		100.52	9,148
HEATING/COOLING	2	HOT WATER	1.02	I	CAN	N	CANOPY	16		57.29	917
FUEL SOURCE	1	OIL	1.00	F11	O		FPL 1S 10P	1		13,330.00	13,330

TOTAL RCN	701,493
CONDITION ELEM	CD
EFF.YR/AGE	1990 / 32
COND	30 30%
FUNC	0
ECON	0
DEPR	30 % GD 70
RCNLD	\$491,000