

Key: 2116

Town of TRURO - Fiscal Year 2024

9/27/2023 7:11 pm SEQ #: 2.153

LEGAL LAND

| CURRENT OWNER | | | | PARCEL ID | | | | LOCATION | | | | | |
|--|---|----------|------|------------|------|------------|--------------|------------------|---------|------|------------|-----------|---------|
| AUFIERO PHILIP 10 EVAN PL ARMONK, NY 10504 | | | | 45-30-0 | | | | 7 CORN HILL LNDG | | | | | |
| TRANSFER HISTORY | | | | DOS | T | SALE PRICE | BK-PG (Cert) | | | | | | |
| AUFIERO PHILIP | | | | 01/18/1982 | 99 | | 3423-275 | | | | | | |
| CD | T | AC/SF/UN | Nbhd | Inf1 | Inf2 | ADJ BASE | SAF | Inf3 | Lpi | VC | CREDIT AMT | ADJ VALUE | |
| 100 | A | 0.775 | 13 | 1.00 | 1 | 1.00 | 1 | 1.00 | 576,160 | 1.00 | 1 | 1.00 | 446,520 |
| 300 | A | 0.015 | 13 | 1.00 | 1 | 1.00 | 1 | 1.00 | 44,000 | 1.00 | 1 | 1.00 | 660 |

| CLASS | CLASS% | DESCRIPTION | | | BN ID | BN | CARD | |
|--------|------------|---------------|--------------|--------|------------|----|--------|-----|
| 1010 | 100 | SINGLE FAMILY | | | | 1 | 1 of 1 | |
| PMT NO | PMT DT | TY | DESC | AMOUNT | INSP | BY | 1st | % |
| 13-047 | 03/12/2013 | 90 | BP NVC | 1,895 | | | 100 | 100 |
| 12-014 | 01/25/2012 | 3 | REPAIR/REMOD | 30,000 | 12/11/2012 | FC | 100 | 100 |
| 11-265 | 12/16/2011 | 90 | BP NVC | 35,000 | 12/11/2012 | FC | 100 | 100 |
| 09-035 | 03/16/2009 | 9 | DECK | 8,900 | 05/24/2010 | JH | 100 | 100 |
| 89-112 | 08/01/1989 | 9 | DECK | 10,000 | 12/31/1989 | | 100 | 100 |

DETACHED

| | | | | | | | | |
|-------|-----------|--------|-----|------|---|----------|-----------|----------|
| TOTAL | 34,413 SF | ZONING | RES | FRNT | 0 | ASSESSED | CURRENT | PREVIOUS |
| Nbhd | CORN HILL | NOTE | | | | LAND | 447,200 | 388,800 |
| Inf1 | NO ADJ | | | | | BUILDING | 651,500 | 536,300 |
| Inf2 | NO ADJ | | | | | DETACHED | 11,000 | 10,500 |
| | | | | | | OTHER | 0 | 0 |
| | | | | | | TOTAL | 1,109,700 | 935,600 |

| TY | QUAL | COND | DIM/NOTE | YB | UNITS | ADJ PRICE | RCNLD | |
|-----|------|------|----------|-------|-------|-----------|----------|-------|
| SPV | A | 1.00 | E 1.00 | 12*29 | 1989 | 348 | 25.75 | 9,000 |
| HTB | A | 1.00 | A 0.75 | | | 1 | 2,730.40 | 2,000 |



| BUILDING | CD | ADJ | DESC | MEASURE | 2/7/2019 | LG |
|----------|----|------|---------------------|---------|-----------|----|
| MODEL | 1 | | RESIDENTIAL | LIST | 5/24/2010 | JH |
| STYLE | 8 | 1.10 | CONTEMPORARY [100%] | REVIEW | 12/3/2010 | MR |
| QUALITY | + | 1.15 | GOOD-AVE+ [100%] | | | |
| FRAME | 1 | 1.00 | WOOD FRAME [100%] | | | |

BLDG COMMENTS

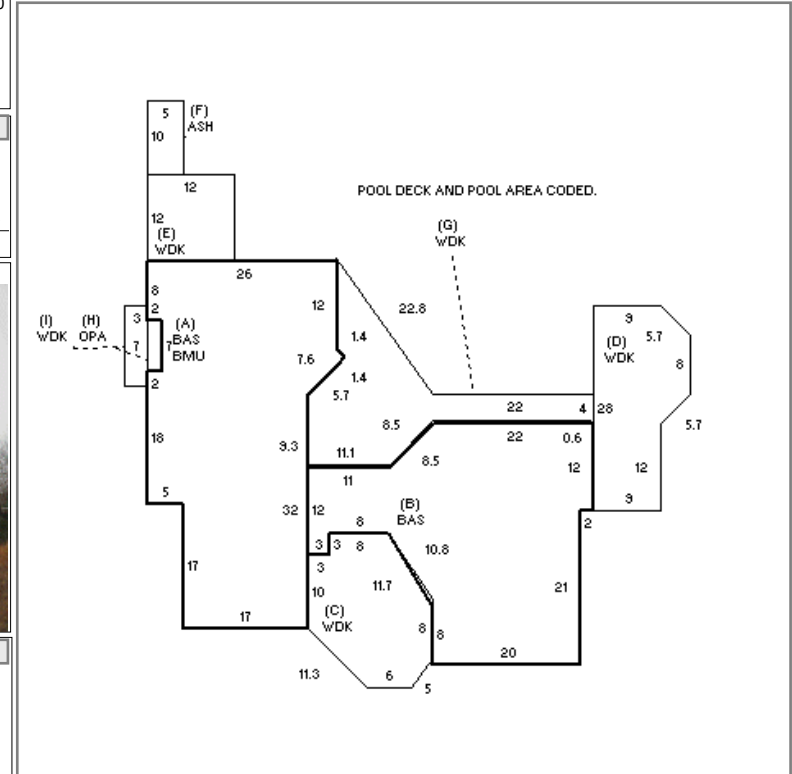

BUILDING

| YEAR BLT | 1986 | SIZE ADJ | 1.010 |
|--------------|-------|------------|---------|
| NET AREA | 1,960 | DETAIL ADJ | 1.000 |
| \$NLA(RCN) | \$482 | OVERALL | 1.060 |
| CAPACITY | | UNITS | ADJ |
| STORIES(FAR) | | 1 | 1.00 |
| ROOMS | | 0 | 1.00 |
| BEDROOMS | | 3 | 1.00 |
| BATHROOMS | | 2 | 1.00 |
| FIXTURES | | 6 | \$4,200 |
| UNITS | | 0 | 1.00 |

| ELEMENT | CD | DESCRIPTION | ADJ | S | BAT | T | DESCRIPTION | UNITS | YB | ADJ PRICE | RCN |
|-----------------|----|---------------|------|-----|-----|---|-----------------|-------|------|-----------|---------|
| FOUNDATION | 4 | BSMT WALL | 1.00 | A | BMU | N | BSMT UNFINISHED | 1,066 | | 84.95 | 90,559 |
| EXT. COVER | 2 | CLAPBOARD | 1.00 | + | BAS | L | BAS AREA | 1,960 | 1986 | 359.32 | 704,258 |
| ROOF SHAPE | 1 | GABLE | 1.00 | + | WDK | N | ATT WOOD DECK | 1,114 | | 55.50 | 61,823 |
| ROOF COVER | 2 | WOOD SHINGLES | 1.01 | F | ASH | N | ATT SHED | 50 | | 51.59 | 2,579 |
| FLOOR COVER | 1 | HARDWOOD | 1.00 | H | OPA | N | OPEN PORCH | 14 | | 172.89 | 2,421 |
| INT. FINISH | 2 | DRYWALL | 1.00 | WDK | N | N | ATT WOOD DECK | 1,172 | | 55.50 | 65,041 |
| HEATING/COOLING | 5 | ELECTRIC | 0.95 | F11 | O | O | FPL 1S IOP | 1 | | 13,337.50 | 13,338 |
| FUEL SOURCE | 3 | ELECTRIC | 1.00 | ODS | O | O | OUT DOOR SHOWER | | | 0.00 | |

| | |
|----------------|------------|
| TOTAL RCN | 944,218 |
| CONDITION ELEM | CD |
| EFF.YR/AGE | 1987 / 35 |
| COND | 31 31 % |
| FUNC | 0 |
| ECON | 0 |
| DEPR | 31 % GD 69 |
| RCNLD | \$651,500 |