

Key: 2282

Town of TRURO - Fiscal Year 2024

9/27/2023 7:11 pm SEQ #: 2.328

LEGALLAND

| CURRENT OWNER   |  |  |  | PARCEL ID  |    |            |              | LOCATION           |  |  |  |
|---|--|--|--|------------|----|------------|--------------|--------------------|--|--|--|
| MILLER LUCAS J<br>200 SIXTH AVE<br>NEW YORK, NY 10013 |  |  |  | 46-54-0    |    |            |              | 1 LITTLE PAMET WAY |  |  |  |
| TRANSFER HISTORY                                      |  |  |  | DOS        | T  | SALE PRICE | BK-PG (Cert) |                    |  |  |  |
| MILLER LUCAS J  |  |  |  | 04/26/2007 | 99 |            | 21971-19     |                    |  |  |  |
| MILLER RICHARD H & JOAN M                             |  |  |  | 02/08/1993 | O  | 187,000    | 8437-154     |                    |  |  |  |

| CLASS  | CLASS%     | DESCRIPTION   |            |        | BN ID      | BN | CARD   |     |
|--------|------------|---------------|------------|--------|------------|----|--------|-----|
| 1010   | 100        | SINGLE FAMILY |            |        |            | 1  | 1 of 1 |     |
| PMT NO | PMT DT     | TY            | DESC       | AMOUNT | INSP       | BY | 1st    | %   |
| 15-192 | 07/29/2015 | 90            | BP NVC     | 2,600  |            |    | 100    | 100 |
|        |            | 30            | CHECK DATA |        | 08/22/2002 | BT | 100    | 100 |
| 02-133 | 06/20/2002 | 10            | ALL OTHERS | 1,000  |            |    | 100    | 100 |
| 93-119 | 09/27/1993 | 10            | ALL OTHERS | 6,500  | 05/02/1994 |    | 100    | 100 |
| 93-68  | 06/18/1993 | 9             | DECK       | 9,000  | 05/02/1994 |    | 100    | 100 |

| CD  | T | AC/SF/UN | Nbhd | Inf1 | Inf2 | ADJ BASE | SAF | Inf3 | Lpi | VC   | CREDIT AMT | ADJ VALUE |
|-----|---|----------|------|------|------|----------|-----|------|-----|------|------------|-----------|
| 100 | A | 0.775    | 14   | 1.00 | 1    | 1.00     | 1   | 1.00 | RF1 | 1.75 |            | 488,390   |
| 300 | A | 1.025    | 14   | 1.00 | 1    | 1.00     | 1   | 1.00 | RF1 | 1.75 |            | 49,330    |

| TOTAL | 1.800 Acres  | ZONING | RES | FRNT | 0 | ASSESSED     | CURRENT          | PREVIOUS       |
|-------|--------------|--------|-----|------|---|--------------|------------------|----------------|
| Nbhd  | TRURO CENTER | NOTE   |     |      |   | LAND         | 537,700          | 467,500        |
| Inf1  | NO ADJ       |        |     |      |   | BUILDING     | 499,100          | 423,400        |
| Inf2  | NO ADJ       |        |     |      |   | DETACHED     | 300              | 300            |
|       |              |        |     |      |   | OTHER        | 0                | 0              |
|       |              |        |     |      |   | <b>TOTAL</b> | <b>1,037,100</b> | <b>891,200</b> |

| TY  | QUAL | COND | DIM/NOTE          | YB | UNITS | ADJ PRICE | RCNLD |
|-----|------|------|-------------------|----|-------|-----------|-------|
| OSH | A    | 1.00 | A 0.75 3*8        |    | 24    | 6.90      | 100   |
| OSH | A    | 1.00 | A 0.75 TREE HOUSE |    | 48    | 6.90      | 200   |



| BUILDING | CD | ADJ  | DESC                | MEASURE | 2/16/2021  | LG |
|----------|----|------|---------------------|---------|------------|----|
| MODEL    | 1  |      | RESIDENTIAL         | LIST    | 8/30/2012  | FC |
| STYLE    | 8  | 1.10 | CONTEMPORARY [100%] | REVIEW  | 12/16/2010 | MR |
| QUALITY  | A  | 1.00 | AVERAGE [100%]      |         |            |    |
| FRAME    | 1  | 1.00 | WOOD FRAME [100%]   |         |            |    |

| ELEMENT         | CD | DESCRIPTION   | ADJ  | S   | BAT | T | DESCRIPTION     | UNITS | YB   | ADJ PRICE | RCN     |
|-----------------|----|---------------|------|-----|-----|---|-----------------|-------|------|-----------|---------|
| FOUNDATION      | 4  | BSMT WALL     | 1.00 | +   | BAS | L | BAS AREA        | 1,896 | 1971 | 312.45    | 592,402 |
| EXT. COVER      | 8  | TEX PLYWOOD   | 1.00 | +   | WDK | N | ATT WOOD DECK   | 731   |      | 48.26     | 35,276  |
| ROOF SHAPE      | 1  | GABLE         | 1.00 | G   | OPA | N | OPEN PORCH      | 30    |      | 121.08    | 3,633   |
| ROOF COVER      | 2  | WOOD SHINGLES | 1.01 | H   | BMU | N | BSMT UNFINISHED | 300   |      | 87.46     | 26,237  |
| FLOOR COVER     | 1  | HARDWOOD      | 1.00 | I   | LLU | N | LOWER LEVEL UNF | 300   |      | 166.61    | 49,984  |
| INT. FINISH     | 2  | DRYWALL       | 1.00 | F11 | O   |   | FPL 1S 1OP      | 1     |      | 11,597.80 | 11,598  |
| HEATING/COOLING | 5  | ELECTRIC      | 0.95 | ODS | O   |   | OUT DOOR SHOWER |       |      | 0.00      |         |
| FUEL SOURCE     | 3  | ELECTRIC      | 1.00 |     |     |   |                 |       |      |           |         |

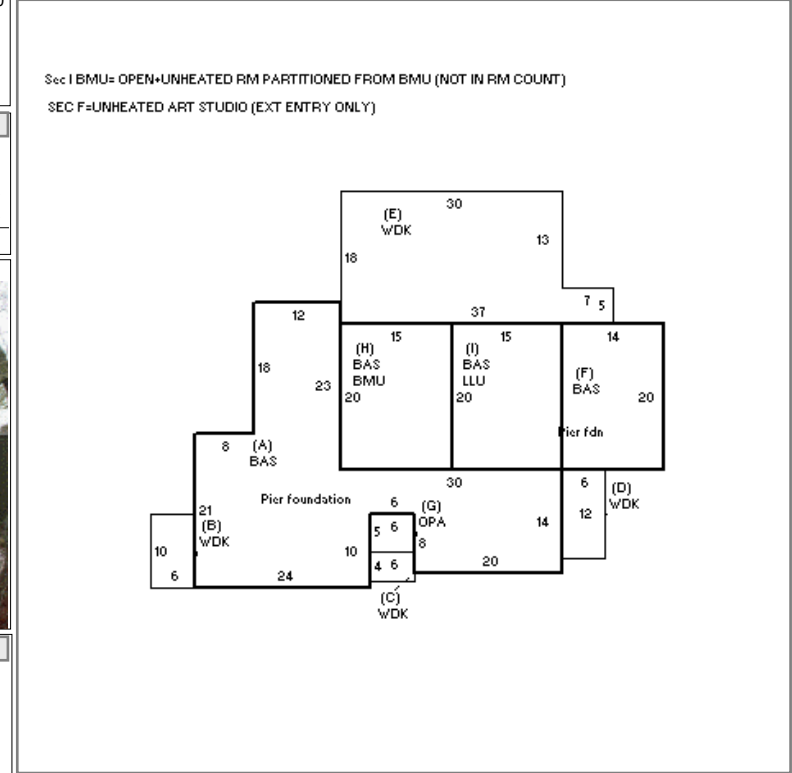

DETACHED

BUILDING

| YEAR BLT     | 1971  | SIZE ADJ   | 1.010 | ELEMENT         | CD | DESCRIPTION   | ADJ  |
|--------------|-------|------------|-------|-----------------|----|---------------|------|
| NET AREA     | 1,896 | DETAIL ADJ | 1.000 | FOUNDATION      | 4  | BSMT WALL     | 1.00 |
| \$NLA(RCN)   | \$382 | OVERALL    | 1.060 | EXT. COVER      | 8  | TEX PLYWOOD   | 1.00 |
| CAPACITY     |       |            |       | ROOF SHAPE      | 1  | GABLE         | 1.00 |
| STORIES(FAR) | 1     | ADJ        | 1.00  | ROOF COVER      | 2  | WOOD SHINGLES | 1.01 |
| ROOMS        | 4     |            | 1.00  | FLOOR COVER     | 1  | HARDWOOD      | 1.00 |
| BEDROOMS     | 2     |            | 1.00  | INT. FINISH     | 2  | DRYWALL       | 1.00 |
| BATHROOMS    | 2     |            | 1.00  | HEATING/COOLING | 5  | ELECTRIC      | 0.95 |
| FIXTURES     | 6     | \$4,200    |       | FUEL SOURCE     | 3  | ELECTRIC      | 1.00 |
| UNITS        | 0     |            | 1.00  |                 |    |               |      |

| TOTAL RCN      | 723.330   |         |
|----------------|-----------|---------|
| CONDITION ELEM | CD        |         |
| EFF.YR/AGE     | 1985 / 37 |         |
| COND           | 31        | 31 %    |
| FUNC           | 0         |         |
| ECON           | 0         |         |
| DEPR           | 31        | % GD 69 |
| RCNLD          | \$499,100 |         |