

Key: 2871

Town of TRURO - Fiscal Year 2024

9/27/2023 7:11 pm SEQ #: 2.968

LEGAL LAND

Table with columns: CURRENT OWNER, PARCEL ID, LOCATION, TRANSFER HISTORY, DOS, T, SALE PRICE, BK-PG (Cert). Includes owner OTOCKA ROSEMARY and parcel 50-88-0.

Table with columns: CLASS, CLASS%, DESCRIPTION, BN ID, BN, CARD. Includes details for class 1010 and single family.

Table with columns: CD, T, AC/SF/UN, Nbh, Inf1, Inf2, ADJ BASE, SAF, Inf3, Lpi, VC, CREDIT AMT, ADJ VALUE. Includes values for 100 and 300.

Table with columns: TOTAL, 41,818 SF, ZONING, RES, FRNT, 0, ASSESSED, CURRENT, PREVIOUS. Includes assessed values for land, building, detached, and other.

Table with columns: TY, QUAL, COND, DIM/NOTE, YB, UNITS, ADJ PRICE, RCNLD. Includes details for DGF, ST1, WDK, SHF.

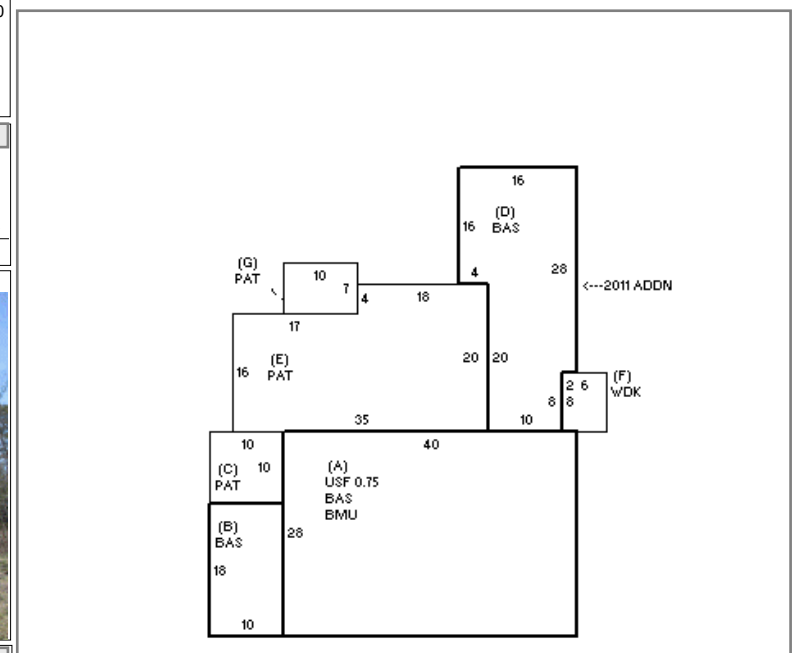

Table with columns: BUILDING, CD, ADJ, DESC, MEASURE, 3/22/2021, LG. Includes details for building model, style, quality, and frame.

BLDG COMMENTS: 3/22/2021 Owner confirmed interior data via phone (C-19).

DETACHED

BU I L D I N G

Large table with columns: YEAR BLT, NET AREA, \$NLA(RCN), CAPACITY, UNITS, ADJ, ELEMENT, CD, DESCRIPTION, ADJ, S, BAT, T, DESCRIPTION, UNITS, YB, ADJ PRICE, RCN, TOTAL RCN, CONDITION ELEM, CD, EFF. YR/AGE, COND, FUNC, ECON, DEPR, RCNLD. Includes detailed building specifications and financial data.