

Key: 5907

Town of TRURO - Fiscal Year 2024

9/27/2023 7:11 pm SEQ #: 4.012

LEGAL

LAND

Table with columns: CURRENT OWNER, PARCEL ID, LOCATION, TRANSFER HISTORY, DOS, T, SALE PRICE, BK-PG (Cert). Includes owner SLATER LINDA M TRUST and parcel 40-157-0.

Table with columns: CLASS, CLASS%, DESCRIPTION, BN ID, BN, CARD. Includes entries for 1010, 100, SINGLE FAMILY, 17-339X, etc.

Table with columns: CD, T, AC/SF/UN, Nbhd, Inf1, Inf2, ADJ BASE, SAF, Inf3, Lpi, VC, CREDIT AMT, ADJ VALUE. Includes totals for assessed, current, and previous values.

Table with columns: ZONING, RES, FRNT, ASSESSED, CURRENT, PREVIOUS. Includes details for EAST TRURO and various assessed values.

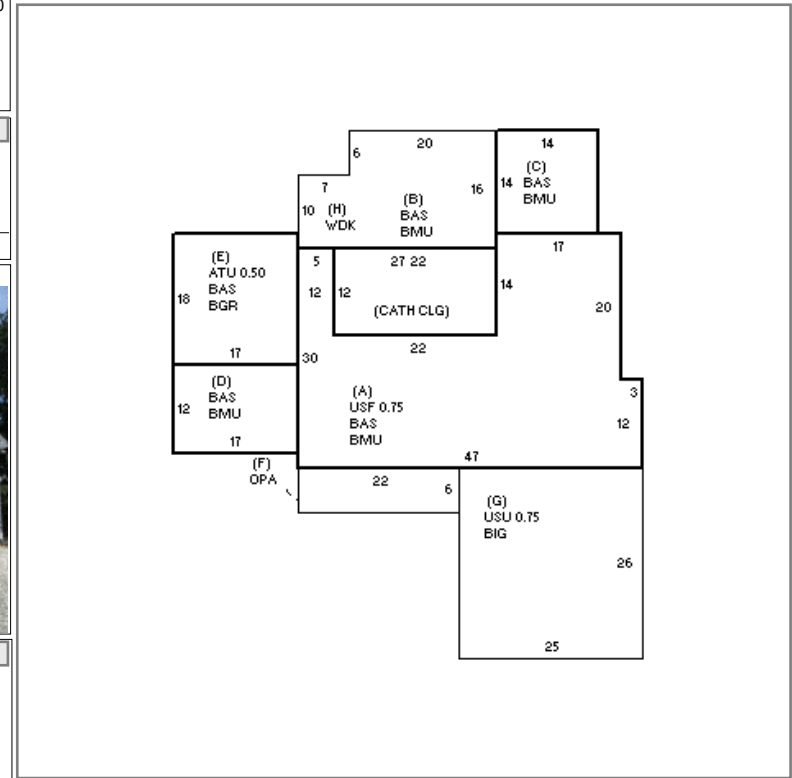

DETACHED

Table with columns: BLDG COMMENTS, MEASURE, LIST, REVIEW. Includes HVAC=HYDRO AIR and other building details.

BUILDING

Large table with columns: YEAR BLT, SIZE ADJ, ELEMENT, CD, DESCRIPTION, ADJ, S, BAT, T, DESCRIPTION, UNITS, YB, ADJ PRICE, RCN, TOTAL RCN, CONDITION ELEM, CD. Includes building details and capacity information.